

# **STACKING ROLLING BEDMAKER PARTS MANUALS**

**Model Nos. 1736, 1738, 1740, 1742**

# Table of Contents

Click the Stacking Rolling Bedmaker model number below for a Parts Manual for each model.

## **1736 - 12 Row 36" Stacking Rolling Bedmaker**

- Pages 3 - 10

## **1738 - 12 Row 38" Stacking Rolling Bedmaker**

- Pages 11 - 18

## **1740 - 12 Row 40" Stacking Rolling Bedmaker**

- Pages 19 - 26

## **1742 - 16 Row 30" Stacking Rolling Bedmaker**

- Pages 27 - 34



**12 ROW @ 36”  
STACKING  
ROLLING BEDMAKER**

**Model No. 1736**

# CENTER SECTION

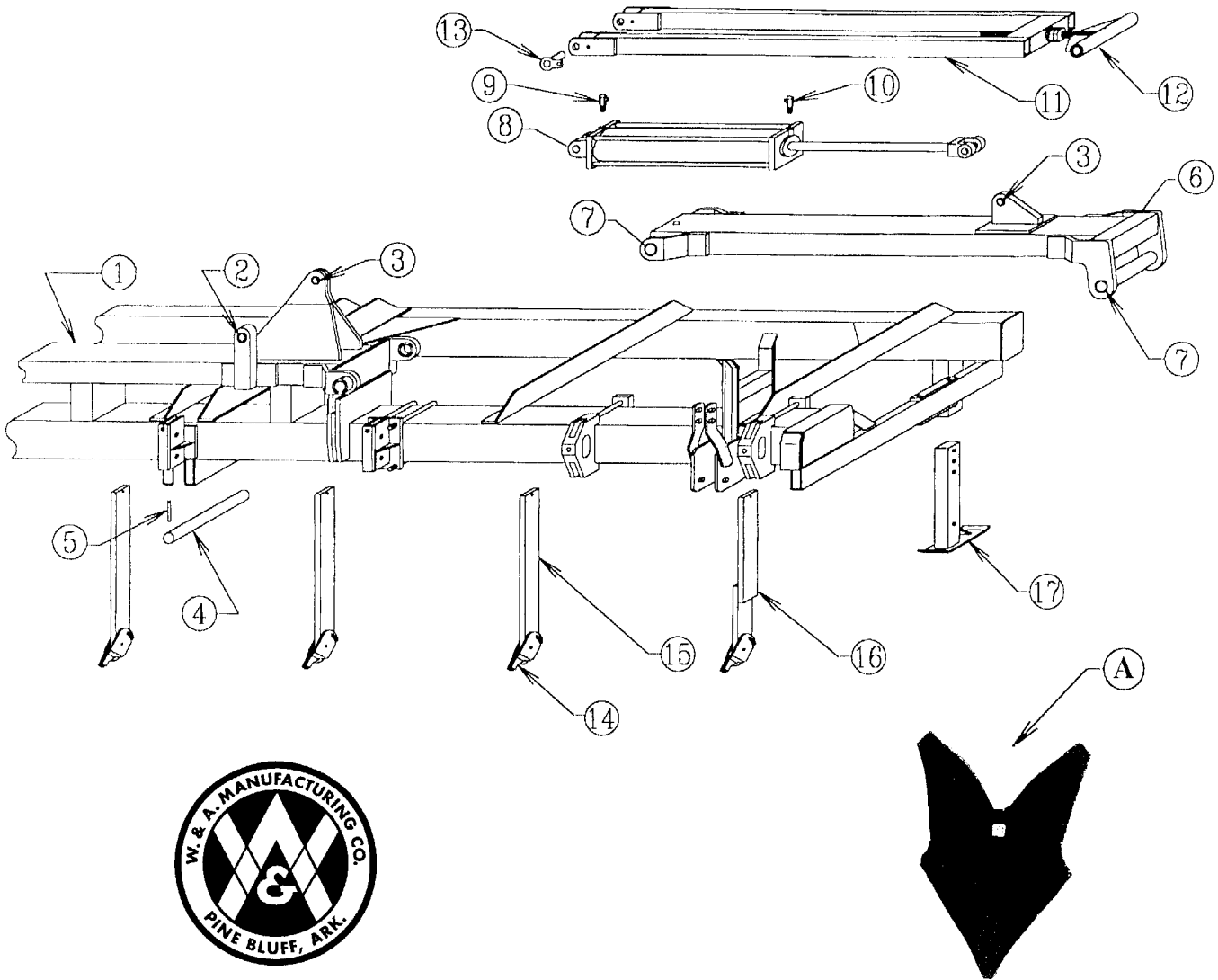

Item No.	Part No.	Wt. Lbs.	Description	Qty. Req'd
1	302076	2060	Center Section* .....	1
2	401084	¼	Form 1 Bushing -- 1-1/2" OD x 1-1/4" ID x 1-1/2" Long .....	4
3	401080	¼	Form 1 Bushing -- 1-1/2" OD x 1-1/4" ID x 1" Long .....	4
4	203948	14¼	2" Pivot Pin .....	4
-	413124	-	Machine Washer -- 3" OD x 2" ID x 10 Ga .....	8
5	416133	-	Roll Pin -- 1/2" x 3-1/2" - Zinc .....	4
6	301802	265	Power Arm -- Top Leveling Stacker .....	2

# CENTER SECTION

Item No.	Part No.	Wt. Lbs.	Description	Qty. Req'd
7	401118	½	Bushing -- 2.376" OD x 2.006" ID x 2" Long .....	8
-	450004	-	1/4" Drive-in Grease Fitting .....	4
8	476029	126	Hydraulic Cylinder -- 5" x 30".....(w Pins) .....	2
-	477056	-	Seal Kit -- 5" x 24" & 5" x 30" Lion Cyl (2" Rod) .....	-
9	446188	¼	1/2" x 1/2" Swivel Orifice Elbow .....	2
10	444024	¼	Swivel, ½" x ½"* .....	2
-	785103	½	3/8" Hydraulic Hose x 103"* .....	2
-	785120	½	3/8" Hydraulic Hose x 120"* .....	4
11	301820	88	Leveling Arm (For 1½" Dia. Rod)* .....	2
12	301819	19¾	Leveling Arm End – 1½" Dia.Rod .....	2
-	410032	1	Lock Nut -- 1-1/2" NF Nylon Insert - Zinc .....	2
-	412024	¾	Hex Nut -- 1-1/2" - 6 - Gr 2 - Zinc .....	2
-	413120	-	Machine Washer -- 1-1/2" ID x 10 Ga .....	2
-	450004	-	1/4" Drive-in Grease Fitting .....	2
-	401095	-	Form 1 Bushing -- 1-7/8" OD x 1-1/2" ID x 1"Long .....	4
13	301824	1¾	Small Pin -- 1-1/4" x 2-1/2" Stacker Bar .....	4
-	411545	-	Hex Bolt -- 1/2" x 1-1/2" NC - Gr 5 - Zinc .....	4
-	413008	-	Flat Washer -- 1/2" - Zinc .....	4
14	479075	6½	Friction Trip Foot (Bed Maker) .....	7
-	411549	-	Hex Bolt -- 1/2" x 2-1/2" NC - Gr 5 - Zinc .....	7
-	411563	½	Hex Bolt -- 5/8" x 3" NC - Gr 5 - Zinc .....	7
-	411794	½	Carriage Bolt -- 3/4" x 3-1/2" NC - Gr 5 - Zinc .....	7
-	410009	-	Lock Nut -- 5/8" NC - Zinc .....	7
-	410012	-	Lock Nut -- 3/4" NC - Zinc .....	7
-	412008	-	Hex Nut -- 1/2" - 13 - Gr 2 - Zinc .....	7
-	413010	-	Flat Washer -- 5/8" - Zinc .....	14
-	413058	-	Heavy Flat Washer -- 3/4" .....	14
-	413508	-	Lock Washer -- 1/2" - Zinc .....	7
15	204210	25	Vertical Shank C1080 (Bed Maker) .....	7
-	416120	-	Roll Pin, 3/8" x 2"* .....	7
16	302034	27¾	1" Offset Shank – RH (Shown)* .....	1
-	302035	27¾	1" Offset Shank – LH* .....	1
17	302004	14½	Parking Stand* .....	2
-	416230	¾	3/4" Safety Lock Pin x 5-1/2" OAL - Zinc .....	2
A	474031	7¼	#11N Furrower.....(11" Top Width) .....	7
N/I	474032	12¼	#12 Furrower.....(15" Top Width)* .....	-

# WING

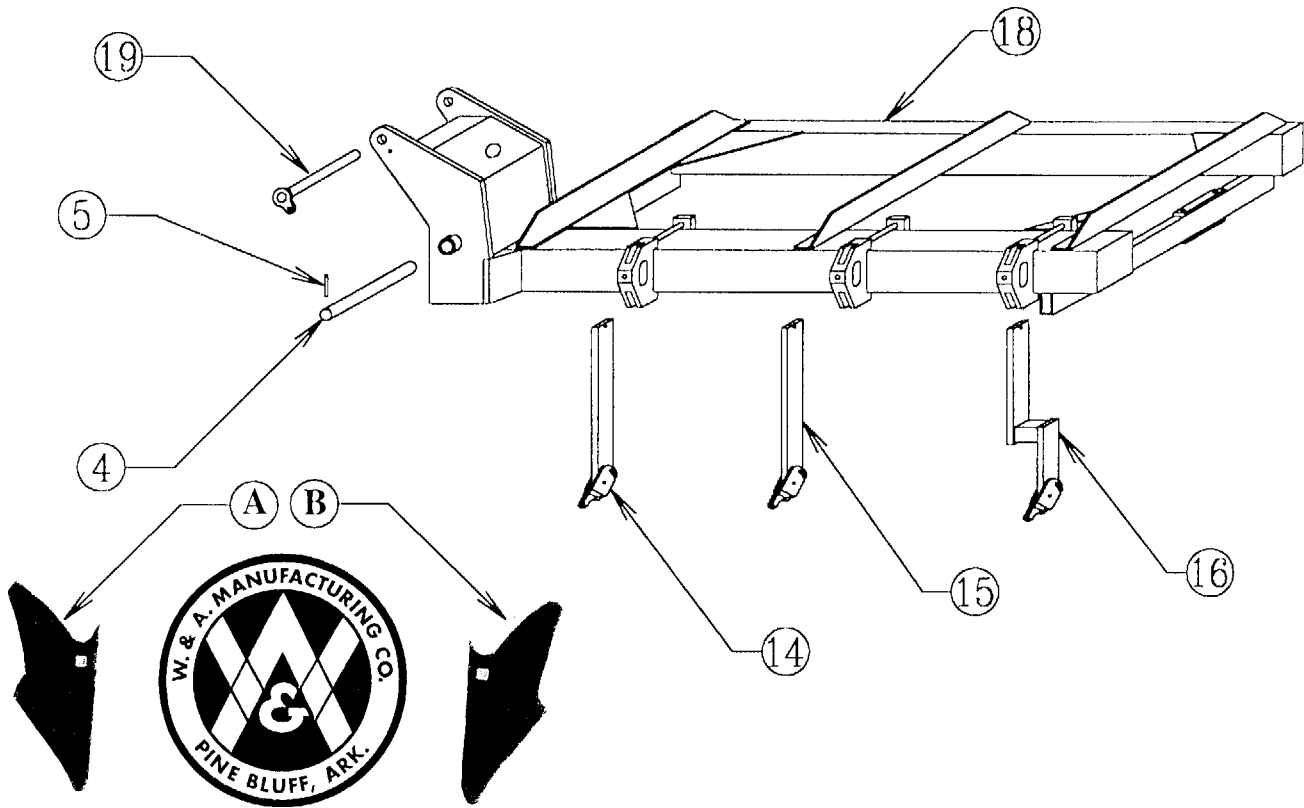

<u>Item No.</u>	<u>Part No.</u>	<u>Wt. Lbs.</u>	<u>Description</u>	<u>Qty. Req'd</u>
4	203948	14¼	2" Pivot Pin .....	4
-	413124	-	Machine Washer -- 3" OD x 2" ID x 10 Ga .....	8
5	416133	-	Roll Pin -- 1/2" x 3-1/2" - Zinc.....	4
14	479075	6½	Friction Trip Foot (Bed Maker) .....	3
-	411549	-	Hex Bolt -- 1/2" x 2-1/2" NC - Gr 5 - Zinc .....	3
-	411563	½	Hex Bolt -- 5/8" x 3" NC - Gr 5 - Zinc .....	3
-	410008	-	Lock Nut -- 1/2" NC - Zinc .....	6
15	204210	25	Vertical Shank C1080 (Bed Maker) .....	3
-	416120	-	Roll Pin, 3/8" x 2"* .....	3
16	302001	35¼	5" Offset Shank – LH (Bed Maker)....(Shown) .....	1
-	302000	35¼	5" Offset Shank – RH (Bed Maker) .....	1
18	302078	844	Wing – LH (Shown)* .....	1
-	302077	844	Wing – RH* .....	1
19	301825	8	Top Pin -- Top Leveling Stacker .....	2
-	411545	-	Hex Bolt -- 1/2" x 1-1/2" NC - Gr 5 - Zinc .....	2
-	413008	-	Flat Washer -- 1/2" - Zinc.....	2
A	204215		#11N End Furrower -- RH .....	1
B	204216		#11N End Furrower -- LH .....	1

# ROLLER

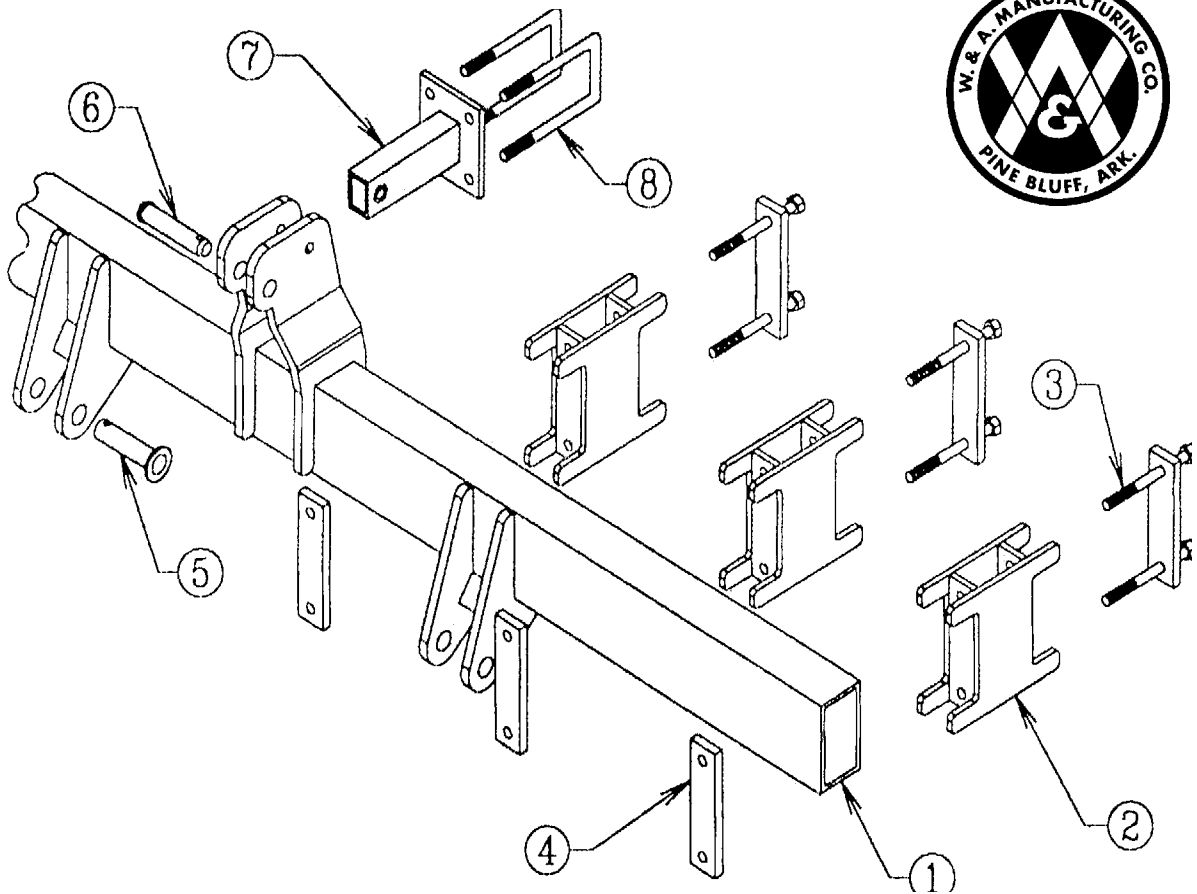

Item No.	Part No.	Wt. Lbs.	Description	Qty. Req'd
1	301986	1004	107" Roller – Center*	2
-	302075	891	95" Roller – Wing*	2
2	482101	4	1-15/16" Pillow Block & Bearing - Pulv.	8
-	481215	1	1-15/16" Bearing w/Lock Collar Peer - #G1115-KRRB-S1115K	-
3	411573	3/4	Hex Bolt -- 5/8" x 7" NC - Gr 5 - Zinc	16
-	413010	-	Flat Washer -- 5/8" - Zinc	16
-	410009	-	Lock Nut -- 5/8" NC - Zinc	16
4	204208	29 1/2	Scraper – 107" (Bed Maker)	2
-	204362	26 1/2	Scraper Wing – 95"*	2
-	411731	-	Carriage Bolt -- 1/2" x 1-1/2" NC - Gr 2 - Zinc	16
-	413508	-	Lock Washer -- 1/2" - Zinc	16
-	412008	-	Hex Nut -- 1/2" - 13 - Gr 2 - Zinc	16

# BOLT-ON SHANK HOLDERS

## 12 ROW STACKING BED MAKER

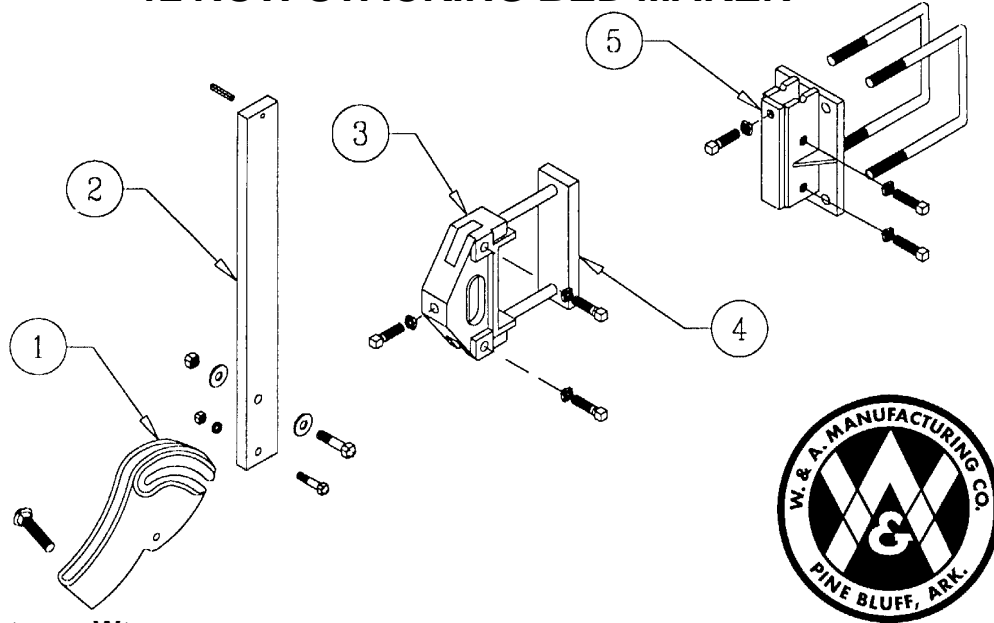

<u>Item No.</u>	<u>Part No.</u>	<u>Wt. Lbs.</u>	<u>Description</u>	<u>Qty. Req'd</u>
1	479075	6½	Friction Trip Foot (Bed Maker) .....	13
-	411549	-	Hex Bolt -- 1/2" x 2-1/2" NC - Gr 5 - Zinc .....	13
-	411563	½	Hex Bolt -- 5/8" x 3" NC - Gr 5 - Zinc .....	13
-	411794	½	Carriage Bolt -- 3/4" x 3-1/2" NC - Gr 5 - Zinc .....	13
-	410009	-	Lock Nut -- 5/8" NC - Zinc .....	13
-	410012	-	Lock Nut -- 3/4" NC - Zinc .....	13
-	412008	-	Hex Nut -- 1/2" - 13 - Gr 2 - Zinc .....	13
-	413010	-	Flat Washer -- 5/8" - Zinc .....	26
-	413012	-	Flat Washer -- 3/4" - Zinc .....	26
-	413508	-	Lock Washer -- 1/2" - Zinc .....	13
2	204210	25	Vertical Shank C1080 (Bed Maker) .....	9
-	416120	-	3/8" x 2" Roll Pin - Zinc .....	13
3	479069	13½	Bolt-On Shank Holder .....	10
-	414829	-	Square Head Set Screw -- 5/8" x 2" .....	30
-	412310	-	Square Nut -- 5/8" - 11 - Gr 2 - Zinc .....	30
-	412410	-	Jam Nut -- 5/8" - 11 - Gr 2 - Zinc .....	30
4	204274	9	Backing Plate .....	10
-	411601	1¼	Hex Bolt -- 3/4" x 8-1/2" - Gr 5 - Zinc .....	20
-	412012	-	Hex Nut -- 3/4" - 10 - Gr 2 - Zinc .....	20
-	413512	-	Lock Washer -- 3/4" - Zinc .....	20
5	302036	19½	Center Bolt-On Shank Holder .....	2
-	415004	2½	3/4" Sq. U-Bolt x 7" x 9" Leg .....	4
-	412012	-	Hex Nut -- 3/4" - 10 - Gr 2 - Zinc .....	8
-	413512	-	Lock Washer -- 3/4" - Zinc .....	8
-	414829	-	Square Head Set Screw -- 5/8" x 2" .....	9
-	412410	-	Jam Nut -- 5/8" - 11 - Gr 2 - Zinc .....	9
N/I	302000	35¼	5" Offset Shank – RH (Bed Maker) .....	2
N/I	302001	35¼	5" Offset Shank – LH (Bed Maker) .....	2

NOTE: On 12@ 36" Row Bed Maker -- ONE Shank Holder is welded on frame.



# HITCH ASSEMBLY

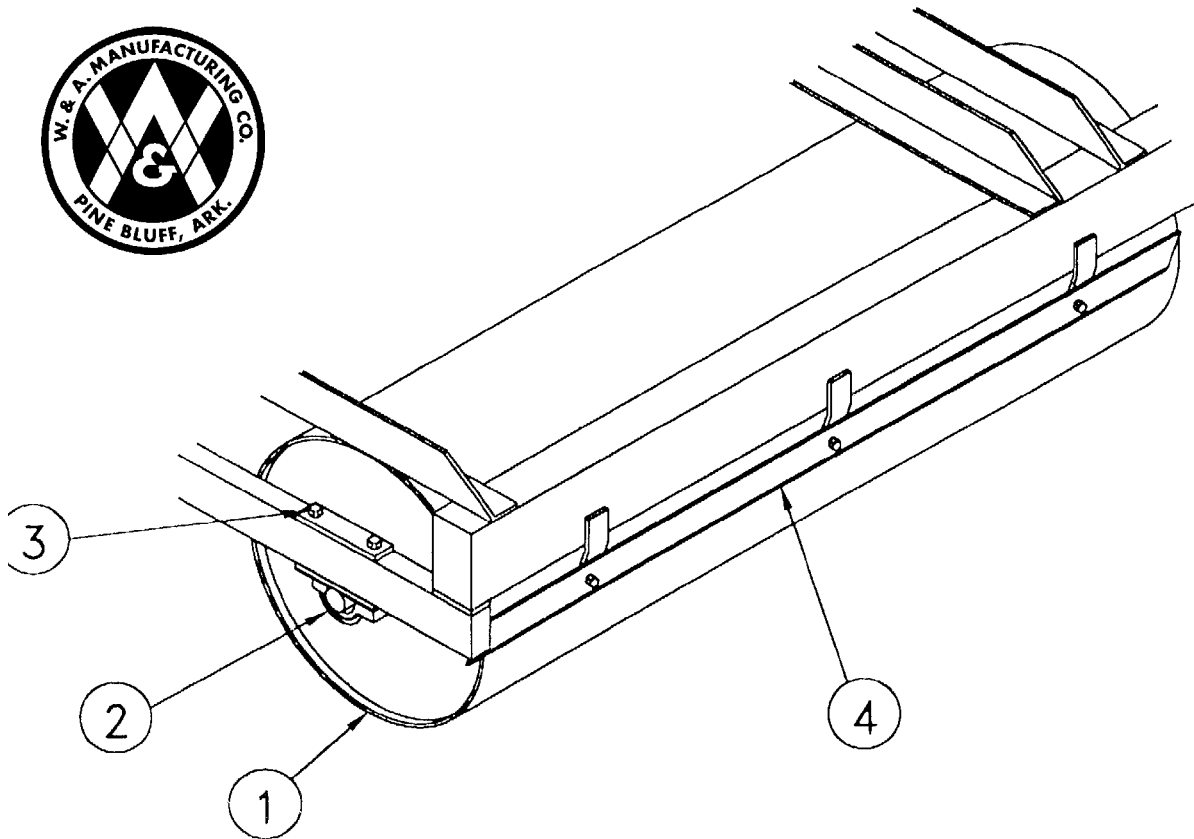

<u>Item No.</u>	<u>Part No.</u>	<u>Wt. Lbs.</u>	<u>Description</u>	<u>Qty. Req'd</u>
1	301833	361	Wide Hitch -- Top Leveling Stacker .....	1
2	302014	25	5" Spacer Block -- Top Leveling Stacker .....	6
3	411604	1¼	Hex Bolt -- ¾" x 10" NC - Gr 5 - Zinc .....	12
-	412012	-	Hex Nut -- ¾" - 10 - Gr 2 - Zinc .....	29
-	413512	-	Lock Washer -- ¾" - Zinc .....	29
4	203960	5	Backing Plate -- Top Leveling Stacker .....	12
-	411598	½	Hex Bolt -- ¾" x 6-1/2" NC - Gr 5 - Zinc .....	12
5	300837	3	Pull Pin -- 1-7/16" x 6" .....	2
-	416207	-	7/16" Klik Pin - Zinc .....	3
6	416698	2	1-1/4" Top Link Pin - Zinc .....	1
7	301836	11	Top Connector, 5" Spacer - Hitch Assy (SBM) .....	1
-	411594	¾	Hex Bolt -- ¾" x 5" NC - Gr 5 - Zinc .....	1
8	415006	2	¾" Sq. U-Bolt x 4" x 8½" Leg .....	2

# 7 x 7 BAR GAUGE WHEEL

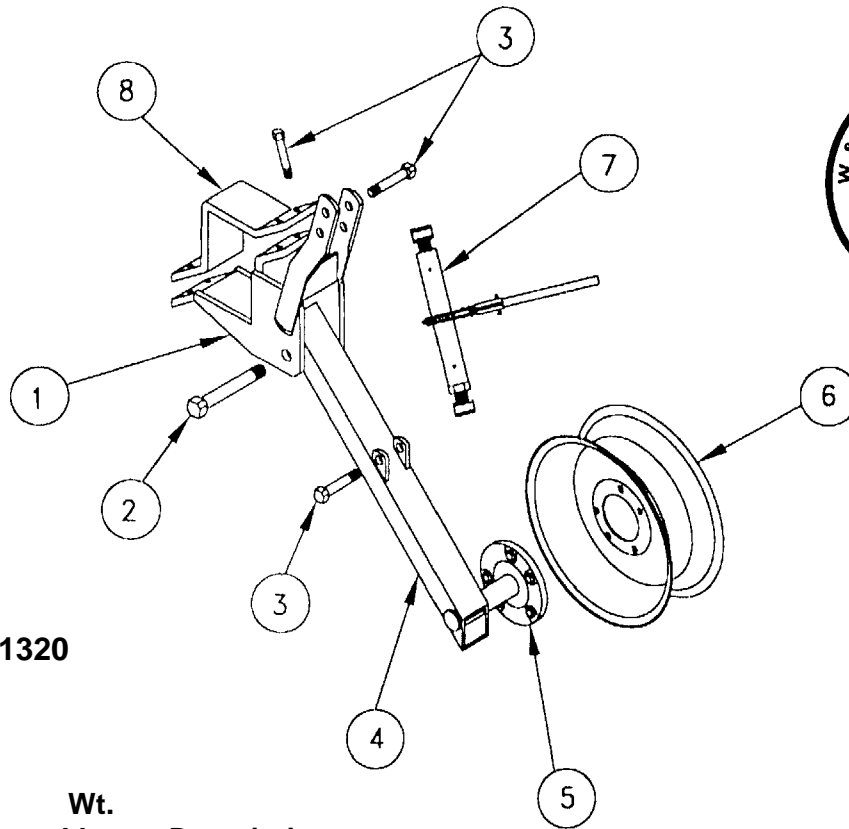

**No. 1320**

<b>Item No.</b>	<b>Part No.</b>	<b>Wt. Lbs.</b>	<b>Description</b>	<b>Qty. Req'd.</b>
1	302020	35¼	Holder .....	1
2	411316	1	Hex Bolt -- 1" x 6-1/2" NC - Gr 2 - Zinc .....	1
-	412016	-	Hex Nut -- 1" - 8 - Gr 2 - Zinc .....	1
-	413516	-	Lock Washer -- 1" - Zinc .....	1
3	411591	½	Hex Bolt -- 3/4" x 4" NC - Gr 5 - Zinc .....	6
-	412012	-	Hex Nut -- 3/4" - 10 - Gr 2 - Zinc .....	6
-	413512	-	Lock Washer -- 3/4" - Zinc .....	6
4	302022	42½	LH Leg w/Hub - #1320 Gauge Wheel (Shown) .....	1
-	302021	42½	RH Leg w/Hub - #1320 Gauge Wheel .....	1
5	491119	10	5 Hole Hub Complete - Q-719 .....	1
-	491007	9¾	Hub w/Cups Only - Q-719 .....	1
-	481205	¼	Cone - Q719 - LM67048 .....	1
-	496010	-	Outer Cup - Q719 - LM67010 .....	1
-	481204	¼	Cone - Q719 - LM48548 .....	1
-	496011	-	Inner Cup - Q719 - LM48510 .....	1
-	497010	-	Grease Seal - Q719 - CR 15190 .....	1
-	490006	¼	Hub Cap - Q719 .....	1
-	490015	-	1/2" NF Lug Nut .....	5
-	490017	-	Drive-In Hub Bolt - Q719 .....	5
-	412164	-	Slotted Nut -- 7/8" - 14 Spindle .....	1
-	490034	-	Spindle Washer -- 7/8" - Q719 .....	1
6	493007	17	15" x 5" x 5 Hole Wheel .....	1
7	302025	11½	Ratchet Crank Assembly .....	1
8	204242	13½	Backing Plate (Bed Maker Gauge Wheel) .....	1

# **STACKING ROLLING BEDMAKER**

**Model No. 1738 -- 12 @ 38" Row**

# CENTER SECTION

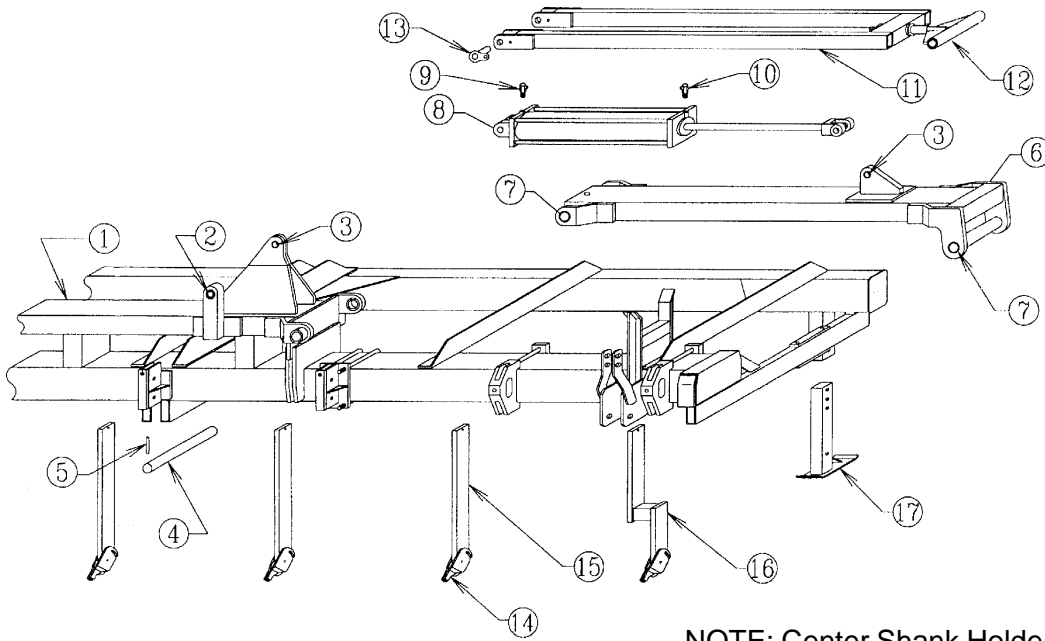

NOTE: Center Shank Holder weld-on,  
others use bolt-on shank holders

<u>Item No.</u>	<u>Part No.</u>	<u>Wt. Lbs.</u>	<u>Description</u>	<u>Qty. Req'd for One Machine</u>
1	301995	2060	Center Section -- 12 @ 38" Row .....	1
2	401084	¼	Form 1 Bushing -- 1½" OD x ¼" ID x 1½" Long .....	4
3	401080	¼	Form 1 Bushing -- 1½" OD x ¼" ID x 1" Long .....	4
4	203948	14¼	2" Pivot Pin x 16¼" .....	2
-	413124	-	Machine Washer -- 3" OD x 2" ID x 10 Ga .....	4
5	416133	-	Roll Pin -- 1/2" x 3½" .....	2
6	301802	265	Power Arm -- Top Leveling Stacker .....	2
7	401118	½	Bushing -- 2.376" OD x 2.006" ID x 2" Long .....	8
-	450004	-	1/4" Drive-in Grease Fitting .....	4
8	476029	126	Hydraulic Cylinder -- 5" x 30" (w/Pins) .....	2
-	477056	-	Seal Kit -- 5" x 24" & 5" x 30" Lion Cyl. - 2" Rod .....	-
9	446188	¼	1/2" x 1/2" Swivel Orifice Elbow .....	2
10	446188	¼	1/2" x 1/2" Swivel Orifice Elbow .....	2
-	785103	½	3/8" Hydraulic Hose x 103" .....	2
-	785120	½	3/8" Hydraulic Hose x 120" .....	2

# CENTER SECTION (Continued)

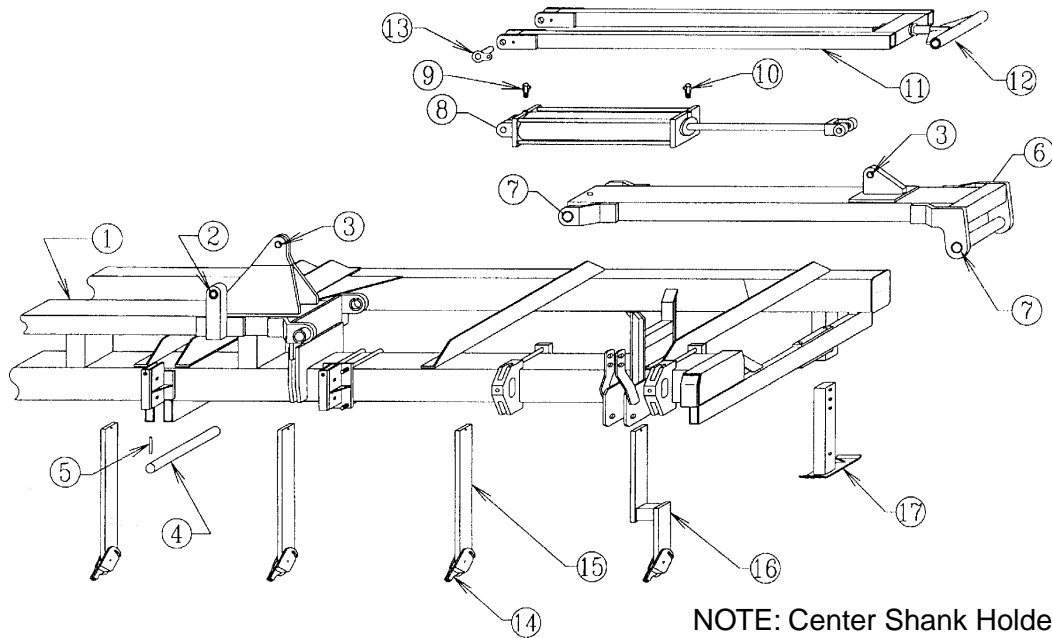

NOTE: Center Shank Holder weld-on,  
others use bolt-on shank holders

<u>Item No.</u>	<u>Part No.</u>	<u>Wt. Lbs.</u>	<u>Description</u>	<u>Qty. Req'd for One Machine</u>
11	301820	88	Leveling Arm -- For 1½" Dia. Rod .....	2
12	301819	19¾	Leveling Arm End with Lock Nut – 1½" Dia. ....	2
-	410032	¾	Lock Nut -- 1½" NF Top Lock - Zinc .....	2
-	413024	¼	Flat Washer -- 1½" - Zinc .....	2
-	413120	-	Machine Washer -- 2¼" OD x 1½" ID x 10 Ga .....	2
-	450004	-	1/4" Drive-in Grease Fitting .....	2
-	401095	-	Form 1 Bushing -- 1-7/8" OD x 1½" ID x 1" Long .....	4
13	301824	1¾	Small Pin -- 1¼" x 2½" Stacker Bar .....	4
-	411545	-	Hex Bolt -- 1/2" x 1½" NC - Gr 5 - Zinc .....	4
-	413008	-	Flat Washer -- 1/2" - Zinc .....	4
-	413508	-	Lock Washer -- 1/2" - Zinc .....	4
14	479075	6½	Friction Trip Foot (See Page 6)	
15	204210	25	Vertical Shank C1080 (See Page 6)	
16	302001	29	5" Offset Shank – LH (See Page 6)	
17	302004	14½	Parking Stand .....	2
-	416230	¾	3/4" Safety Lock Pin x 5½" OAL - Zinc .....	2

# WING

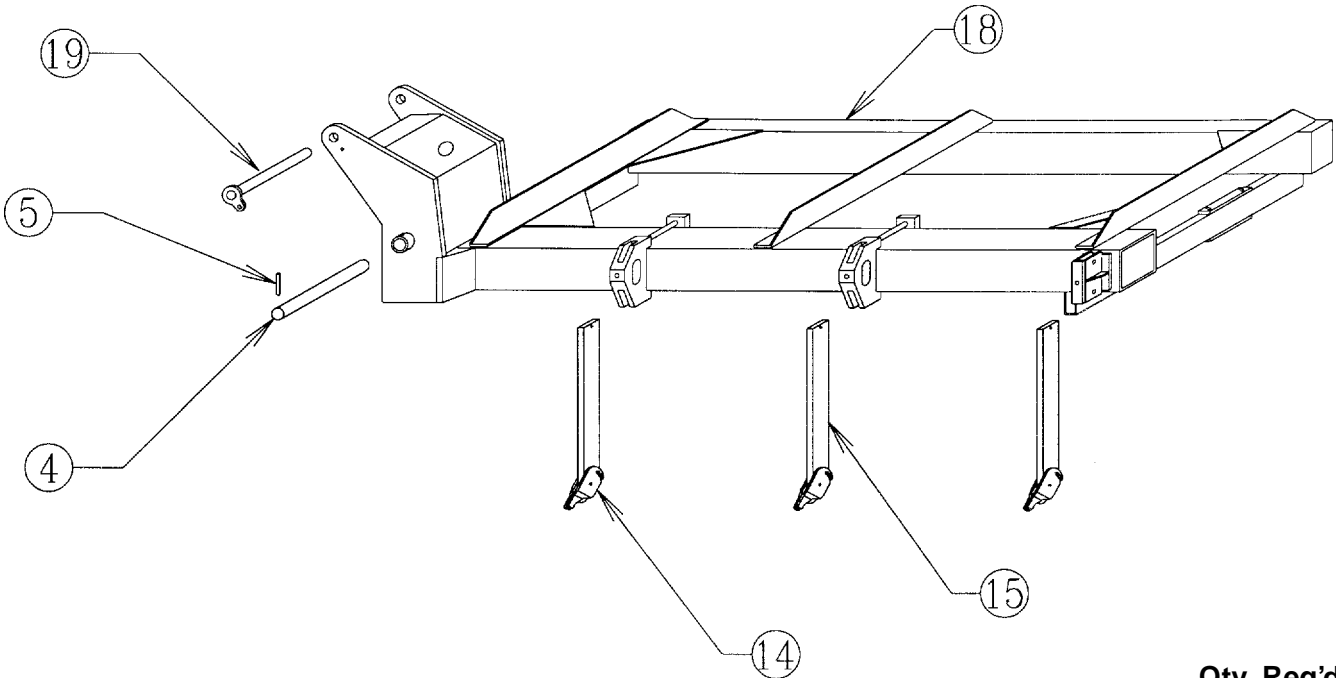

Item No.	Part No.	Wt. Lbs.	Description	Qty. Req'd for One Machine
4	203948	14¼	2" Pivot Pin x 16¼" .....	2
-	413124	-	Machine Washer -- 3" OD x 2" ID x 10 Ga .....	4
5	416133	-	Roll Pin -- 1/2" x 3½" - Zinc .....	2
14	479075	6½	Friction Trip Foot (See Page 6)	
15	204210	25	Vertical Shank C1080 (See Page 6)	
18	301997	924	Wing – LH - 12 @ 38" Row (Shown) .....	1
-	301996	924	Wing – RH - 12 @ 38" Row .....	1
19	301825	8	Top Pin -- Top Leveling Stacker .....	2
-	411545	-	Hex Bolt -- 1/2" x 1½" NC - Gr 5 - Zinc .....	2
-	413008	-	Flat Washer -- 1/2" - Zinc .....	2
-	413508	-	Lock Washer -- 1/2" - Zinc .....	2

**USE ONLY**



**W & A REPLACEMENT PARTS**

# ROLLER

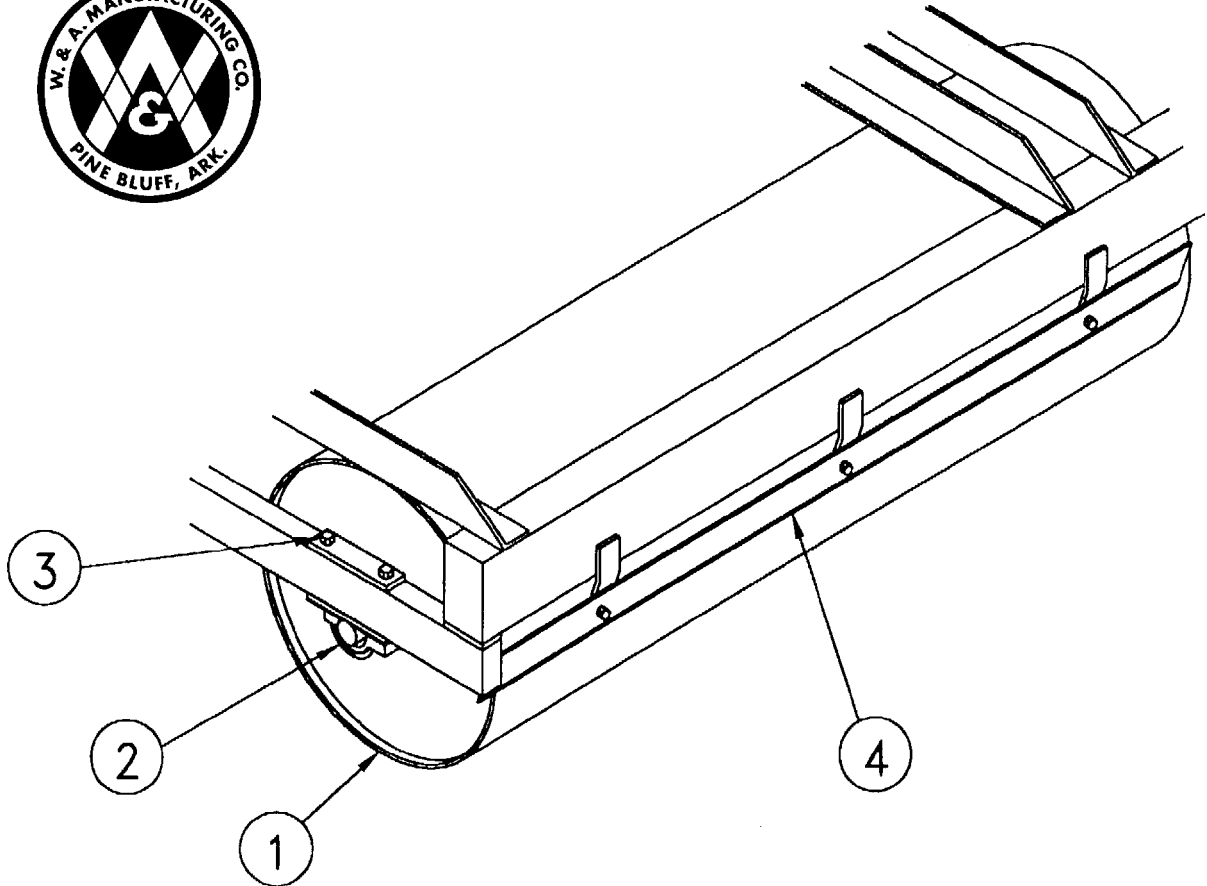

<u>Item No.</u>	<u>Part No.</u>	<u>Wt. Lbs.</u>	<u>Description</u>	<u>Qty. Req'd for One Machine</u>
1	301986	1004	107" Roller -- 12 @ 38" Row .....	4
2	482101	4	1-15/16" Pillow Block & Bearing Complete .....	8
-	481215	1	1-15/16" Bearing w/Lock Collar.....#G115-KRRB-S1115K .....	-
-	480006	3	Pillow Block for 1-15/16" Bearing .....	-
3	411573	¾	Hex Bolt -- 5/8" x 7" NC - Gr 5 - Zinc .....	16
-	413010	-	Flat Washer -- 5/8" - Zinc .....	16
-	410009	-	Lock Nut -- 5/8" NC - Gr 2 - Zinc .....	16
4	204208	29½	Scraper 107" -- 12 @ 38" Row .....	4
-	411785	-	Carriage Bolt -- 1/2" x 1½" NC - Gr 5 - Zinc .....	16
-	413508	-	Lock Washer -- 1/2" - Zinc .....	16
-	412008	-	Hex Nut -- 1/2" - 13 - Gr 2 - Zinc .....	16

# BOLT-ON SHANK HOLDERS

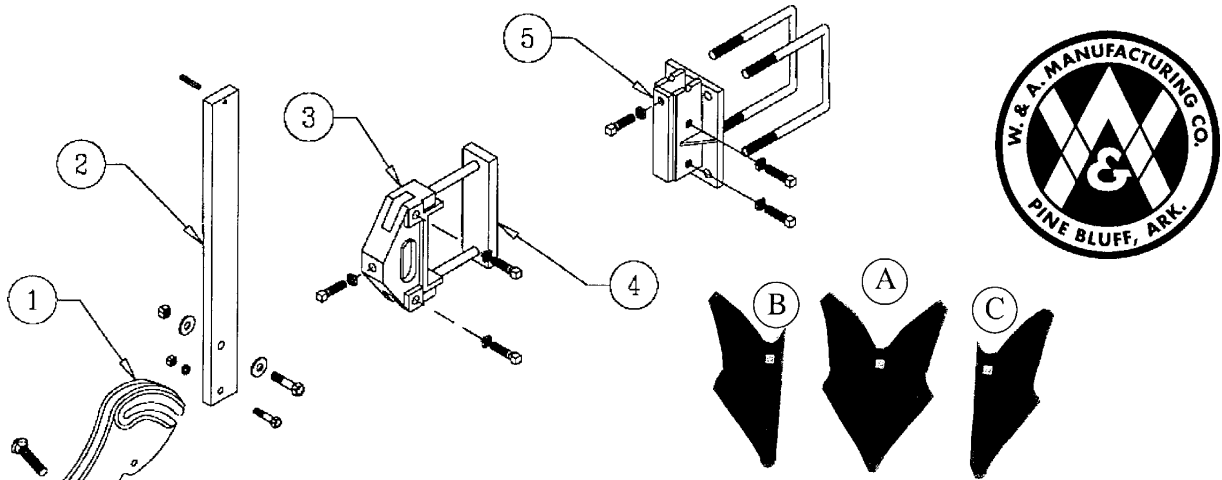

<u>Item No.</u>	<u>Part No.</u>	<u>Wt. Lbs.</u>	<u>Description</u>	<u>Qty. Req'd for One Machine</u>
1	479075	6½	Friction Trip Foot.....	13
-	411549	-	Hex Bolt -- 1/2" x 2½" NC - Gr 5 - Zinc .....	13
-	411563	½	Hex Bolt -- 5/8" x 3" NC - Gr 5 - Zinc .....	13
-	411794	½	Carriage Bolt -- 3/4" x 3½" NC - Gr 5 - Zinc.....	13
-	410009	-	Lock Nut -- 5/8" NC - Gr 2 - Zinc .....	13
-	410012	-	Lock Nut -- 3/4" NC - Gr 2 - Zinc .....	13
-	412008	-	Hex Nut -- 1/2" - 13 - Gr 2 - Zinc.....	13
-	413056	-	Flat Washer, Heavy -- 5/8" - Zinc .....	26
-	413058	-	Flat Washer, Heavy -- 3/4" - Zinc .....	13
-	413508	-	Lock Washer -- 1/2" - Zinc .....	13
2	204210	25	Vertical Shank C1080.....	11
-	416120	-	Roll Pin -- 3/8" x 2" - Zinc .....	13
3	479069	13½	Bolt-On Shank Holder - 7" Tool Bar .....	8
-	414828	-	Square Head Set Screw -- 5/8" x 1¾" .....	24
-	412310	-	Square Nut -- 5/8" - 11 - Gr 2 - Zinc .....	24
-	412410	-	Jam Nut -- 5/8" - 11 - Gr 2 - Zinc .....	24
4	204274	9	Backing Plate for Bolt-on Shank Holder - 7" .....	8
-	411601	1¼	Hex Bolt -- 3/4" x 8½" Gr. 5 .....	16
-	412012	-	Hex Nut -- 3/4" - 10 - Gr 2 - Zinc.....	24
-	413512	-	Lock Washer -- 3/4" - Zinc .....	24
5	302036	19½	Center Bolt-On Shank Holder .....	2
-	414828	-	Square Head Set Screw -- 5/8" x 1¾" .....	12
-	412410	-	Jam Nut -- 5/8" - 11 - Gr 2 - Zinc .....	12
-	415004	2½	3/4" Sq. U-Bolt x 7" x 9" Leg .....	4
16	302001	29	5" Offset Shank – LH (Shown).....	1
N/I	302000	29	5" Offset Shank – RH .....	1
A	474031	7¼	#11N Furrower.....(11" Top Width).....	11
N/I	474032	12¼	#12 Furrower.....(15" Top Width) .....	-
B	204215		#11N End Furrower -- RH .....	1
C	204216		#11N End Furrower -- LH .....	1

NOTE: On 12@ 38" Row Bed Maker -- THREE Shank Holders are welded on frame.



# HITCH ASSEMBLY

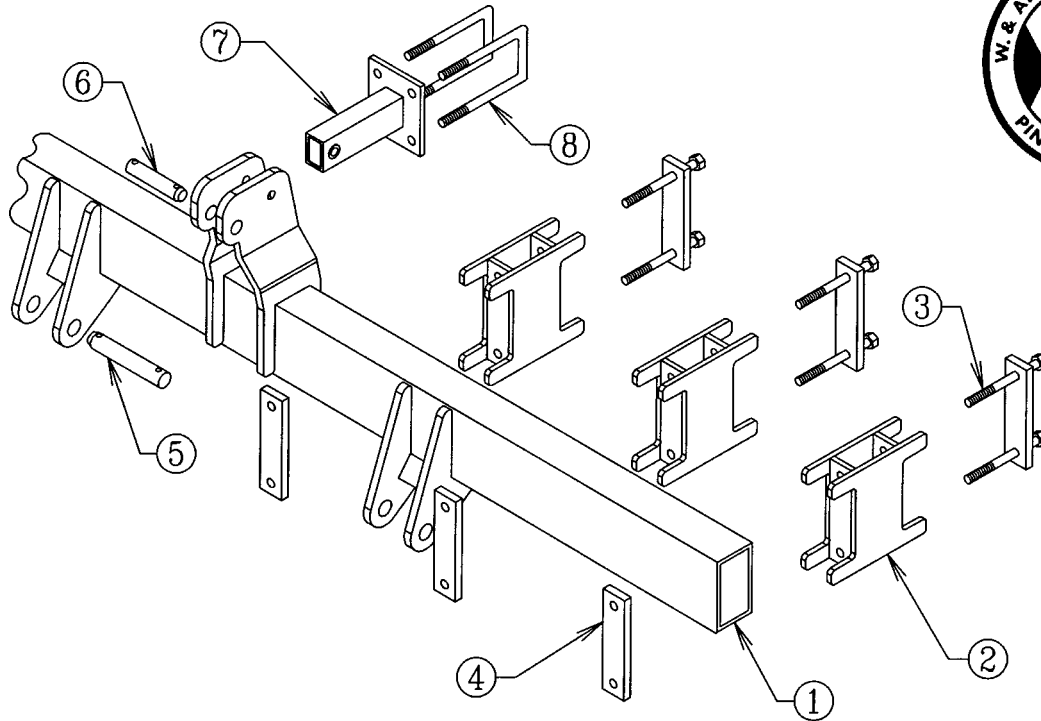

Item No.	Part No.	Wt. Lbs.	Description	Qty. Req'd for One Hitch
1	301833	361	Wide Hitch -- Top Leveling Stacker .....	1
2	302014	25	5" Spacer Block -- Top Leveling Stacker .....	6
3	203960	5	Backing Plate -- Top Leveling Stacker .....	6
-	411604	1¼	Hex Bolt -- 3/4" x 10" - Gr 5 - Zinc .....	12
-	412012	-	Hex Nut -- 3/4" - 10 - Gr 2 - Zinc .....	12
-	413512	-	Lock Washer -- 3/4" - Zinc .....	12
4	203960	5	Backing Plate -- Top Leveling Stacker .....	6
-	411598	½	Hex Bolt -- 3/4" x 6½" NC - Gr 5 - Zinc .....	12
-	412012	-	Hex Nut -- 3/4" - 10 - Gr 2 - Zinc .....	12
-	413512	-	Lock Washer -- 3/4" - Zinc .....	12
5	200876	3¾	Hardened Pull Pin -- 1-7/16" x 8-3/8" - Zinc .....	2
-	416207	-	Klik Pin -- 7/16" - Zinc .....	2
-	416133	-	Roll Pin -- 1/2" x 3½" - Zinc .....	2
6	200853	2	Hardened Top Link Pin -- 1¼" - Zinc .....	1
-	416207	-	Klik Pin -- 7/16" - Zinc .....	1
-	416120	-	Roll Pin -- 3/8" x 2" - Zinc .....	1
7	301836	11	Top Connector -- 5" Spacer - Hitch Assm .....	1
-	411594	¾	Hex Bolt -- 3/4" x 5" NC - Gr 5 - Zinc .....	1
-	412012	-	Hex Nut -- 3/4" - 10 - Gr 2 - Zinc .....	1
-	413512	-	Lock Washer -- 3/4" - Zinc .....	1
8	415006	2	3/4" Sq. U-Bolt x 4" x 8½" Leg - Gr 5 - Zinc .....	2
-	412012	-	Hex Nut -- 3/4" - 10 - Gr 2 - Zinc .....	4
-	413512	-	Lock Washer -- 3/4" - Zinc .....	4

# 7 x 7 BAR GAUGE WHEEL

## FOR ROLLING BED MAKER AND HIGH CLEAR CULTIVATOR

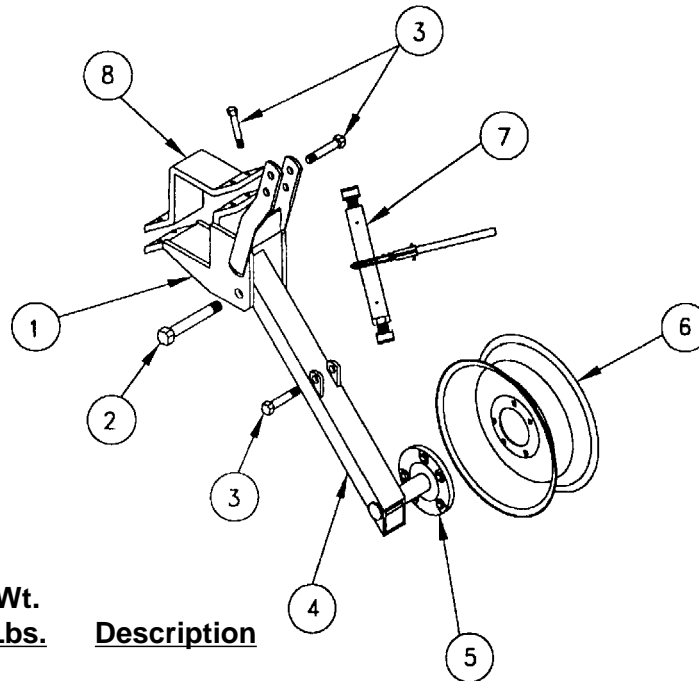

**No. 1320  
& No. 1321\***

\*Used on Bed  
Maker center  
section with  
weld-on holder.

<u>Item No.</u>	<u>Part No.</u>	<u>Wt. Lbs.</u>	<u>Description</u>	<u>Qty. Req'd for One Assembly</u>
1	302020	35¼	Holder - Gauge Wheel .....	1
2	411598	1	Hex Bolt -- 1" x 6½" NC - Gr 5 - Zinc .....	1
-	412016	-	Hex Nut -- 1" - 8 - Gr 2 - Zinc .....	1
-	413516	-	Lock Washer -- 1" - Zinc .....	1
3	411591	½	Hex Bolt -- ¾" x 4" NC - Gr 5 - Zinc .....	6
-	412012	-	Hex Nut -- ¾" - 10 - Gr 2 - Zinc .....	6
-	413512	-	Lock Washer -- ¾" - Zinc .....	6
4	302022	42½	LH Leg w/Hub - #1320 Gauge Wheel (Shown) .....	1
-	302021	42½	RH Leg w/Hub - #1320 Gauge Wheel .....	1
-	302024	50	Offset Leg LH w/Spind & Hub (1321 Ga Wh).....Not Illustrated .....	1
-	302023	50	Offset Leg RH w/Spind & Hub (1321 Ga Wh).....Not Illustrated .....	1
5	491119	10	5 Hole Hub Complete - Q-719 .....	1
-	491007	9¾	Hub w/Cups Only - Q-719 .....	1
-	481205	¼	Cone - Q809 & Q719 - LM67048 .....	1
-	496010	-	Outer Cup - Q809 & Q719 - LM67010 .....	1
-	481204	¼	Cone - Q809 & Q719 - LM48548 .....	1
-	496011	-	Inner Cup - Q809 & Q719 - LM48510 .....	1
-	497010	-	Grease Seal - Q719 - CR 15190 .....	1
-	490006	¼	Hub Cap - Q809 & Q719 .....	1
-	490015	-	1/2" NF Lug Nut .....	5
-	490017	-	Drive-In Hub Bolt - Q719 .....	5
-	412164	-	Slotted Nut -- 7/8" - 14 Spindle .....	1
-	490034	-	Spindle Washer -- 7/8" - Q875/Q809/Q719 .....	1
6	493007	17	15" x 5" x 5 Hole Wheel .....	1
7	302025	11½	Ratchet Crank Assembly .....	1
8	204242	13½	Backing Plate -- Bed Maker Gauge Wheel .....	1

**12 ROW @ 40”  
STACKING  
ROLLING BEDMAKER**

**Model No. 1740**

# CENTER SECTION

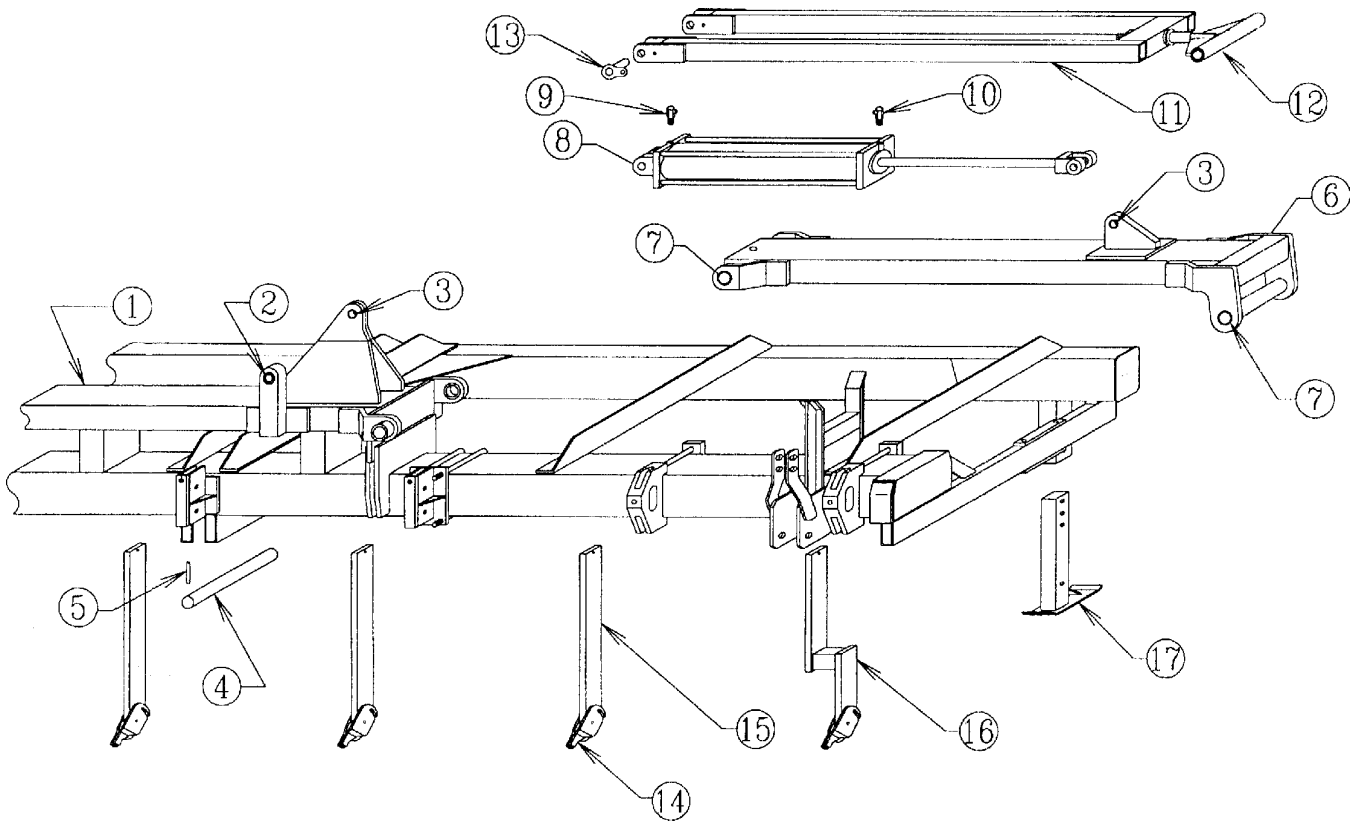

NOTE: Center Shank Holder weld-on,  
others use bolt-on shank holders

# CENTER SECTION

Item No.	Part No.	Wt. Lbs.	Description	Qty. Req'd for 1 Machine
1	302042	2136	Center Section .....	1
2	401084	¼	Form 1 Bushing -- 1-1/2" OD x 1-1/4" ID x 1-1/2" Long .....	4
3	401080	¼	Form 1 Bushing -- 1-1/2" OD x 1-1/4" ID x 1" Long .....	4
4	203948	14¼	2" Pivot Pin x 16-1/4" .....	2
-	413124	-	Machine Washer -- 3" OD x 2" ID x 10 Ga .....	4
5	416133	-	Roll Pin -- 1/2" x 3-1/2" .....	2
6	301802	265	Power Arm -- Top Leveling Stacker .....	2
7	401118	½	Bushing -- 2.376" OD x 2.006" ID x 2" Long .....	8
-	450004	-	1/4" Drive-in Grease Fitting .....	4
8	476029	126	Hydraulic Cylinder -- 5" x 30" (w/Pins) .....	2
-	477056	-	Seal Kit -- 5" x 24" & 5" x 30" Lion Cyl. 2" Rod (for above Cyl) .	-
9	446188	¼	1/2" x 1/2" Swivel Orifice Elbow .....	2
10	446188	¼	1/2" x 1/2" Swivel Orifice Elbow .....	2
-	785109	½	3/8" Hydraulic Hose x 109" .....	2
-	785126	½	3/8" Hydraulic Hose x 126" .....	2
11	301820	88	Leveling Arm (For 1½" Dia. Rod) .....	2
12	301819	19¾	Leveling Arm End – 1-1/2" Dia. ....	2
-	410032	¾	Lock Nut -- 1-1/2" NF Nylon Insert - Zinc .....	2
-	413024	¼	Flat Washer -- 1-1/2" .....	2
-	413120	-	Machine Washer -- 1-1/2" ID x 10 Ga .....	2
-	450004	-	1/4" Drive-in Grease Fitting .....	2
-	401095	-	Form 1 Bushing -- 1-7/8" OD x 1-1/2" ID x 1" Long .....	4
13	301824	1¾	Small Pin -- 1-1/4" x 2-1/2" Stacker Bar .....	4
-	411545	-	Hex Bolt -- 1/2" x 1-1/2" NC - Gr 5 - Zinc .....	4
-	413008	-	Flat Washer -- 1/2" - Zinc .....	4
-	413508	-	Lock Washer -- 1/2" - Zinc .....	4
14	479075	6½	Friction Trip Foot (See Page 6)	
15	204210	25	Vertical Shank C1080 (See Page 6)	
16	302001	29	5" Offset Shank – LH (See Page 6)	
17	302004	14½	Parking Stand .....	2
-	416230	¾	3/4" Safety Lock Pin x 5-1/2" OAL - Zinc .....	2

# WING

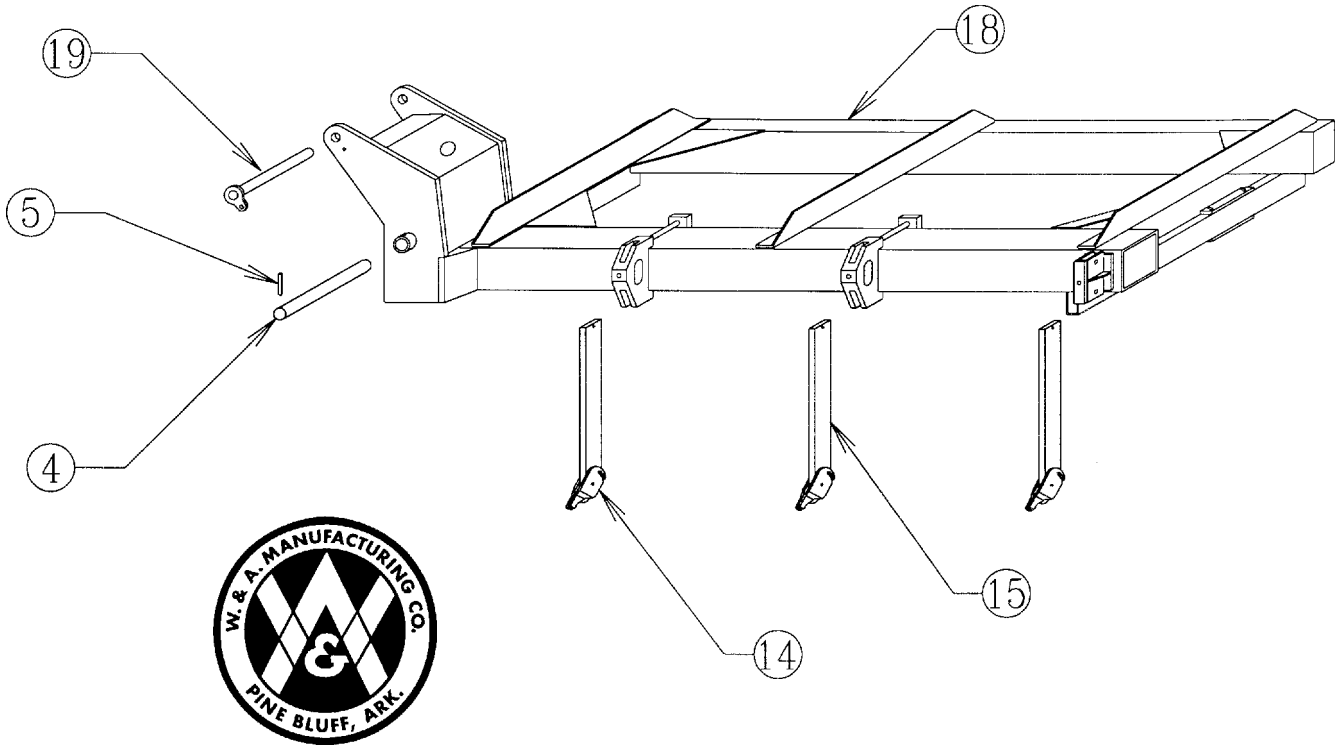

<u>Item No.</u>	<u>Part No.</u>	<u>Wt. Lbs.</u>	<u>Description</u>	<u>Qty. Req'd for 1 Machine</u>
4	203948	14¼	2" Pivot Pin x 16-1/4" .....	2
-	413124	-	Machine Washer -- 3" OD x 2" ID x 10 Ga .....	4
5	416133	-	Roll Pin -- 1/2" x 3-1/2" .....	2
14	479075	6½	Friction Trip Foot (See Page 6)	
15	204210	25	Vertical Shank C1080 (See Page 6)	
18	302044	964	Wing – LH (Shown) .....	1
-	302043	964	Wing – RH .....	1
19	301825	8	Top Pin -- Top Leveling Stacker .....	2
-	411545	-	Hex Bolt -- 1/2" x 1-1/2" NC - Gr 5 - Zinc .....	2
-	413008	-	Flat Washer -- 1/2" - Zinc .....	2
-	413508	-	Lock Washer -- 1/2" - Zinc .....	2

# ROLLER

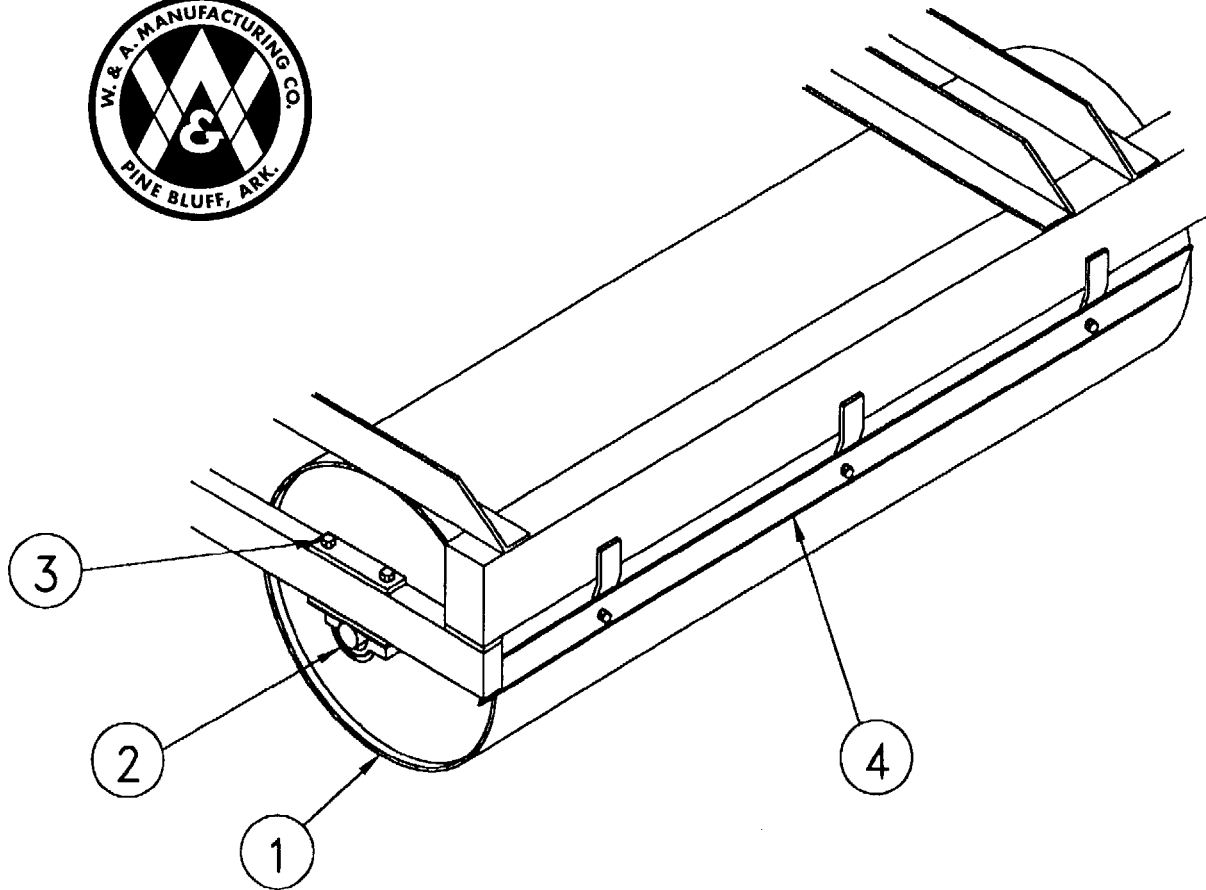

<u>Item No.</u>	<u>Part No.</u>	<u>Wt. Lbs.</u>	<u>Description</u>	<u>Qty. Req'd for 1 Machine</u>
1	302039	1020	113" Roller .....	4
2	482101	4	1-15/16" Pillow Block & Bearing .....	8
-	481215	1	1-15/16" Bearing w/Lock Collar Peer - #G115-KRRB-S1115K .....	-
-	480006	3	Pillow Block for 1-15/16" Bearing .....	-
3	411573	3/4	Hex Bolt -- 5/8" x 7" NC - Gr 5 - Zinc .....	16
-	413010	-	Flat Washer -- 5/8" - Zinc .....	16
-	410009	-	Lock Nut -- 5/8" NC - Zinc .....	16
4	204281	32	Scraper 113" (Bed Maker) .....	4
-	411731	-	Carriage Bolt -- 1/2" x 1-1/2" NC - Gr 2 - Zinc .....	16
-	413508	-	Lock Washer -- 1/2" - Zinc .....	16
-	412008	-	Hex Nut -- 1/2" - 13 - Gr 2 - Zinc .....	16

# BOLT-ON SHANK HOLDERS

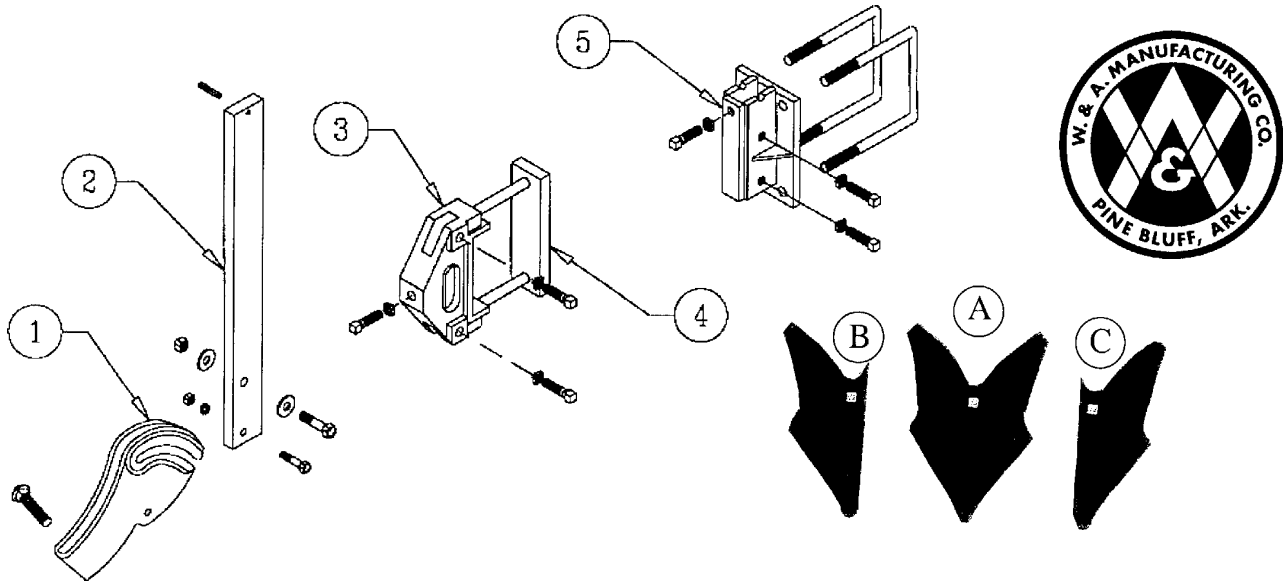

Item No.	Part No.	Wt. Lbs.	Description	Qty. Req'd for 1 Machine
1	479075	6½	Friction Trip Foot (Bed Maker) .....	13
-	411549	-	Hex Bolt -- 1/2" x 2-1/2" NC - Gr 5 - Zinc .....	13
-	411563	½	Hex Bolt -- 5/8" x 3" NC - Gr 5 - Zinc .....	13
-	411794	½	Carriage Bolt -- 3/4" x 3-1/2" NC - Gr 5 - Zinc .....	13
-	410009	-	Lock Nut -- 5/8" NC - Zinc .....	13
-	410012	-	Lock Nut -- 3/4" NC - Zinc .....	13
-	412008	-	Hex Nut -- 1/2" - 13 - Gr 2 - Zinc .....	13
-	413056	-	Flat Washer, Heavy -- 5/8" - Zinc .....	26
-	413058	-	Flat Washer, Heavy -- 3/4" - Zinc .....	13
-	413508	-	Lock Washer -- 1/2" - Zinc .....	13
2	204210	25	Vertical Shank C1080 (Bed Maker) .....	11
-	416120	-	Roll Pin, 3/8" x 2" .....	13
3	479069	13½	Bolt-On Shank Holder .....	8
-	414829	-	Square Head Set Screw, 5/8" x 2" .....	24
-	412310	-	Square Nut -- 5/8" - 11 - Gr 2 - Zinc .....	24
-	412410	-	Jam Nut -- 5/8" - 11 - Gr 2 - Zinc .....	24
4	204274	9	Backing Plate .....	8
-	411601	1¼	Hex Bolt -- 3/4" x 8-1/2" Gr. 5 .....	16
-	412012	-	Hex Nut -- 3/4" - 10 - Gr 2 - Zinc .....	24
-	413512	-	Lock Washer -- 3/4" - Zinc .....	24
5	302036	19½	Center Bolt-On Shank Holder .....	2
-	414829	-	Square Head Set Screw, 5/8" x 2" .....	12
-	412410	-	Jam Nut -- 5/8" - 11 - Gr 2 - Zinc .....	12
-	415004	2½	3/4" Sq. U-Bolt x 7" x 9" Leg .....	4
16	302001	29	5" Offset Shank – LH (Shown) .....	1
N/I	302000	29	5" Offset Shank – RH .....	1
A	474031	7¼	#11N Furrower.....(11" Top Width) .....	11
N/I	474032	12¼	#12 Furrower.....(15" Top Width) .....	-
B	204215		#11N End Furrower -- RH .....	1
C	204216		#11N End Furrower -- LH .....	1

NOTE: On 12@ 40" Row Bed Maker -- THREE Shank Holders are welded on frame.



# HITCH ASSEMBLY

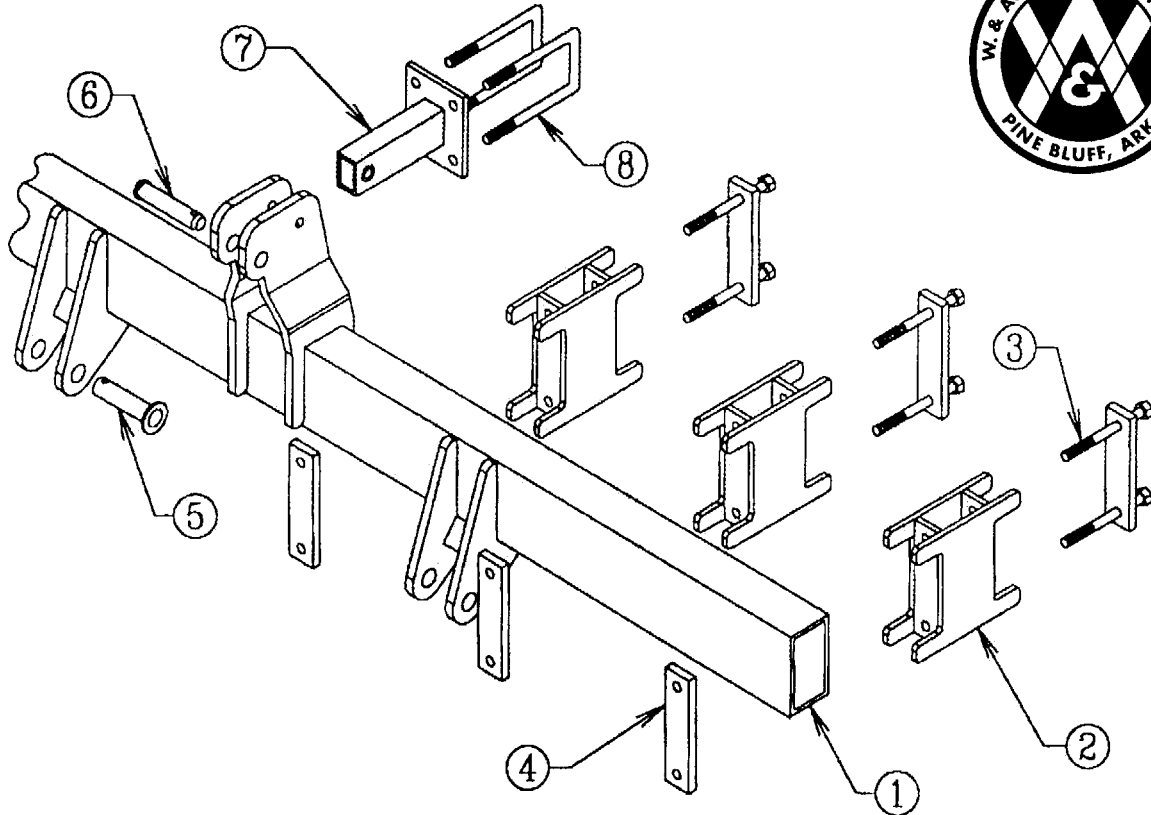

<u>ITEM NO.</u>	<u>PART NO.</u>	<u>WT. LBS.</u>	<u>DESCRIPTION</u>	<u>QTY. REQ'D FOR 1 HITCH</u>
1	301833	361	Wide Hitch -- Top Leveling Stacker .....	1
2	302014	25	5" Spacer Block .....	6
3	203960	5	Backing Plate .....	6
-	411604	1¼	Hex Bolt -- 3/4" x 10" - Gr 5 - Zinc (Back Plate) .....	12
-	412012	-	Hex Nut -- 3/4" - 10 - Gr 2 - Zinc (Back Plate) .....	29
-	413512	-	Lock Washer -- 3/4" - Zinc (Back Plate) .....	29
4	203960	5	Backing Plate -- Top Leveling Stacker .....	6
-	411598	½	Hex Bolt -- 3/4" x 6-1/2" NC - Gr 5 - Zinc (Front Plate) ....	12
5	300837	3	Pull Pin -- 1-7/16" x 6" .....	2
-	416207	-	7/16" Klik Pin - Zinc .....	2
6	416698	2	1-1/4" Top Link Pin - Zinc .....	1
-	416207	-	7/16" Klik Pin - Zinc .....	1
7	301836	11	Top Connector, 5" Spacer Blocks .....	1
-	411594	¾	Hex Bolt -- 3/4" x 5" NC - Gr 5 - Zinc .....	1
8	415006	2	3/4" Sq. U-Bolt x 4" x 8-1/2" Leg .....	2

# 7 x 7 BAR GAUGE WHEEL

## FOR ROLLING BED MAKER AND HIGH CLEAR CULTIVATOR

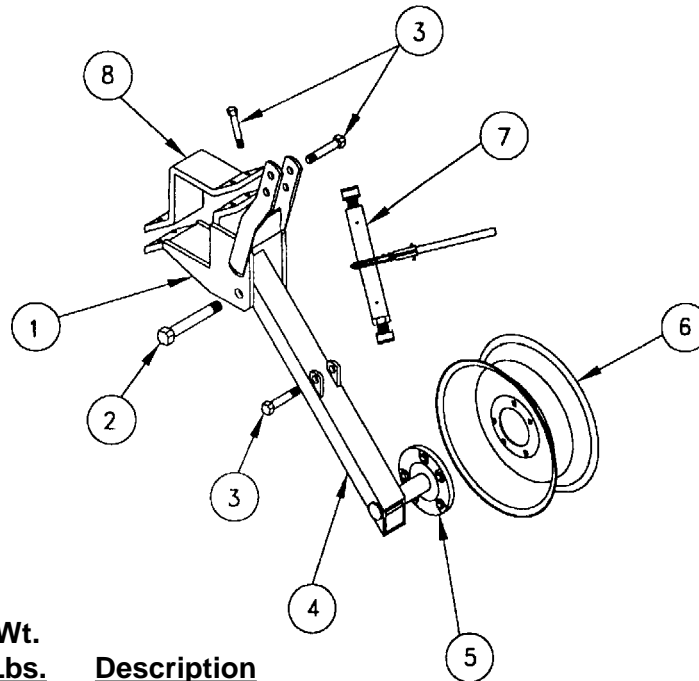

**No. 1320  
& No. 1321\***

\*Used on Bed  
Maker center  
section with  
weld-on holder.

<u>Item No.</u>	<u>Part No.</u>	<u>Wt. Lbs.</u>	<u>Description</u>	<u>Qty. Req'd for Assembly</u>
1	302020	35½	Holder .....	1
2	411598	1	Hex Bolt -- 1" x 6-1/2" NC - Gr 2 - Zinc .....	1
-	412016	-	Hex Nut -- 1" - 8 - Gr 2 - Zinc .....	1
-	413516	-	Lock Washer -- 1" - Zinc .....	1
3	411591	½	Hex Bolt -- 3/4" x 4" NC - Gr 5 - Zinc .....	6
-	412012	-	Hex Nut -- 3/4" - 10 - Gr 2 - Zinc .....	6
-	413512	-	Lock Washer -- 3/4" - Zinc .....	6
4	302022	42½	LH Leg w/Hub - #1320 Gauge Wheel (Shown) .....	1
-	302024	50	Offset Leg LH w/Spind & Hub (1321 Ga Wh) (N/I) .....	1
-	302021	42½	RH Leg w/Hub - #1320 Gauge Wheel .....	1
-	302023	50	Offset Leg RH w/Spind & Hub (1321 Ga Wh) (N/I) .....	1
5	491119	10	5 Hole Hub Complete - Q-719 .....	1
-	491007	9¾	Hub w/Cups Only - Q-719 .....	1
-	481205	¼	Cone - Q719 - LM67048 .....	1
-	496010	-	Outer Cup - Q719 - LM67010 .....	1
-	481204	¼	Cone - Q719 - LM48548 .....	1
-	496011	-	Inner Cup - Q719 - LM48510 .....	1
-	497010	-	Grease Seal - Q719 - CR 15190 .....	1
-	490006	¼	Hub Cap - Q719 .....	1
-	490015	-	1/2" NF Lug Nut .....	5
-	490017	-	Drive-In Hub Bolt - Q719 .....	5
-	412164	-	Slotted Nut -- 7/8" - 14 Spindle .....	1
-	490034	-	Spindle Washer -- 7/8" - Q719 .....	1
6	493007	17	15" x 5" x 5 Hole Wheel .....	1
7	302025	11½	Ratchet Crank Assembly .....	1
8	204242	13½	Backing Plate .....	1

# **STACKING ROLLING BEDMAKER**

**Model No. 1742 -- 16 @ 30" Row**

# CENTER SECTION

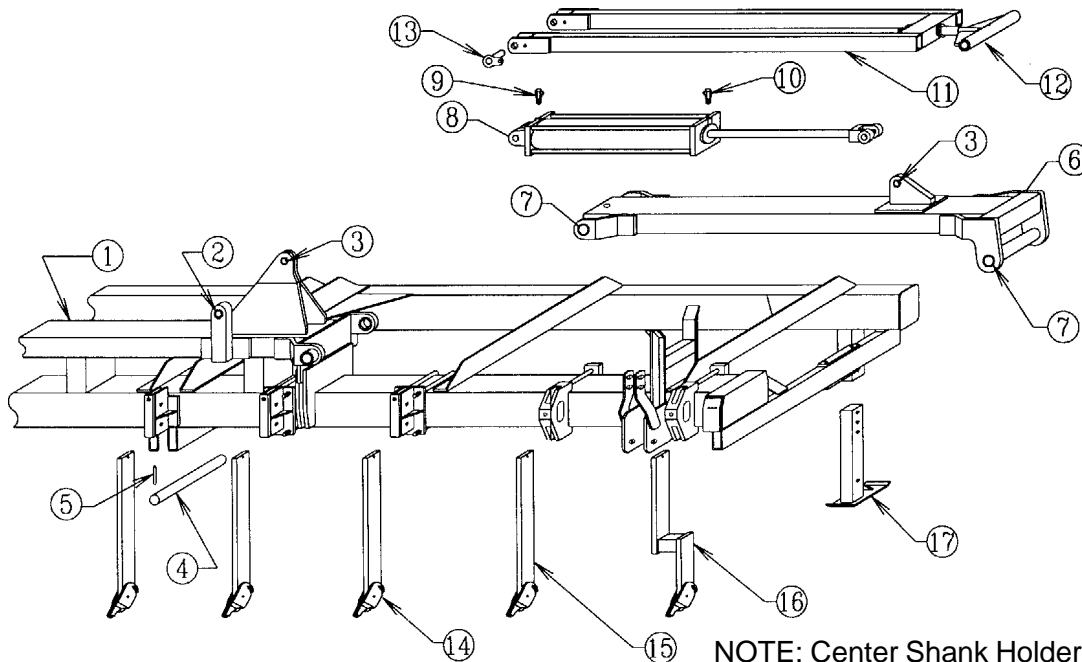

NOTE: Center Shank Holder weld-on,  
others use bolt-on shank holders

<u>Item No.</u>	<u>Part No.</u>	<u>Wt. Lbs.</u>	<u>Description</u>	<u>Qty. Req'd for One Machine</u>
1	302042	2160	Center Section - 16 @ 30" Row .....	1
2	401084	¼	Form 1 Bushing -- 1½" OD x ¼" ID x 1½" Long .....	4
3	401080	¼	Form 1 Bushing -- 1½" OD x ¼" ID x 1" Long .....	4
4	203948	14¼	2" Pivot Pin x 16¼" .....	2
-	413124	-	Machine Washer -- 3" OD x 2" ID x 10 Ga .....	4
5	416133	-	Roll Pin -- 1/2" x 3½" - Zinc .....	2
6	301802	265	Power Arm -- Top Leveling Stacker .....	2
7	401118	½	Bushing -- 2.376" OD x 2.006" ID x 2" Long .....	8
-	450004	-	1/4" Drive-in Grease Fitting .....	4
8	476029	126	Hydraulic Cylinder -- 5" x 30" (w/Pins) .....	2
-	477056	-	Seal Kit -- 5" x 24" & 5" x 30" Lion Cyl. - 2" Rod .....	-
9	446188	¼	1/2" x 1/2" Swivel Orifice Elbow .....	2
10	446188	¼	1/2" x 1/2" Swivel Orifice Elbow .....	2
-	785103	½	3/8" Hydraulic Hose x 103" .....	2
-	785120	½	3/8" Hydraulic Hose x 120" .....	2

# CENTER SECTION (Continued)

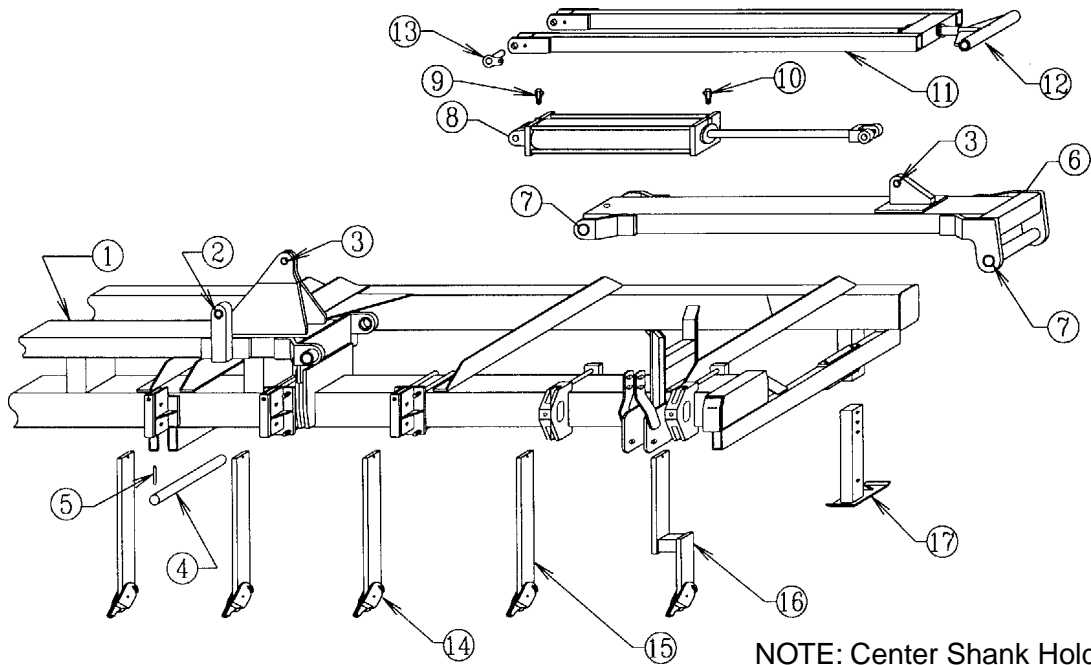

NOTE: Center Shank Holder weld-on,  
others use bolt-on shank holders

<u>Item No.</u>	<u>Part No.</u>	<u>Wt. Lbs.</u>	<u>Description</u>	<u>Qty. Req'd for One Machine</u>
11	301820	88	Leveling Arm -- For 1½" Dia. Rod .....	2
12	301819	19¾	Leveling Arm End with Lock Nut – 1½" Dia.Rod .....	2
-	410032	1	Lock Nut -- 1½" NF Top Lock - Zinc .....	2
-	412024	¾	Hex Nut -- 1½" - 6 - Gr 2 - Zinc .....	2
-	413120	-	Machine Washer -- 2¼" OD x 1½" ID x 10 Ga .....	2
-	450004	-	1/4" Drive-in Grease Fitting .....	2
-	401095	-	Form 1 Bushing -- 1-7/8" OD x 1½" ID x 1"Long.....	4
13	301824	1¾	Small Pin -- 1¼" x 2½" Stacker Bar .....	4
-	411545	-	Hex Bolt -- 1/2" x 1½" NC - Gr 5 - Zinc .....	4
-	413008	-	Flat Washer -- 1/2" - Zinc .....	4
-	413508	-	Lock Washer -- 1/2" - Zinc .....	4
14	479075	6½	Friction Trip Foot (See Page 6)	
15	204210	25	Vertical Shank C1080 (See Page 6)	
16	302001	29	5" Offset Shank – LH (See Page 6)	
17	302004	14½	Parking Stand .....	2
-	416230	¾	3/4" Safety Lock Pin x 5½" OAL - Zinc .....	2

# WING

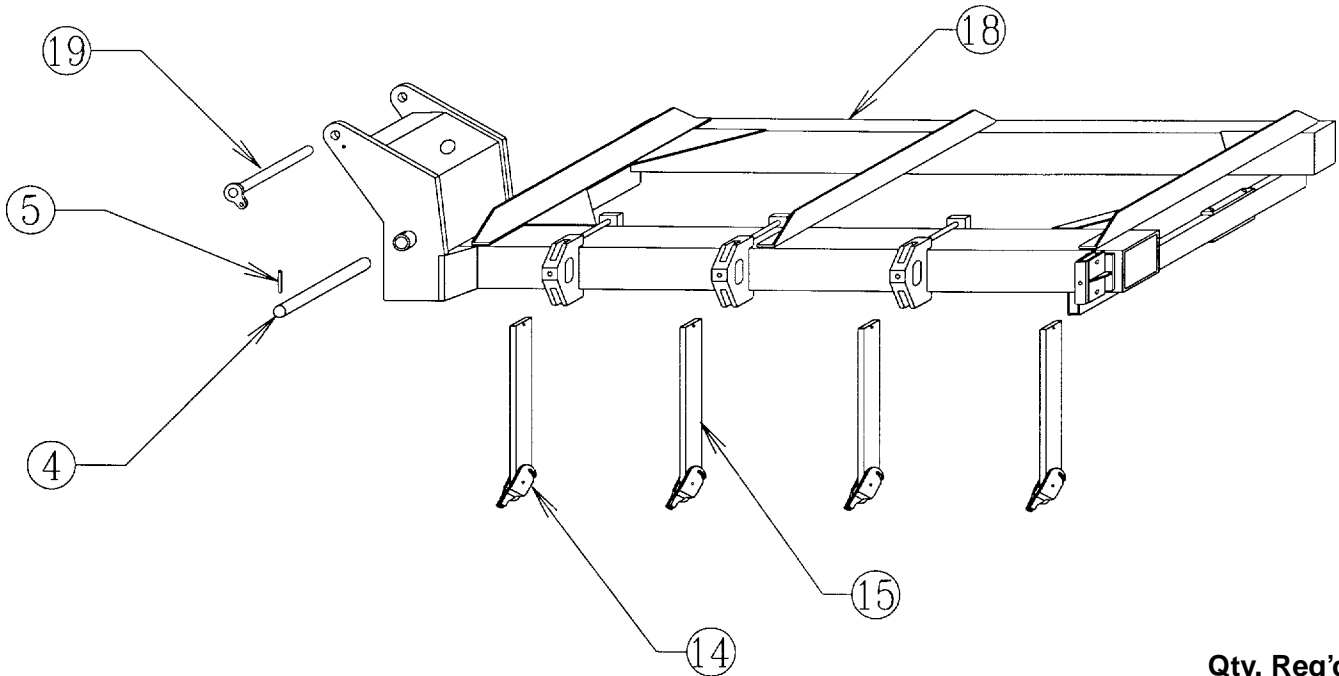

Item No.	Part No.	Wt. Lbs.	Description	Qty. Req'd for One Machine
4	203948	14¼	2" Pivot Pin x 16¼" .....	2
-	413124	-	Machine Washer -- 3" OD x 2" ID x 10 Ga .....	4
5	416133	-	Roll Pin -- 1/2" x 3½" - Zinc .....	2
14	479075	6½	Friction Trip Foot (See Page 6)	
15	204210	25	Vertical Shank C1080 (See Page 6)	
18	302044	964	Wing – LH - 16 @ 30" Row (Shown) .....	1
-	302043	964	Wing – RH - 16 @ 30" Row .....	1
19	301825	8	Top Pin -- Top Leveling Stacker .....	2
-	411545	-	Hex Bolt -- 1/2" x 1½" NC - Gr 5 - Zinc .....	2
-	413008	-	Flat Washer -- 1/2" - Zinc .....	2
-	413508	-	Lock Washer -- 1/2" - Zinc .....	2

**USE ONLY**



**W & A REPLACEMENT PARTS**

# ROLLER

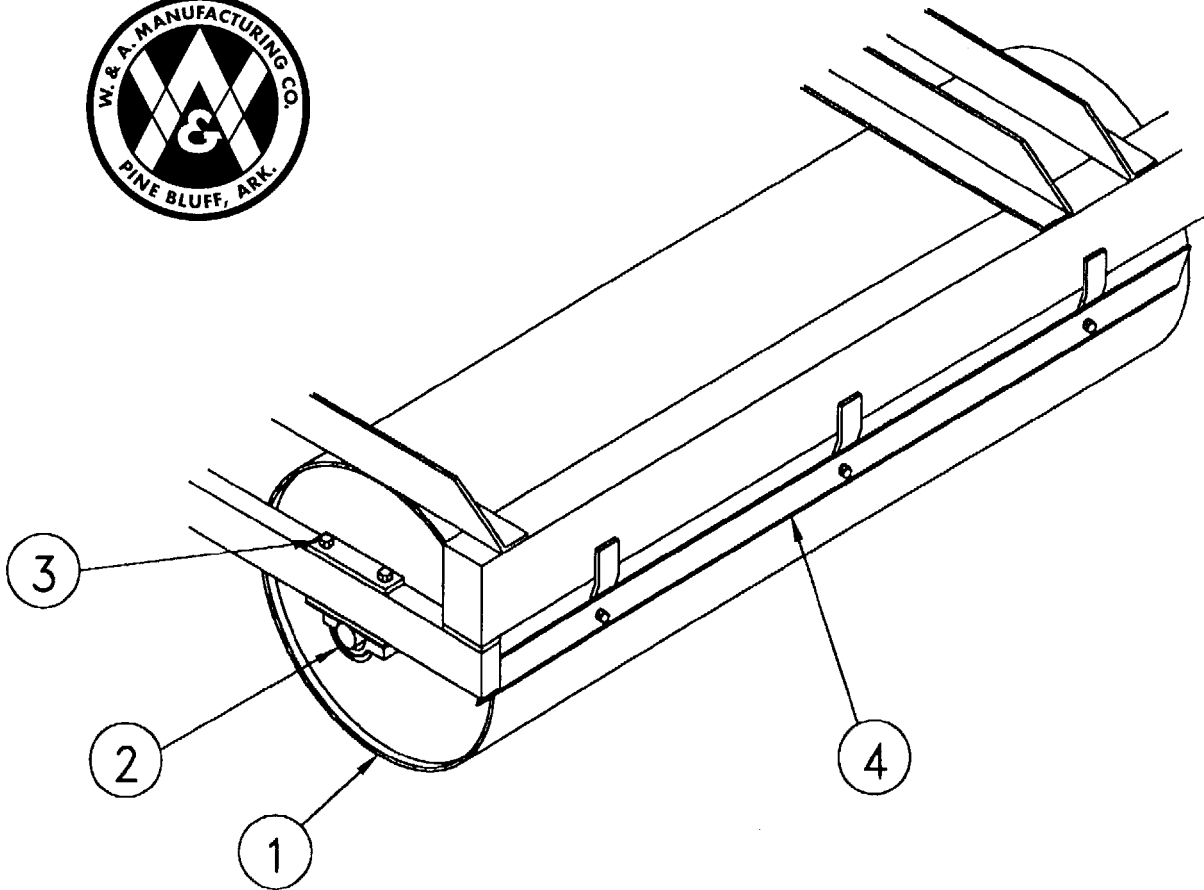

<u>Item No.</u>	<u>Part No.</u>	<u>Wt. Lbs.</u>	<u>Description</u>	<u>Qty. Req'd for One Machine</u>
1	302039	1020	113" Roller -- 16 @ 30" Row Bed Maker .....	4
2	482101	4	1-15/16" Pillow Block & Bearing Complete .....	8
-	481215	1	1-15/16" Bearing w/Lock Collar.....#G115-KRRB-S1115K .....	-
-	480006	3	Pillow Block for 1-15/16" Bearing .....	-
3	411573	¾	Hex Bolt -- 5/8" x 7" NC - Gr 5 - Zinc .....	16
-	413010	-	Flat Washer -- 5/8" - Zinc .....	16
-	410009	-	Lock Nut -- 5/8" NC - Gr 2 - Zinc .....	16
4	204281	32	Scraper 113" -- 16 @ 30" Row Bed Maker .....	4
-	411785	-	Carriage Bolt -- 1/2" x 1½" NC - Gr 5 - Zinc .....	16
-	413508	-	Lock Washer -- 1/2" - Zinc .....	16
-	412008	-	Hex Nut -- 1/2" - 13 - Gr 2 - Zinc .....	16

# BOLT-ON SHANK HOLDERS

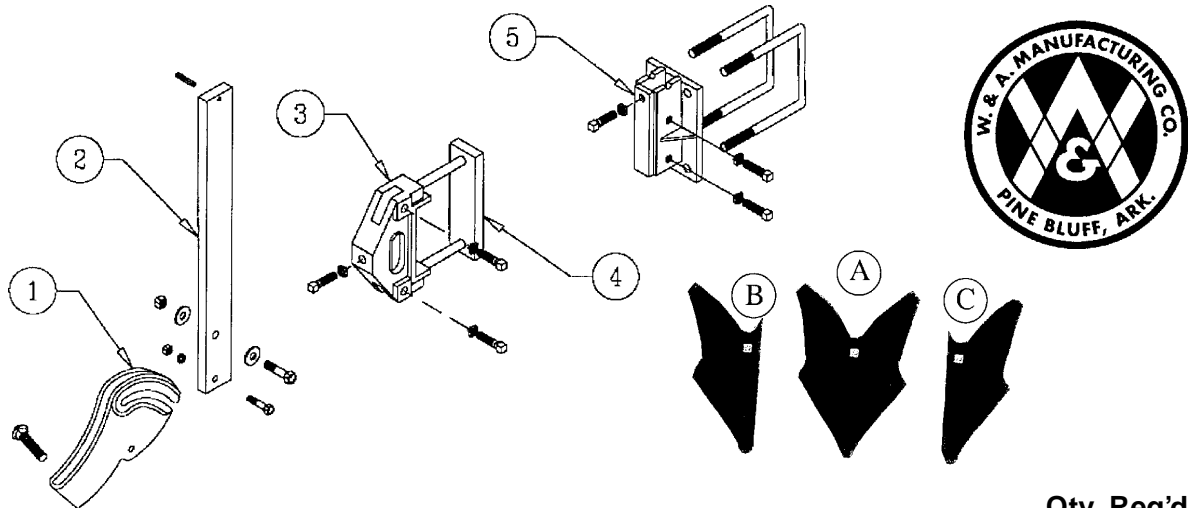

Item No.	Part No.	Wt. Lbs.	Description	Qty. Req'd for One Machine
1	479075	6½	Friction Trip Foot .....	17
-	411549	-	Hex Bolt -- 1/2" x 2½" NC - Gr 5 - Zinc .....	17
-	411563	½	Hex Bolt -- 5/8" x 3" NC - Gr 5 - Zinc .....	17
-	411794	½	Carriage Bolt -- 3/4" x 3½" NC - Gr 5 - Zinc .....	17
-	410009	-	Lock Nut -- 5/8" NC - Gr 2 - Zinc .....	17
-	410012	-	Lock Nut -- 3/4" NC - Gr 2 - Zinc .....	17
-	412008	-	Hex Nut -- 1/2" - 13 - Gr 2 - Zinc .....	17
-	413056	-	Flat Washer, Heavy -- 5/8" - Zinc .....	24
-	413058	-	Flat Washer, Heavy -- 3/4" - Zinc .....	17
-	413508	-	Lock Washer -- 1/2" - Zinc .....	17
2	204210	25	Vertical Shank C1080 .....	15
-	416120	-	Roll Pin -- 3/8" x 2" - Zinc .....	17
3	479069	13½	Bolt-On Shank Holder - 7" Tool Bar .....	10
-	414828	-	Square Head Set Screw -- 5/8" x 1¾" .....	30
-	412310	-	Square Nut -- 5/8" - 11 - Gr 2 - Zinc .....	30
-	412410	-	Jam Nut -- 5/8" - 11 - Gr 2 - Zinc .....	30
4	204274	9	Backing Plate for Bolt-on Shank Holder - 7" .....	10
-	411601	1¼	Hex Bolt -- 3/4" x 8-1/2" NC - Gr. 5 - Zinc .....	20
-	412012	-	Hex Nut -- 3/4" - 10 - Gr 2 - Zinc .....	36
-	413512	-	Lock Washer -- 3/4" - Zinc .....	36
5	302036	19½	Center Bolt-On Shank Holder .....	4
-	414828	-	Square Head Set Screw -- 5/8" x 1¾" .....	18
-	412410	-	Jam Nut -- 5/8" - 11 - Gr 2 - Zinc .....	18
-	415004	2½	3/4" Sq. U-Bolt x 7" x 9" Leg .....	8
6	302001	29	5" Offset Shank – LH (Shown) .....	1
N/I	302000	29	5" Offset Shank – RH .....	1
A	474031	7¼	#11N Furrower.....(11" Top Width) .....	15
N/I	474032	12¼	#12 Furrower.....(15" Top Width) .....	-
B	204215		#11N End Furrower -- RH .....	1
C	204216		#11N End Furrower -- LH .....	1

NOTE: On 16@ 30" Row Bed Maker -- THREE Shank Holders are welded on frame.



# HITCH ASSEMBLY

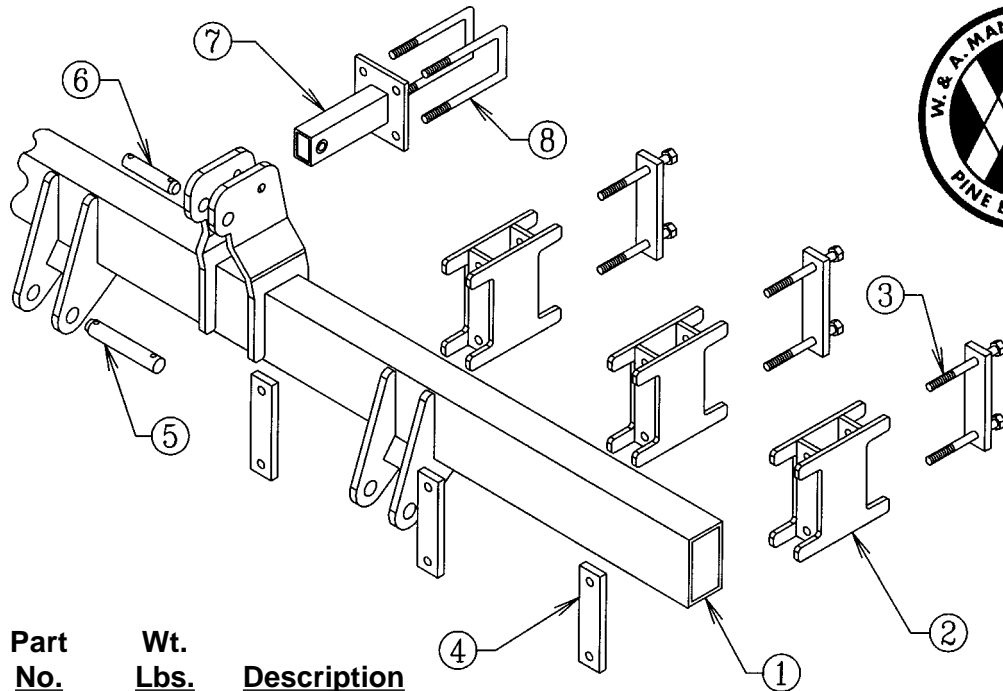

<u>Item No.</u>	<u>Part No.</u>	<u>Wt. Lbs.</u>	<u>Description</u>	<u>Qty. Req'd for One Hitch</u>
1	301833	361	Wide Hitch -- Top Leveling Stacker .....	1
2	302014	25	5" Spacer Block -- Top Leveling Stacker .....	6
3	203960	5	Backing Plate -- Top Leveling Stacker .....	6
-	411604	1 1/4	Hex Bolt -- 3/4" x 10" NC - Gr 5 - Zinc .....	12
-	412012	-	Hex Nut -- 3/4" - 10 - Gr 2 - Zinc .....	12
-	413512	-	Lock Washer -- 3/4" - Zinc .....	12
4	203960	5	Backing Plate -- Top Leveling Stacker .....	6
-	411598	1/2	Hex Bolt -- 3/4" x 6 1/2" NC - Gr 5 - Zinc .....	12
-	412012	-	Hex Nut -- 3/4" - 10 - Gr 2 - Zinc .....	12
-	413512	-	Lock Washer -- 3/4" - Zinc .....	12
5	200876	3 3/4	Hardened Pull Pin -- 1-7/16" x 8-3/8" - Zinc .....	2
-	416207	-	Klik Pin -- 7/16" - Zinc .....	2
-	416133	-	Roll Pin -- 1/2" x 3 1/2" - Zinc .....	2
6	200853	2	Hardened Top Link Pin -- 1 1/4" - Zinc .....	1
-	416207	-	Klik Pin -- 7/16" - Zinc .....	1
-	416120	-	Roll Pin -- 3/8" x 2" - Zinc .....	1
7	301836	11	Top Connector -- 5" Spacer - Hitch Assm .....	1
-	411594	3/4	Hex Bolt -- 3/4" x 5" NC - Gr 5 - Zinc .....	1
-	412012	-	Hex Nut -- 3/4" - 10 - Gr 2 - Zinc .....	1
-	413512	-	Lock Washer -- 3/4" - Zinc .....	1
8	415006	2	3/4" Sq. U-Bolt x 4" x 8 1/2" Leg .....	2
-	412012	-	Hex Nut -- 3/4" - 10 - Gr 2 - Zinc .....	4
-	413512	-	Lock Washer -- 3/4" - Zinc .....	4

# 7 x 7 BAR GAUGE WHEEL

## FOR ROLLING BED MAKER AND HIGH CLEAR CULTIVATOR

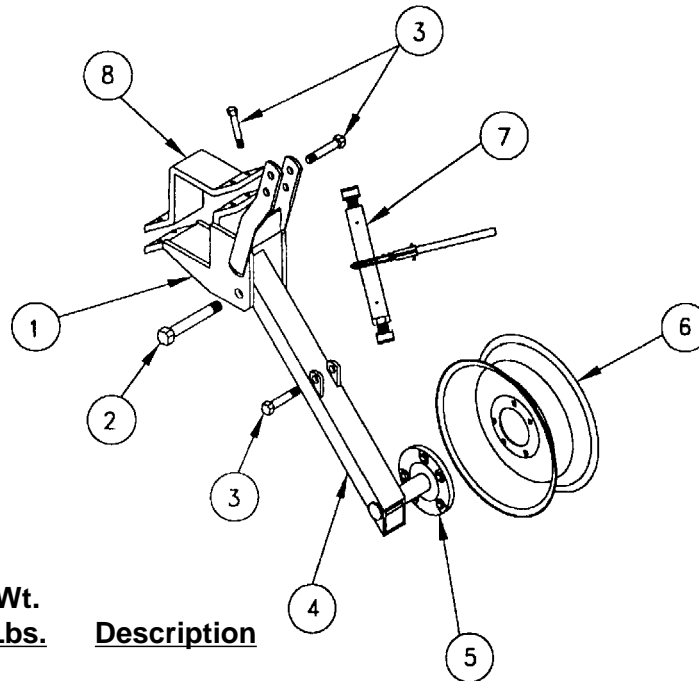

**No. 1320  
& No. 1321\***

\*Used on Bed  
Maker center  
section with  
weld-on holder.

<u>Item No.</u>	<u>Part No.</u>	<u>Wt. Lbs.</u>	<u>Description</u>	<u>Qty. Req'd for One Assembly</u>
1	302020	35¼	Holder - Gauge Wheel .....	1
2	411598	1	Hex Bolt -- 1" x 6½" NC - Gr 5 - Zinc .....	1
-	412016	-	Hex Nut -- 1" - 8 - Gr 2 - Zinc .....	1
-	413516	-	Lock Washer -- 1" - Zinc .....	1
3	411591	½	Hex Bolt -- ¾" x 4" NC - Gr 5 - Zinc .....	6
-	412012	-	Hex Nut -- ¾" - 10 - Gr 2 - Zinc .....	6
-	413512	-	Lock Washer -- ¾" - Zinc .....	6
4	302022	42½	LH Leg w/Hub - #1320 Gauge Wheel (Shown) .....	1
-	302021	42½	RH Leg w/Hub - #1320 Gauge Wheel .....	1
-	302024	50	Offset Leg LH w/Spind & Hub (1321 Ga Wh).....Not Illustrated .....	1
-	302023	50	Offset Leg RH w/Spind & Hub (1321 Ga Wh).....Not Illustrated .....	1
5	491119	10	5 Hole Hub Complete - Q-719 .....	1
-	491007	9¾	Hub w/Cups Only - Q-719 .....	1
-	481205	¼	Cone - Q809 & Q719 - LM67048 .....	1
-	496010	-	Outer Cup - Q809 & Q719 - LM67010 .....	1
-	481204	¼	Cone - Q809 & Q719 - LM48548 .....	1
-	496011	-	Inner Cup - Q809 & Q719 - LM48510 .....	1
-	497010	-	Grease Seal - Q719 - CR 15190 .....	1
-	490006	¼	Hub Cap - Q809 & Q719 .....	1
-	490015	-	1/2" NF Lug Nut .....	5
-	490017	-	Drive-In Hub Bolt - Q719 .....	5
-	412164	-	Slotted Nut -- 7/8" - 14 Spindle .....	1
-	490034	-	Spindle Washer -- 7/8" - Q875/Q809/Q719 .....	1
6	493007	17	15" x 5" x 5 Hole Wheel .....	1
7	302025	11½	Ratchet Crank Assembly .....	1
8	204242	13½	Backing Plate -- Bed Maker Gauge Wheel .....	1