

RIGID PULVAMIZER

Model No. 3504 -- 4 Row

Model No. 3544 -- 4 Row with S Tines

FRAME

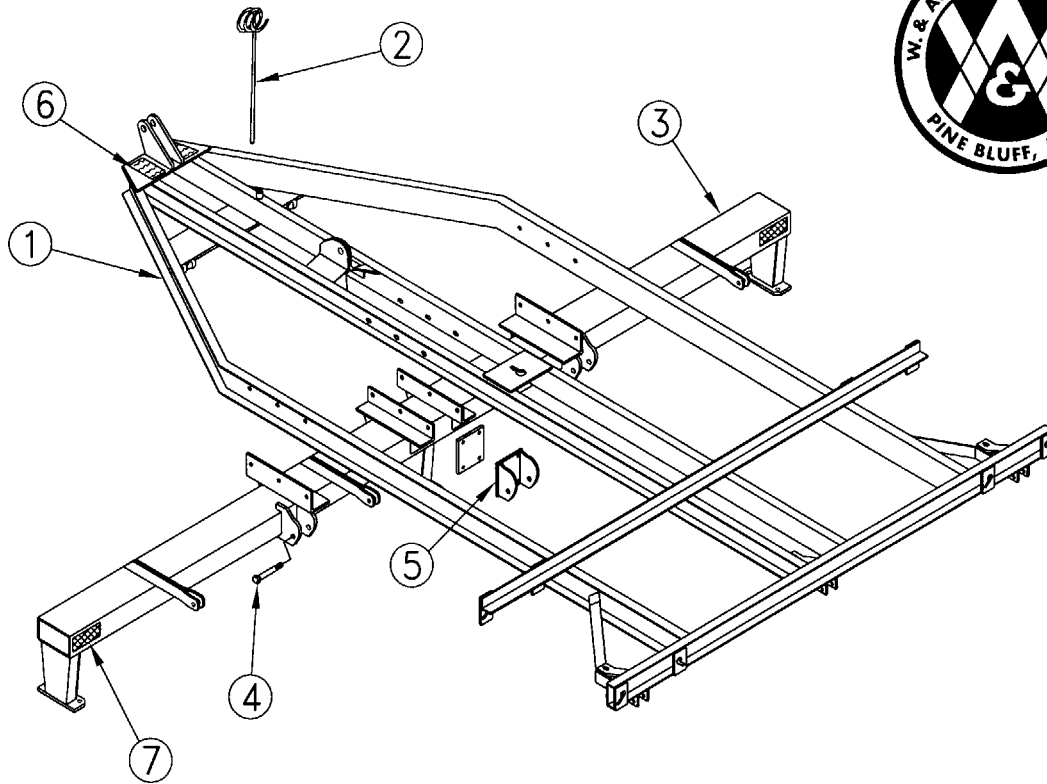

| <u>Item No.</u> | <u>Part No.</u> | <u>Wt. Lbs.</u> | <u>Description</u> | <u>Qty. Req'd for 1 Machine</u> |
|-----------------|-----------------|-----------------|---|---------------------------------|
| 1 | 300396 | 480 | Main Frame -- 4N & 4ND | 1 |
| - | 411060 | - | Hex Bolt -- 5/8" - 18 x 2" - Gr 5 - Zinc | 12 |
| - | 412010 | - | Hex Nut -- 5/8" - 11 - Gr 2 - Zinc | 12 |
| - | 413010 | - | Flat Washer -- 5/8" - Zinc | 12 |
| - | 413510 | - | Lock Washer -- 5/8" - Zinc | 12 |
| - | 416662 | - | Clevis Pin -- 1" x 3 1/2" - Zinc | 2 |
| - | 416309 | - | Rue Ring Cotter Pin -- 1" - Zinc | 2 |
| 2 | 200523 | 3 | Hose Bracket -- 4N & 4ND | 1 |
| 3 | 300410 | 315 | Reel Frame -- 4N & 4ND | 1 |
| 4 | 411594 | 1 | Hex Bolt -- 3/4" x 5" NC - Gr 5 - Zinc | 3 |
| - | 413512 | - | Lock Washer -- 3/4" - Zinc | 3 |
| - | 412012 | - | Hex Nut -- 3/4" - 10 - Gr 2 - Zinc | 3 |
| 5 | 300448 | 9 | Attaching Bracket -- 4N & 4ND | 1 |
| - | 200541 | 4 3/4 | Backing Plate -- 4N & 4ND | 1 |
| - | 411207 | 1/2 | Hex Bolt -- 1/2" x 9" - Gr 2 - Zinc | 4 |
| - | 412008 | - | Hex Nut -- 1/2" - 13 - Gr 2 - Zinc | 4 |
| - | 413508 | - | Lock Washer -- 1/2" - Zinc | 4 |
| 6 | 461123 | - | Warning Decal -- Operator's Manual | 1 |
| - | 461113 | - | Warning Decal -- High Pressure Fluid | 1 |
| - | 461138 | - | Danger Decal -- Crushing Hazard | 1 |
| 7 | 461201 | - | Decal -- Red Reflector - 4 1/2" x 2" | 2 |
| - | 461200 | - | Decal -- Amber Reflector - 4 1/2" x 2".....(Front of Bar) | 2 |

REEL

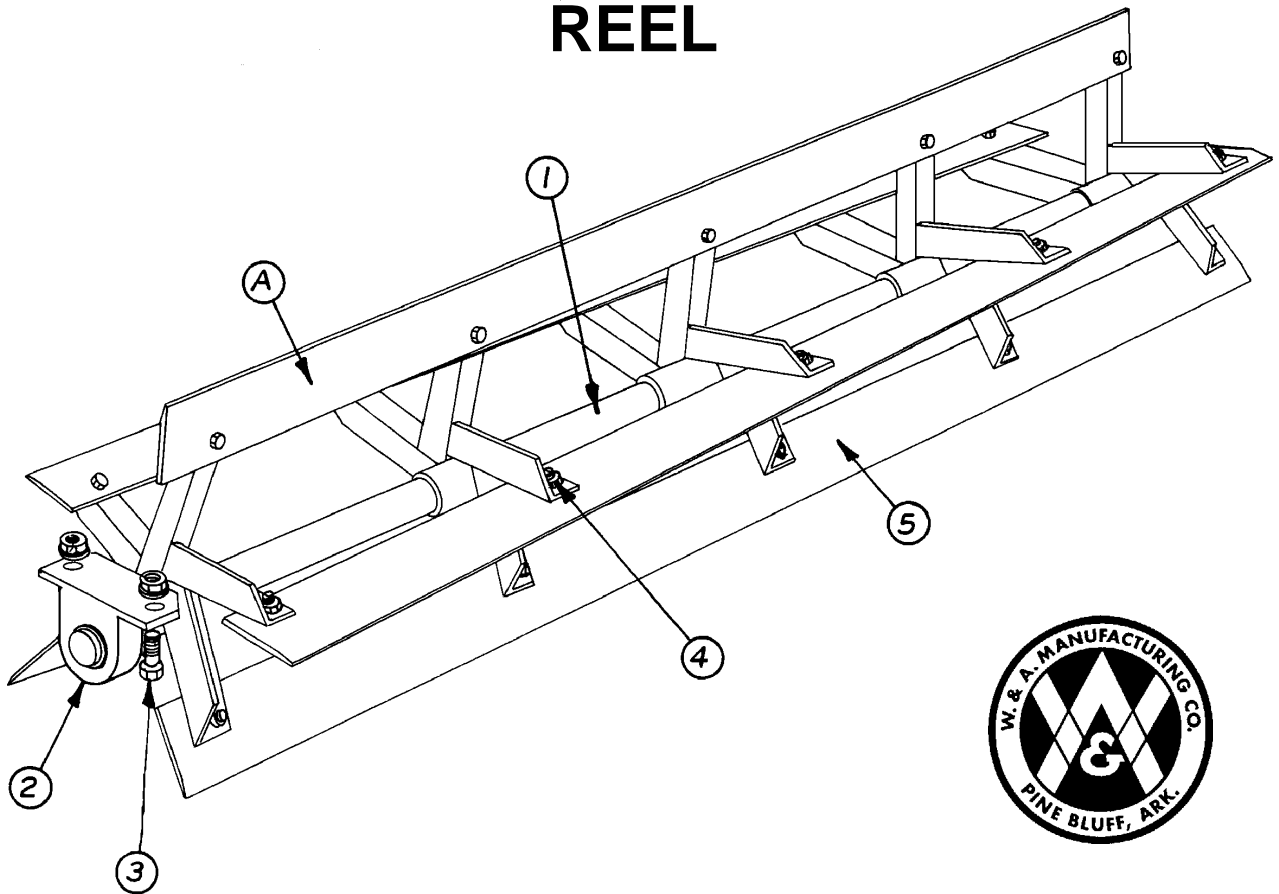

| <u>Item No.</u> | <u>Part No.</u> | <u>Wt. Lbs.</u> | <u>Description</u> | <u>Qty. Req'd for 1 Machine</u> |
|-----------------|-----------------|-----------------|---|---------------------------------|
| A | 770020 | 235 | Spiral 6 ft Reel Complete w/Bearings | 2 |
| 1 | 300451 | 116 | Spiral 77" Reel Shaft w/5 support brackets | 2 |
| 2 | 482101 | 4 | 1-15/16" Pillow Block & Bearing Complete | 4 |
| - | 481215 | 1 | 1-15/16" Bearing w/Lock Collar.....#G1115-KRRB-S1115K | - |
| - | 480006 | 3 | Pillow Block for 1-15/16" Bearing | - |
| 3 | 411562 | ¼ | Hex Bolt -- 5/8" x 2½" NC - Gr 5 - Zinc | 8 |
| - | 410009 | - | Lock Nut -- 5/8" NC - Gr 2 - Zinc | 8 |
| - | 413010 | - | Flat Washer -- 5/8" - Zinc | 8 |
| 4 | 411211 | ¼ | Hex Bolt -- 5/8" x 1¼" NC - Gr 2 - Zinc | 50 |
| - | 410009 | - | Lock Nut -- 5/8" NC - Gr 2 - Zinc | 50 |
| 5 | 200539 | 20 | Spiral Pulv Blade x 72" | 10 |

PULL TONGUE

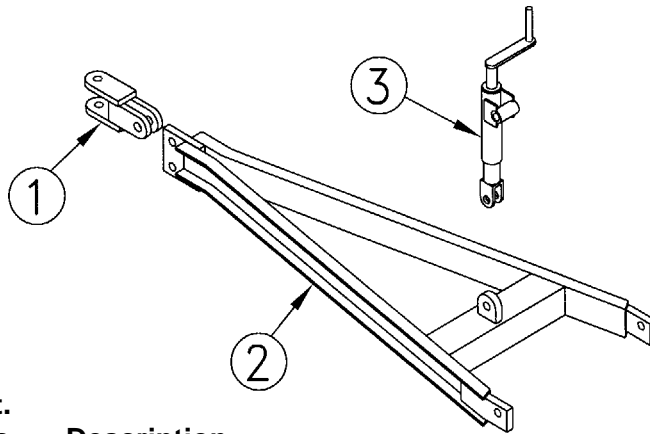

| Item No. | Part No. | Wt. Lbs. | Description | Qty. Req'd for 1 Machine |
|----------|----------|----------|--|--------------------------|
| 1 | 300368 | 37 | Pull Piece -- Pulv. Tongue | 1 |
| - | 416662 | ½ | Clevis Pin -- 1" x 3½" - Zinc | 1 |
| - | 416309 | - | Rue Ring Cotter Pin -- 1" - Zinc | 3 |
| 2 | 300364 | 120 | Pull Tongue -- 6' Pulv. | 1 |
| 3 | 505578 | 16 | Crank Assembly -- Pulv. | 1 |
| - | 300500 | 12½ | Top Half Crank -- Pulv. | 1 |
| - | 300502 | 3½ | Lower Half Crank -- Pulv. | 1 |
| - | 416659 | ½ | Clevis Pin -- 1" x 2-21/32" - Zinc | 1 |
| - | 416666 | ½ | Clevis Pin -- 1" x 4½" - Zinc | 1 |

LIFT FRAME

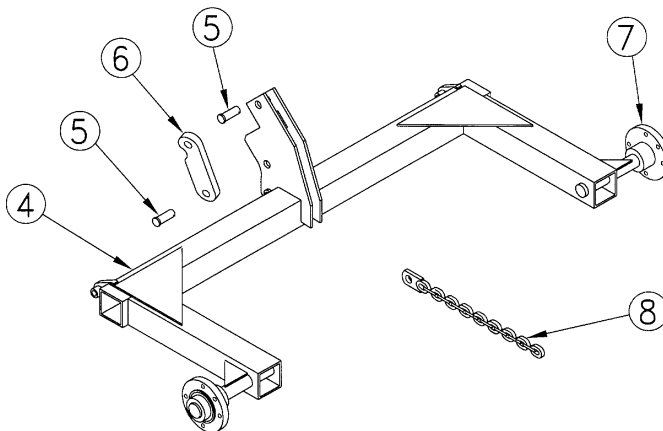

| | | | | |
|---|--------|-----|--|---|
| 4 | 300429 | 201 | Lift Frame w/Hubs -- 4N & 4ND | 1 |
| 5 | 416659 | ½ | Clevis Pin -- 1" x 2-21/32" - Zinc | 2 |
| - | 416309 | - | Rue Ring Cotter Pin -- 1" - Zinc | 2 |
| 6 | 201059 | 8 | Floating Arm -- 4N & 4ND | 1 |
| 7 | 491108 | 11½ | 6 Hole Hub Complete -- Q-809 | 2 |
| - | 481204 | ¼ | Cone - Q-809 & Q719 - LM48548 | 2 |
| - | 481205 | ¼ | Cone - Q-809 & Q719 - LM67048 | 2 |
| - | 490019 | - | Hub Bolt -- 1/2" NF - Q809 | 6 |
| - | 490006 | - | Hub Cap -- Q-809 & Q-719 | 2 |
| - | 787200 | - | 2 Pc Grease Seal (w/Wear Ring) - Q-809 | 2 |
| - | 492014 | 8 | Spindle -- 1-3/4" x 13-7/8"....(Weld-On) | 2 |
| - | 491009 | - | Hub with Cups Only -- Q809 | 2 |
| 8 | 300466 | 2 | Travel Lock | 1 |

HARROW & DRAGBOARD

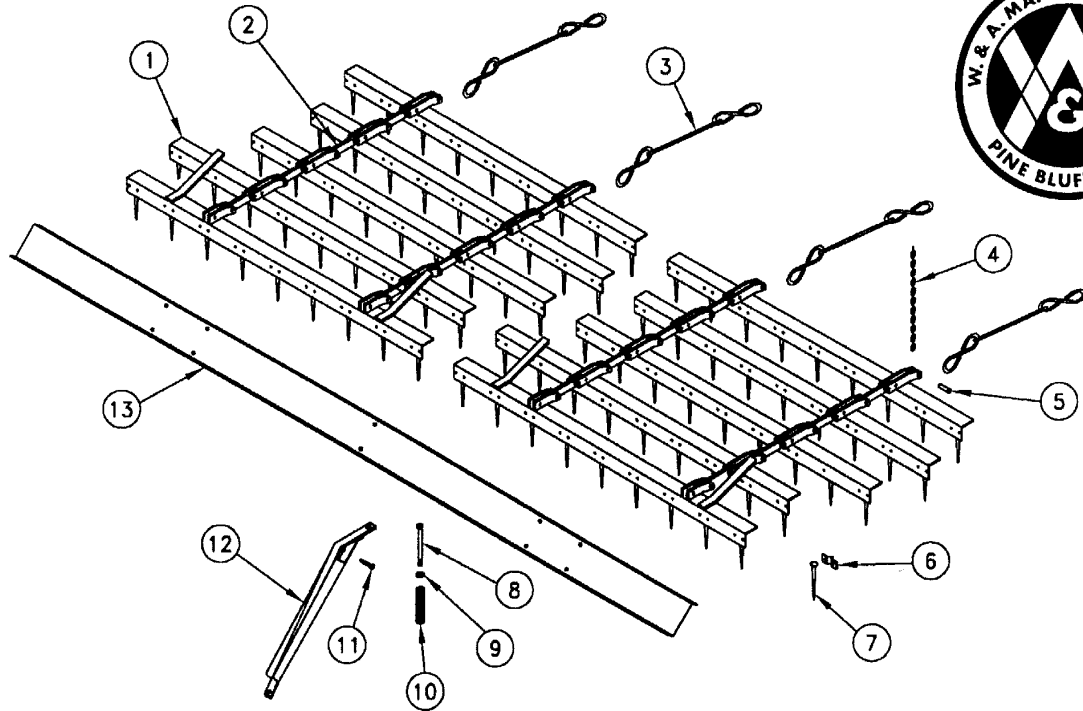

| Item No. | Part No. | Wt. Lbs. | Description | Qty. Req'd for 1 Machine |
|----------|----------|----------|---|--------------------------|
| 1 | 505500 | 250 | Complete 45 Tooth Harrow Asmb w/30" Chains – 4N & 4ND | 2 |
| 2 | 773012 | 2 | Connecting Link w/Bushings -- 7¾" long | 16 |
| 3 | 300476 | 7 | Pull Link -- Pulv Harrow | 4 |
| 4 | 402016 | 1 | Chain -- 1/4" x 30 Link | 8 |
| - | 400019 | - | 1/4" x 1¼" Lap Link - Zinc | 8 |
| - | 411512 | - | Hex Bolt -- 3/8" x 2½" NC - Gr 5 - Zinc | 8 |
| - | 412006 | - | Hex Nut -- 3/8" NC - 16 - Gr 2 - Zinc | 8 |
| - | 413506 | - | Lock Washer -- 3/8" - Zinc | 8 |
| 5 | 416633 | ¼ | Clevis Pin Knurled & Threaded -- 5/8" x 2¼" - Zinc | 36 |
| - | 410009 | - | Lock Nut -- 5/8" NC - Gr 2 - Zinc | 36 |
| 6 | 200550 | ½ | Harrow Tooth Bracket (Pulv) | 90 |
| - | 411143 | - | Hex Bolt -- 3/8" x 1¼" NC - Gr 2 - Zinc | 180 |
| 7 | 472007 | ½ | Harrow Tooth -- 5/8" x 7½" | 90 |
| 8 | 411237 | 1 | Hex Bolt -- 5/8" x 8" NC - Gr 2 - Zinc | 3 |
| - | 410009 | - | Lock Nut -- 5/8" NC - Gr 2 - Zinc | 3 |
| 9 | 202350 | - | Cup Washer for Spring | 3 |
| 10 | 471006 | 1½ | Compression Spring..... (1-1/2" OD x 6½") | 3 |
| 11 | 411551 | ¼ | Hex Bolt -- 1/2" x 3" NC - Gr 5 - Zinc | 3 |
| - | 410008 | - | Lock Nut -- 1/2" NC - Zinc | 3 |
| 12 | 300388 | 17 | Dragboard Bracket (Pulv) | 3 |
| - | 411729 | - | Carriage Bolt -- 1/2" x 1¼" NC - Gr 2 - Zinc | 6 |
| - | 412008 | - | Hex Nut -- 1/2" - 13 - Gr 2 - Zinc | 6 |
| - | 413508 | - | Lock Washer -- 1/2" - Zinc | 6 |
| 13 | 301491 | 71 | 13'0" Metal Dragboard..... | 1 |

TINE FRAME FOR DUAL MACHINE

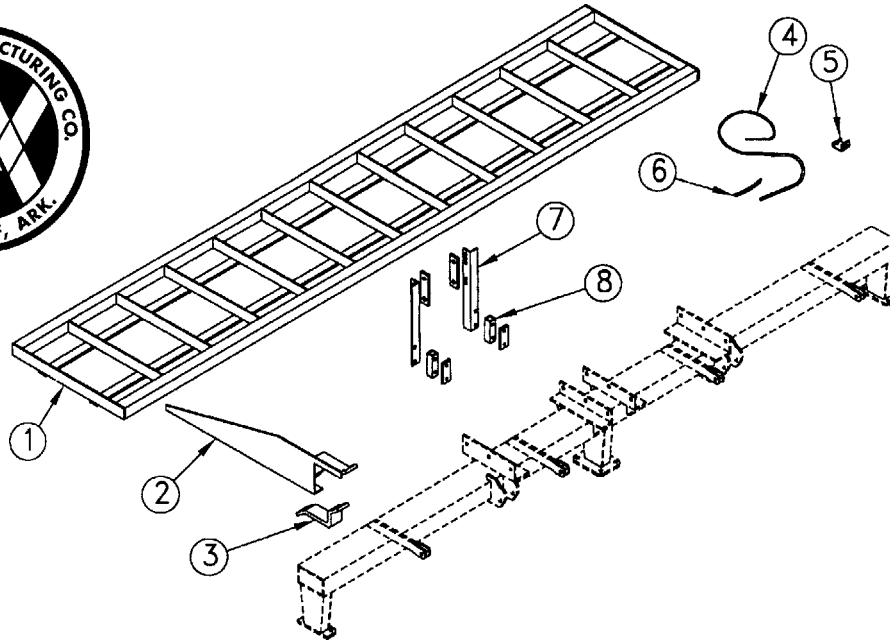

| Item No. | Part No. | Wt. Lbs. | Description | Qty. Req'd for 1 Machine |
|----------|----------|----------|--|--------------------------|
| 1 | 300826 | 250 | 13 Ft. Tine Frame -- 4ND | 1 |
| 2 | 300833 | 30 | Holder Bracket -- 4ND | 4 |
| - | 415108 | ½ | 1/2" U-Bolt x 2½" x 4" Leg - Grade 5 | 8 |
| - | 412008 | - | Hex Nut -- 1/2" - 13 - Gr 2 - Zinc | 16 |
| - | 413508 | - | Lock Washer -- 1/2" - Zinc | 16 |
| 3 | 407012 | 8 | Backing Clamp 4 x 7 Bar -- 3/4" | 4 |
| - | 411565 | ½ | Hex Bolt -- 5/8" x 3½" NC - Gr 5 - Zinc | 16 |
| - | 412010 | - | Hex Nut -- 5/8" - 11 - Gr 2 - Zinc | 16 |
| - | 413510 | - | Lock Washer -- 5/8" - Zinc | 16 |
| 4 | 471031 | 5 | Spring Tine Only | 24 |
| 5 | 471035 | ½ | Clamp Only for Balk Buster -- (1/2" x 2" Flat Bar) | 24 |
| - | 411546 | - | Hex Bolt -- 1/2" x 1¾" NC - Gr 5 - Zinc | 24 |
| - | 410008 | - | Lock Nut -- 1/2" NC - Zinc | 24 |
| 6 | 474052 | ½ | Rev Share -- 1/4" x 1¼" x 7" | 24 |
| - | 411826 | - | Plow Bolt -- 3/8" x 1½" - Elliptical Head | 24 |
| - | 412006 | - | Hex Nut -- 3/8" NC - 16 - Gr 2 - Zinc | 24 |
| - | 413506 | - | Lock Washer -- 3/8" - Zinc | 24 |
| 7 | 201739 | 4½ | Attaching Angle -- RH - 4ND | 1 |
| - | 200274 | 4½ | Attaching Angle -- LH - 4ND | 1 |
| - | 202100 | 1½ | Backing Clamp - 4ND.....(1/2" x 2" x 7") | 2 |
| - | 411565 | ½ | Hex Bolt -- 5/8" x 3½" NC - Gr 5 - Zinc | 4 |
| - | 412010 | - | Hex Nut -- 5/8" - 11 - Gr 2 - Zinc | 4 |
| - | 413510 | - | Lock Washer -- 5/8" - Zinc | 4 |
| 8 | 202462 | 1½ | Spacer Tube - 4ND | 2 |
| - | 200277 | 1 | Backing Clamp - 4ND.....(1/2" x 2" x 4-3/8") | 2 |
| - | 411200 | ½ | Hex Bolt -- 1/2" x 6" NC - Gr 2 - Zinc | 4 |
| - | 412008 | - | Hex Nut -- 1/2" - 13 - Gr 2 - Zinc | 4 |
| - | 413508 | - | Lock Washer -- 1/2" - Zinc | 4 |