

3 POINT HITCH FOR 7x7 BAR

CAT. II/III Standard
& Quick Hitch

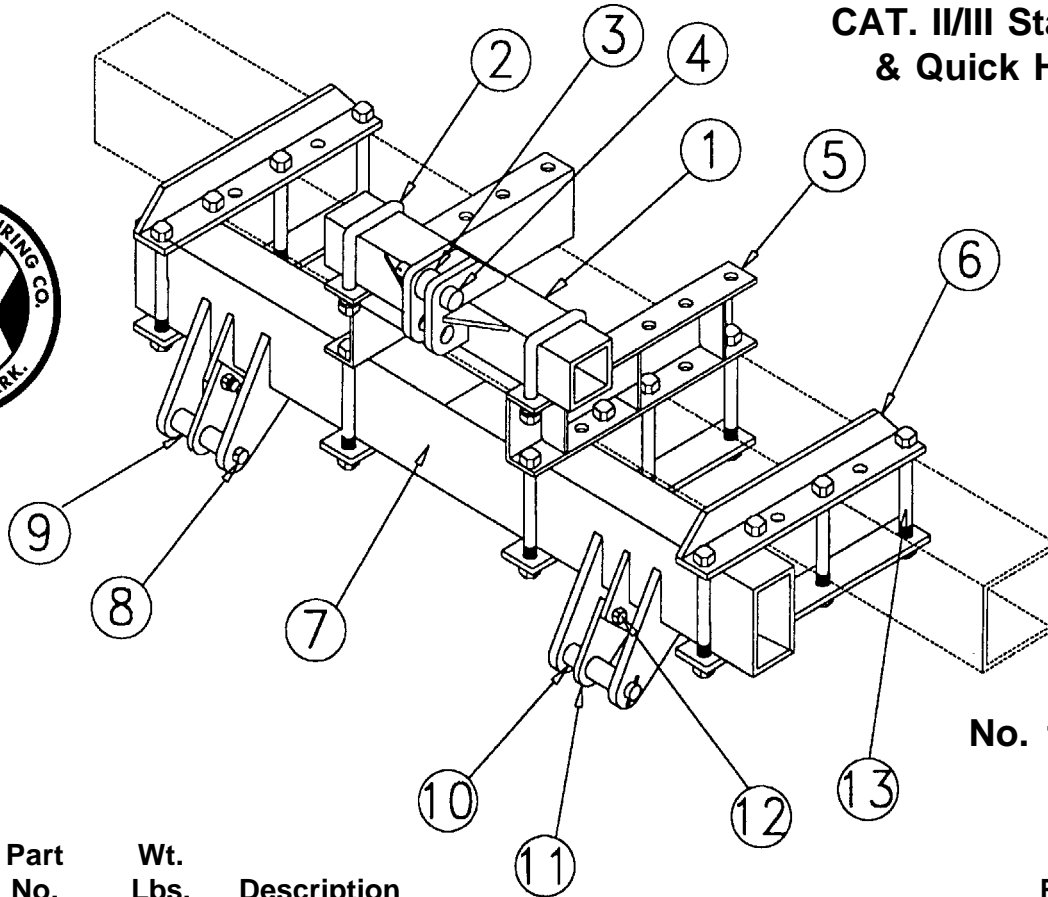

No. 1428

Item No.	Part No.	Wt. Lbs.	Description	Qty. Req'd.
1	300276	55	Mast Top -- 1428 Hitch	1
2	415018	2	7/8" Sq. U-Bolt x 4" x 6½" Leg	2
-	413514	-	Lock Washer -- 7/8" - Zinc	20
-	412014	-	Hex Nut -- 7/8" - 9 - Gr 2 - Zinc	20
3	201799	-	Cat III Bushing -- 1¼" OD x 2-1/8" Long	1
4	416666	2	Clevis Pin -- 1" x 4½" - Zinc	1
-	416309	-	Rue Ring Cotter Pin -- 1" - Zinc	3
5	301037	24½	Mast Side -- Hitch	2
6	201601	16	Angle Support - RH - Hitch	3
-	201602	16	Angle Support - LH - Hitch	3
7	301050	170	Pull Piece Bracket -- 3P728 Hitch (60")	1
8	201360	2½	Hitch Pin -- 1-1/8" x 9"	2
9	201666	-	Bushing -- 1½" OD x 1-1/8" ID x 3-1/8" Long	2
10	201665	-	Bushing -- 1-7/16" OD x 1-1/8" ID x 2" Long	2
11	201548	3	Center Pull Plate - Hitch	2
12	411214	¼	Hex Bolt -- 5/8 x 2" NC - Gr 2 - Zinc	4
-	413510	-	Lock Washer -- 5/8" - Zinc	4
-	412010	-	Hex Nut -- 5/8" - 11 - Gr 2 - Zinc	4
13	411294	1¾	Hex Bolt -- 7/8" x 10" NC - Gr 2 - Zinc	16