

STACKING TOOLBAR PARTS MANUALS

**Model Nos. 1265, 1267, 1266, 1268, 1270, 1271,1274,
1272, 1273, 1275, 1278**

Table of Contents

Click the Toolbar model number below for a
Parts Manual for each model.

1251 & 1252 - 8 Row 38" Planter & 8 Row 40"/42" Transplanter

- Pages 3 - 6

1265 & 1267 - 12 Row 30" Bedder & 12 Row 30" Cultivator

- Pages 7 - 11

1266- 12 Row 30" Planter

- Pages 12 - 16

1268 - 12 Row 36" Planter

- Pages 17 - 21

1270, 1271, 1274 - 12 Row 38"/40" & 16 Row 30" Planter

- Pages 22 - 27

1272 - 12 Row Top Leveling Toolbar

- Pages 28 - 31

1273, 1275 - 12 Row 38" Cultivator & 12 Row 40" Bedder

- Pages 32 - 37

1278 - 16 Row 30" Cultivator

- Pages 38 - 41



STACKER TOOLBAR TOP LEVELING MODEL

Model No. 1252 -- 8 @ 38" Row - Planter
Model No. 1253 -- 8 @ 40"/42" Row - Transplanter

CENTER SECTION

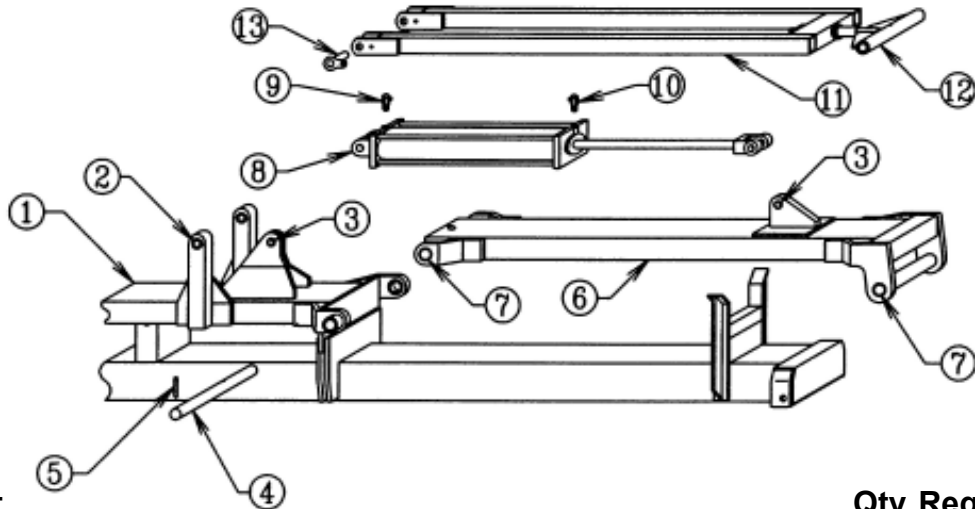

Item No.	Part No.	Wt. Lbs.	Description	Qty. Req'd	
				1252	1253
1	301897	740	Center Sect. – 38" Row Planter.....(153" Wide)	1	-
-	301902	823	Center Sect. – 40"/42" Row Transplanter....(167" Wide)	-	1
2	401084	¼	Form 1 Bushing -- 1½" OD x 1¼" ID x 1½" Long	4	4
3	401080	¼	Form 1 Bushing -- 1½" OD x 1¼" ID x 1" Long	4	4
4	203948	14¼	2" Pivot Pin x 16¼"	4	4
-	413124	-	Machine Washer -- 3" OD x 2" ID x 10 Ga.....(Not Illustrated) ...	8	8
5	416133	-	Roll Pin -- 1/2" x 3½" - Zinc.....	4	4
6	301894	206	Power Arm -- 38" Planter & 40/42" Transplanter	2	2
7	401118	½	Bushing -- 2.376" OD x 2.006" ID x 2" Long	8	8
-	450004	-	1/4" Drive-in Grease Fitting.....(Not Illustrated) ...	4	4
8	476524	110	Hydraulic Cylinder -- 5" x 24" (w/1¼" Pin).....	2	2
-	477056	-	Seal Kit -- 5" x 24" & 5" x 30" Lion Cyl - 2" Rod.....(Not Illustrated) ...	-	1
9	446188	¼	1/2" x 1/2" Swivel Orifice Elbow	2	2
10	446188	¼	1/2" x 1/2" Swivel Orifice Elbow	2	2
-	785092	½	3/8" Hydraulic Hose x 92".....(Not Illustrated) ...	2	-
-	785103	½	3/8" Hydraulic Hose x 103".....(Not Illustrated) ...	2	-
-	785099		3/8" Hydraulic Hose x 99".....(Not Illustrated) ...	-	2
-	785110		3/8" Hydraulic Hose x 110".....(Not Illustrated) ...	-	2
11	301821	59	Leveling Arm -- For 1½" Dia. Rod	2	2
12	301819	19¾	Leveling Arm End with Lock Nut – 1½" Dia. Rod	2	2
-	410032	1	Lock Nut -- 1½" NF Top Lock - Zinc.....(Not Illustrated) ...	2	2
-	413024	¼	Flat Washer -- 1½" - Zinc.....(Not Illustrated) ...	2	2
-	413120	-	Machine Washer -- 2¼" OD x 1½" ID x 10 Ga.....(Not Illustrated) ...	2	2
-	450004	-	1/4" Drive-in Grease Fitting.....(Not Illustrated) ...	2	2
-	401095	-	Form 1 Bushing -- 1-7/8" OD x 1½" ID x 1" Long.(Not Illustrated) ...	4	4
13	301824	1¾	Small Pin -- 1-1/4" x 2½" Stacker Bar	4	4
-	411545	-	Hex Bolt -- 1/2" x 1½" NC - Gr 5 - Zinc.....(Not Illustrated) ...	4	4
-	413508	-	Lock Washer -- 1/2" - Zinc.....(Not Illustrated) ...	4	4
-	413008	-	Flat Washer -- 1/2" - Zinc.....(Not Illustrated) ...	4	4

WING

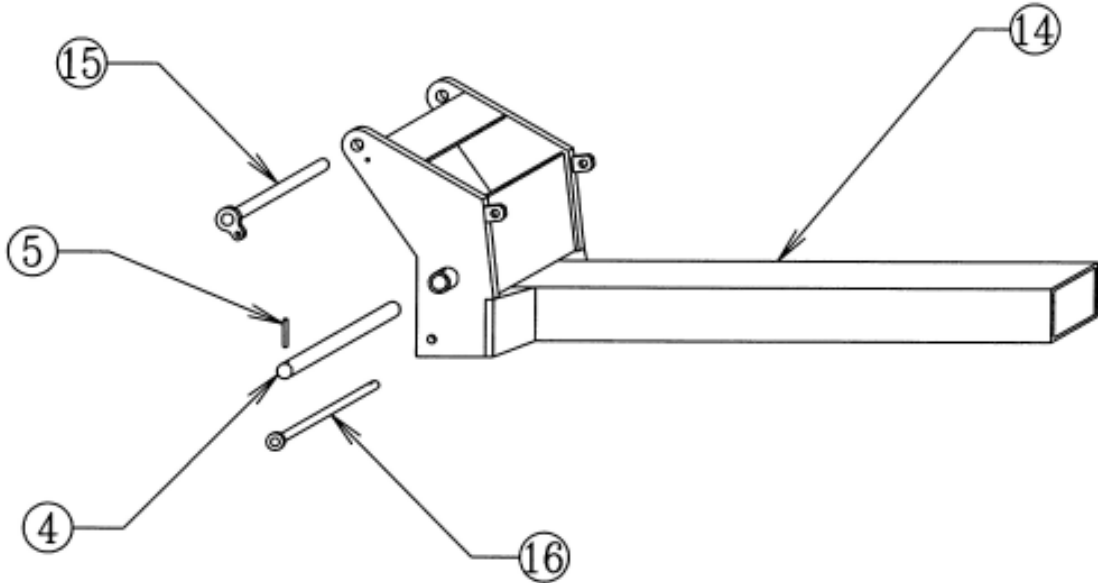

<u>Item No.</u>	<u>Part No.</u>	<u>Wt. Lbs.</u>	<u>Description</u>	<u>Qty. Req'd</u>
4	203948	14¼	2" Pivot Pin x 16¼"	4
-	413124	-	Machine Washer -- 3" OD x 2" ID x 10 Ga.....(Not Illustrated) ...	8
5	416133	-	Roll Pin -- 1/2" x 3½" - Zinc.....	4
14	301898	352	Wing for 38" Row Planter	2
-	301903	374	Wing for 40" & 42" Row Transplanter (84").....(Not Illustrated) ...	2
15	301825	8	Top Pin -- Top Leveling Stacker	2
-	411545	-	Hex Bolt -- 1/2" x 1½" NC - Gr 5 - Zinc.....(Not Illustrated) ..	2
-	413508	-	Lock Washer -- 1/2" - Zinc.....(Not Illustrated) ...	2
-	413008	-	Flat Washer -- 1/2" - Zinc.....(Not Illustrated) ..	2
16	301826	3½	Wing Lock Pin -- Top Leveling Stacker	2
-	416204	-	Klik Pin -- 1/4" - Zinc.....(Not Illustrated) ...	2

USE ONLY



W & A REPLACEMENT PARTS

HITCH ASSEMBLY

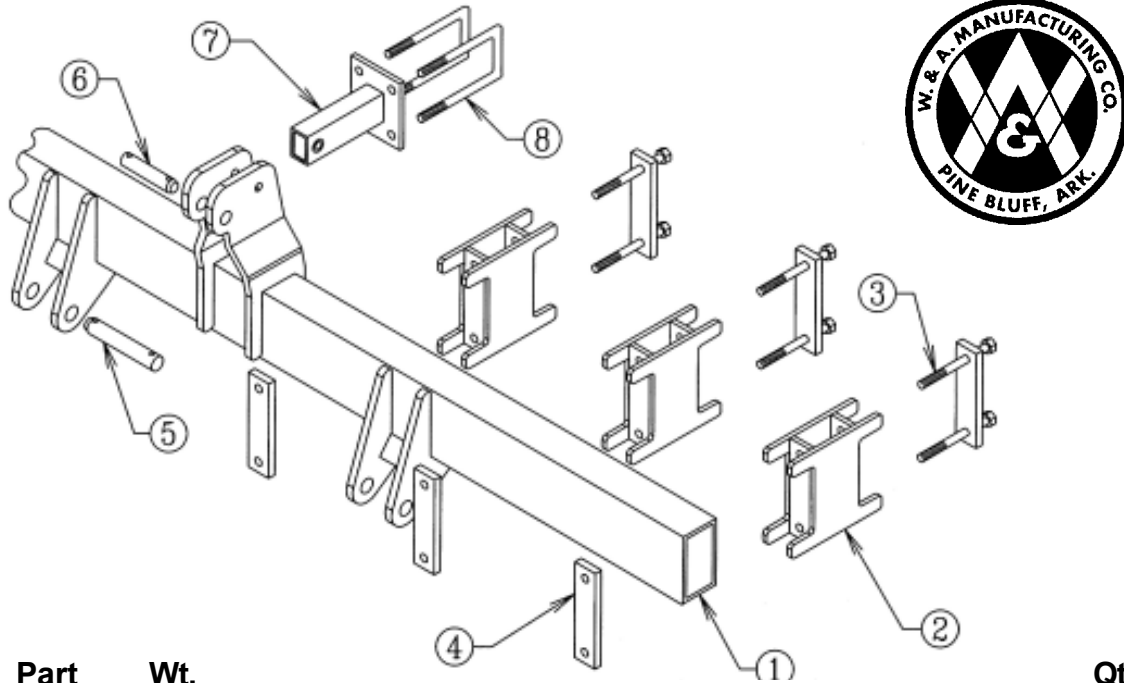

Item No.	Part No.	Wt. Lbs.	Description	Qty. Req'd
1	301904	282	Stacker Hitch – 8 Row.....(102").....	1
2	302014	25	5" Spacer Block -- Top Leveling Stacker	6
3	203960	5	Backing Plate -- Top Leveling Stacker	6
-	411604	1¼	Hex Bolt -- 3/4" x 10" NC - Gr 5 - Zinc.....	12
-	412012	-	Hex Nut -- 3/4" - 10 - Gr 2 - Zinc.....(Not Illustrated) ..	12
-	413512	-	Lock Washer -- 3/4" - Zinc.....(Not Illustrated) ..	12
4	203960	5	Backing Plate -- Top Leveling Stacker	6
-	411598	½	Hex Bolt -- 3/4" x 6½" NC - Gr 5 - Zinc.....(Not Illustrated) ..	12
-	412012	-	Hex Nut -- 3/4" - 10 - Gr 2 - Zinc.....(Not Illustrated) ..	12
-	413512	-	Lock Washer -- 3/4" - Zinc.....(Not Illustrated) ..	12
5	200876	3¾	Hardened Pull Pin -- 1-7/16" x 8-3/8" - Zinc	2
-	416207	-	Klik Pin -- 7/16" - Zinc.....(Not Illustrated) ..	2
-	416133	-	Roll Pin -- 1/2" x 3½" - Zinc.....(Not Illustrated) ..	2
6	200853	2	Hardened Top Link Pin -- 1¼" x 5-15/16" - Zinc	1
-	416207	-	Klik Pin -- 7/16" - Zinc.....(Not Illustrated) ..	1
-	416120	-	Roll Pin -- 3/8" x 2" - Zinc.....(Not Illustrated) ..	1
7	301906	10¾	Top Connector – 8 Row @ 38" Only.....(Not Illustrated) ..	1
-	301836	11	Top Connector -- 5" Spacer - Hitch Assm	1
-	411822	¾	Hex Bolt -- 3/4" x 5" NC - Gr 8 - Zinc.....(Not Illustrated) ..	1
-	412012	-	Hex Nut -- 3/4" - 10 - Gr 2 - Zinc.....(Not Illustrated) ..	1
-	413512	-	Lock Washer -- 3/4" - Zinc.....(Not Illustrated) ..	1
8	415006	2	3/4" Sq. U-Bolt x 4" x 8½" Leg - Gr 5 - Zinc	2
-	412012	-	Hex Nut -- 3/4" - 10 - Gr 2 - Zinc.....(Not Illustrated) ..	4
-	413512	-	Lock Washer -- 3/4" - Zinc.....(Not Illustrated) ..	4

TOP LEVELING STACKER TOOLBAR

**Model No. 1265 Twelve @ 30" Row Bedder
Model No. 1267 Twelve @ 30" Row Cultivator**

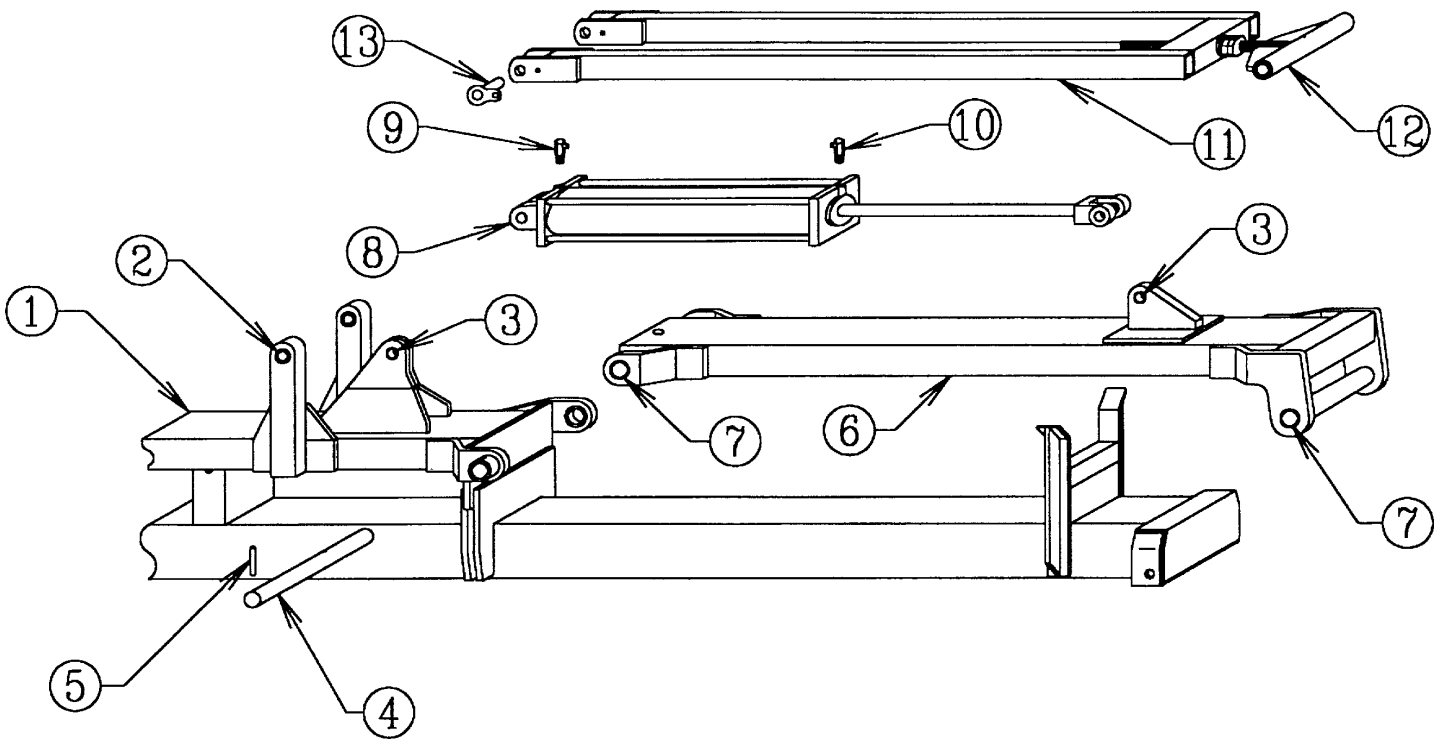

CENTER SECTION

<u>Item No.</u>	<u>Part No.</u>	<u>Wt. Lbs.</u>	<u>Description</u>	<u>Qty. Req'd</u>
1	301908	981	Center Section – 12 @ 30" Bedder & Cult....(200" Wide) ...	1
2	401084	¼	Form 1 Bushing -- 1-1/2" OD x 1-1/4" ID x 1-1/2" Long.....	4
3	401080	¼	Form 1 Bushing -- 1-1/2" OD x 1-1/4" ID x 1" Long	4
4	203948	14¼	2" Pivot Pin x 16-1/4"	4
-	413124	-	Machine Washer -- 3" OD x 2" ID x 10 Ga	8
5	416133	-	Roll Pin -- 1/2" x 3-1/2" - Zinc	4
6	301894	206	Power Arm	2
7	401118	½	Bushing -- 2.376" OD x 2.006" ID x 2" Long	8
-	450004	-	1/4" Drive-in Grease Fitting	4
8	476524	110	Hydraulic Cylinder -- 5" x 24" (w/1-1/4" Pin)	2
-	477056	-	Seal Kit -- 5" x 24" & 5" x 30" Lion Cyl (2" Rod)	-
9	446188	¼	1/2" x 1/2" Swivel Orifice Elbow	2
10	444024	¼	Swivel, ½" x ½"	2
-	785115	½	3/8" Hydraulic Hose x 115"	2
-	785126	½	3/8" Hydraulic Hose x 126"	2
11	301821	59	Leveling Arm (For 1½" Dia. Rod)	2
12	301819	19¾	Leveling Arm End – 1½" Dia.Rod	2
-	410032	1	Lock Nut -- 1-1/2" NF Nylon Insert - Zinc	2
-	412024	¾	Hex Nut -- 1-1/2" - 6 - Gr 2 - Zinc	2
-	413120	-	Machine Washer -- 1-1/2" ID x 10 Ga	2
-	450004	-	1/4" Drive-in Grease Fitting	2
-	401095	-	Form 1 Bushing -- 1-7/8" OD x 1-1/2" ID x 1"Long	4
13	301824	1¾	Small Pin -- 1-1/4" x 2-1/2" Stacker Bar	4
-	411545	-	Hex Bolt -- 1/2" x 1-1/2" NC - Gr 5 - Zinc	4
-	413508	-	Lock Washer -- 1/2" - Zinc	4

WING

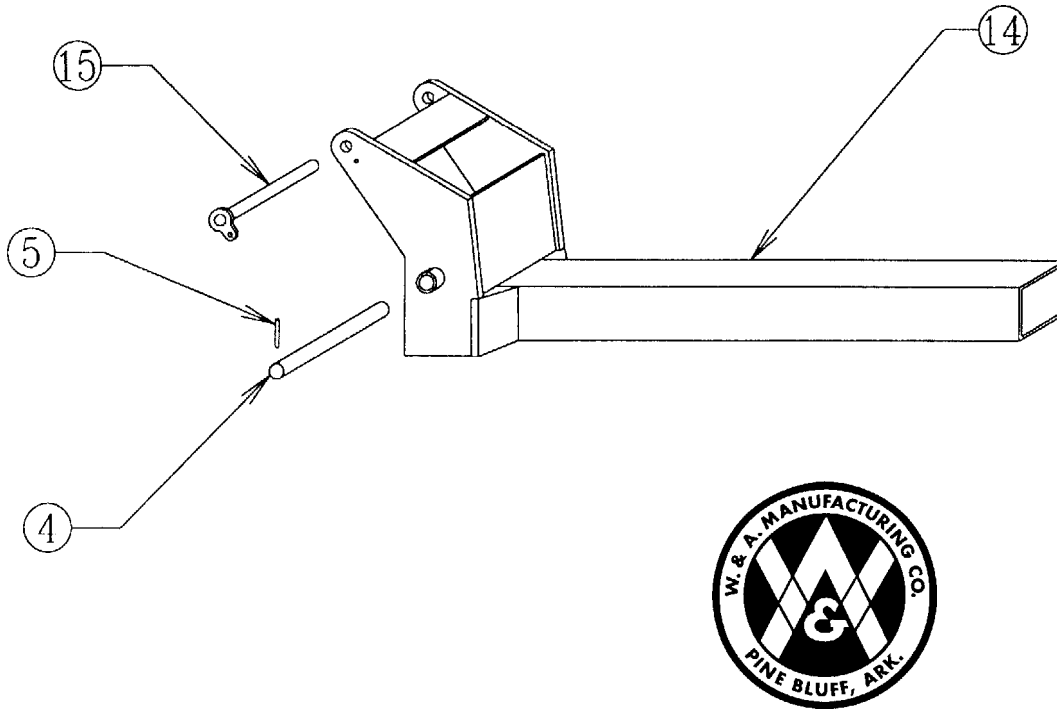

<u>Item No.</u>	<u>Part No.</u>	<u>Wt. Lbs.</u>	<u>Description</u>	<u>Qty. Req'd</u>
4	203948	14¼	2" Pivot Pin x 16-1/4"	4
-	413124	-	Machine Washer -- 3" OD x 2" ID x 10 Ga	8
5	416133	-	Roll Pin -- 1/2" x 3-1/2" - Zinc	4
14	301909	374	Wing for 12 @ 30" Row Bedder & Cultivator.....(88")	2
15	301825	8	Top Pin -- Top Leveling Stacker	2
-	411545	-	Hex Bolt -- 1/2" x 1-1/2" NC - Gr 5 - Zinc	2
-	413508	-	Lock Washer -- 1/2" - Zinc	2
16	301826	3½	Wing Lock Pin -- Top Leveling Stacker	2
-	416204	-	1/4" Klik Pin - Zinc	2

HITCH ASSEMBLY

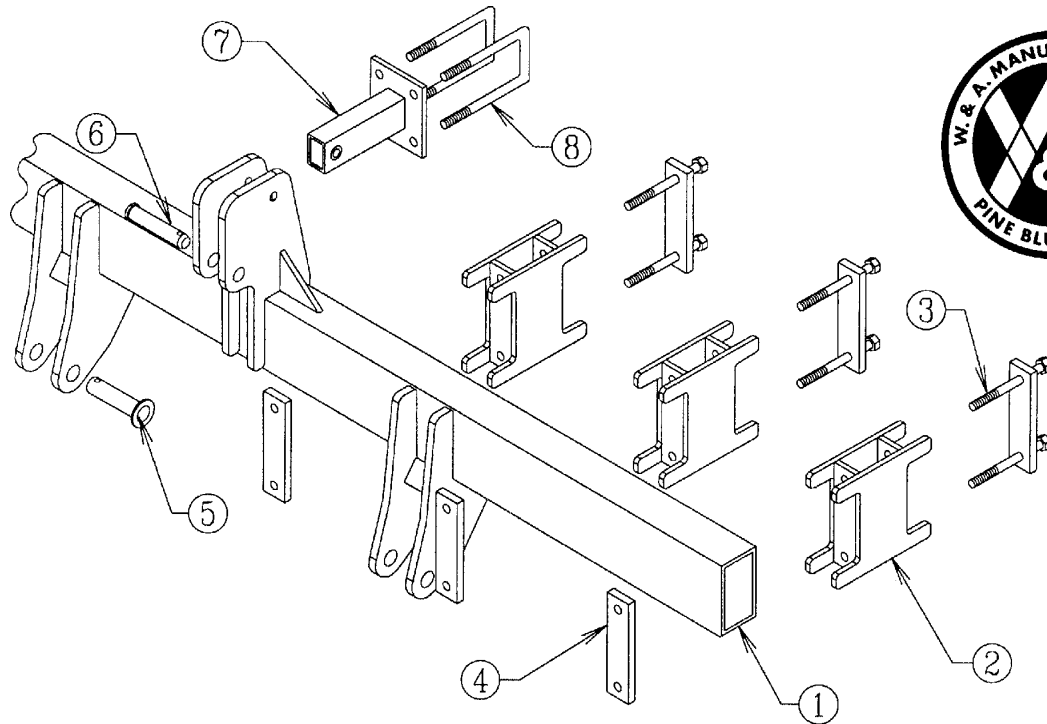

<u>Item No.</u>	<u>Part No.</u>	<u>Wt. Lbs.</u>	<u>Description</u>	<u>Qty. Bedder</u>	<u>Req'd Cult.</u>
1	301835	411	Stacker Cultivator Hitch – 12 Row @ 30" ..(140")	-	1
-	301833	366	Wide Hitch -- Bedder.....(140")	1	-
2	302014	25	5" Spacer Block	-	6
-	301831	32¼	7½" Spacer Block	6	-
3	411604	1¼	Hex Bolt -- 3/4" x 10" NC - Gr 5 - Zinc	12	12
-	412012	-	Hex Nut -- 3/4" - 10 - Gr 2 - Zinc	12	12
-	413512	-	Lock Washer -- 3/4" - Zinc.....	12	12
4	203960	5	Backing Plate	12	12
-	411598	½	Hex Bolt -- 3/4" x 6-1/2" NC - Gr 5 - Zinc	12	12
-	412012	-	Hex Nut -- 3/4" - 10 - Gr 2 - Zinc	12	12
-	413512	-	Lock Washer -- 3/4" - Zinc.....	12	12
5	300837	3	Pull Pin -- 1-7/16" x 6"	2	2
-	416207	-	7/16" Klik Pin - Zinc	3	3
6	416698	2	1-1/4" Top Link Pin - Zinc	1	1
-	416207	-	7/16" Klik Pin - Zinc	1	1
7	301834	12¾	Top Connector -- 7½" Spacer Block	1	-
-	301836	11	Top Connector -- 5" Spacer Blocks.....	-	1
-	411594	¾	Hex Bolt -- 3/4" x 5" NC - Gr 5 - Zinc	1	1
-	412012	-	Hex Nut -- 3/4" - 10 - Gr 2 - Zinc	1	1
-	413512	-	Lock Washer -- 3/4" - Zinc.....	1	1
8	415006	2	3/4" Sq. U-Bolt x 4" x 8-1/2" Leg	2	2
-	412012	-	Hex Nut -- 3/4" - 10 - Gr 2 - Zinc	4	4
-	413512	-	Lock Washer -- 3/4" - Zinc.....	4	4

12 ROW 30" TOP LEVELING PLANTER STACKER TOOLBAR

Model No. 1266

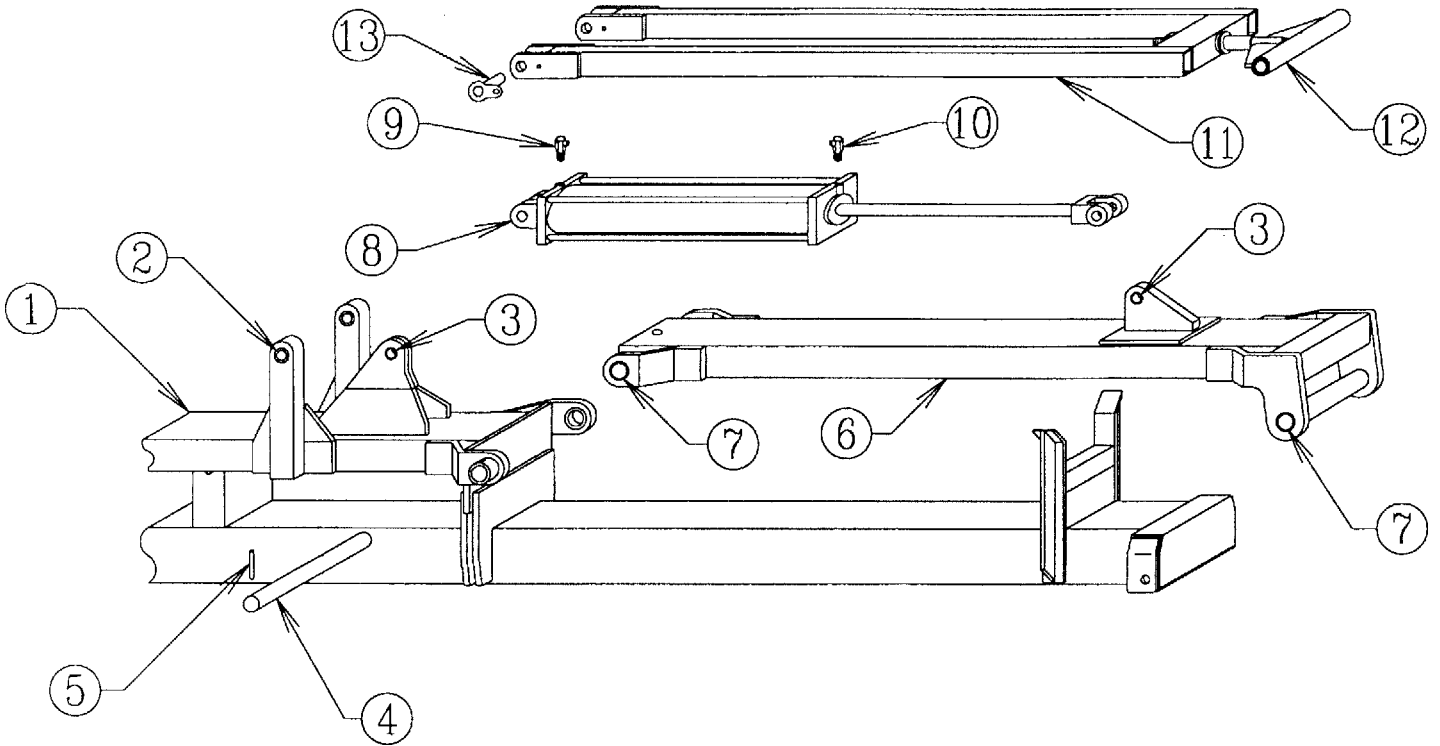

CENTER SECTION

<u>Item No.</u>	<u>Part No.</u>	<u>Wt. Lbs.</u>	<u>Description</u>	<u>Qty. Req'd</u>
1	301899	876	Center Sect. – 12 Row @ 30" Planter.....(178" Wide)	1
2	401084	¼	Form 1 Bushing -- 1-1/2" OD x 1-1/4" ID x 1-1/2" Long.....	4
3	401080	¼	Form 1 Bushing -- 1-1/2" OD x 1-1/4" ID x 1" Long	4
4	203948	14¼	2" Pivot Pin x 16-1/4"	4
-	413124	-	Machine Washer -- 3" OD x 2" ID x 10 Ga	8
5	416133	-	Roll Pin -- 1/2" x 3-1/2" - Zinc	4
6	301894	206	Power Arm	2
7	401118	½	Bushing -- 2.376" OD x 2.006" ID x 2" Long	8
-	450004	-	1/4" Drive-in Grease Fitting	4
8	476524	110	Hydraulic Cylinder -- 5" x 24" (w/1-1/4" Pin)	2
-	477056	-	Seal Kit -- 5" x 24" & 5" x 30" Lion Cyl (2" Rod)	-
9	446188	¼	1/2" x 1/2" Swivel Orifice Elbow	2
10	444024	¼	Swivel, ½" x ½"	2
-	785104	½	3/8" Hydraulic Hose x 104"	2
-	785110	½	3/8" Hydraulic Hose x 110"	2
11	301821	59	Leveling Arm (For 1½" Dia. Rod)	2
12	301819	19¾	Leveling Arm End – 1½" Dia.Rod	2
-	410032	1	Lock Nut -- 1-1/2" NF Nylon Insert - Zinc	2
-	413024	¼	Flat Washer -- 1-1/2" - Zinc	2
-	413120	-	Machine Washer -- 1-1/2" ID x 10 Ga	2
-	450004	-	1/4" Drive-in Grease Fitting	2
-	401095	-	Form 1 Bushing -- 1-7/8" OD x 1-1/2" ID x 1"Long	4
13	301824	1¾	Small Pin -- 1-1/4" x 2-1/2" Stacker Bar	4
-	411545	-	Hex Bolt -- 1/2" x 1-1/2" NC - Gr 5 - Zinc	4
-	413508	-	Lock Washer -- 1/2" - Zinc	4

WING

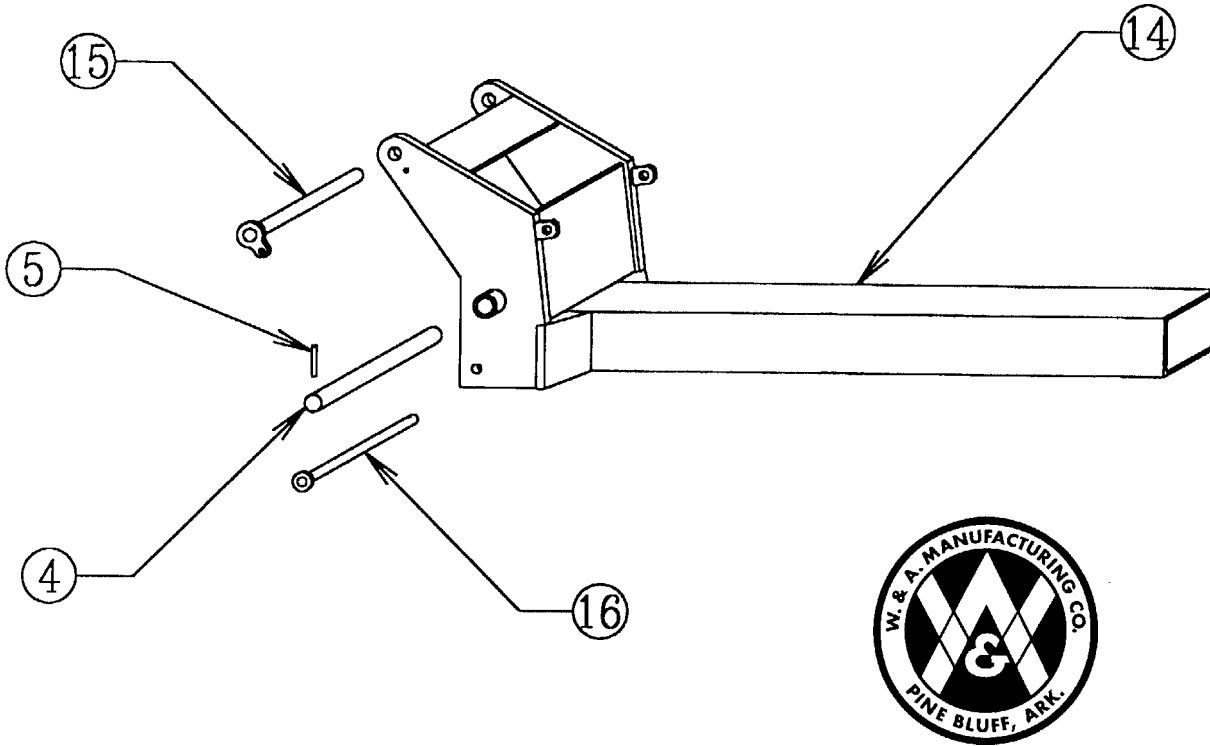

<u>Item No.</u>	<u>Part No.</u>	<u>Wt. Lbs.</u>	<u>Description</u>	<u>Qty. Req'd</u>
4	203948	14¼	2" Pivot Pin x 16-1/4"	4
-	413124	-	Machine Washer -- 3" OD x 2" ID x 10 Ga	8
5	416133	-	Roll Pin -- 1/2" x 3-1/2" - Zinc	4
14	301900	379	Wing for 12 Row @ 30" Planter	2
15	301825	8	Top Pin -- Top Leveling Stacker	2
-	411545	-	Hex Bolt -- 1/2" x 1-1/2" NC - Gr 5 - Zinc	2
-	413508	-	Lock Washer -- 1/2" - Zinc	2
16	301826	3½	Wing Lock Pin -- Top Leveling Stacker	2
-	416204	-	1/4" Klik Pin - Zinc	2

HITCH ASSEMBLY

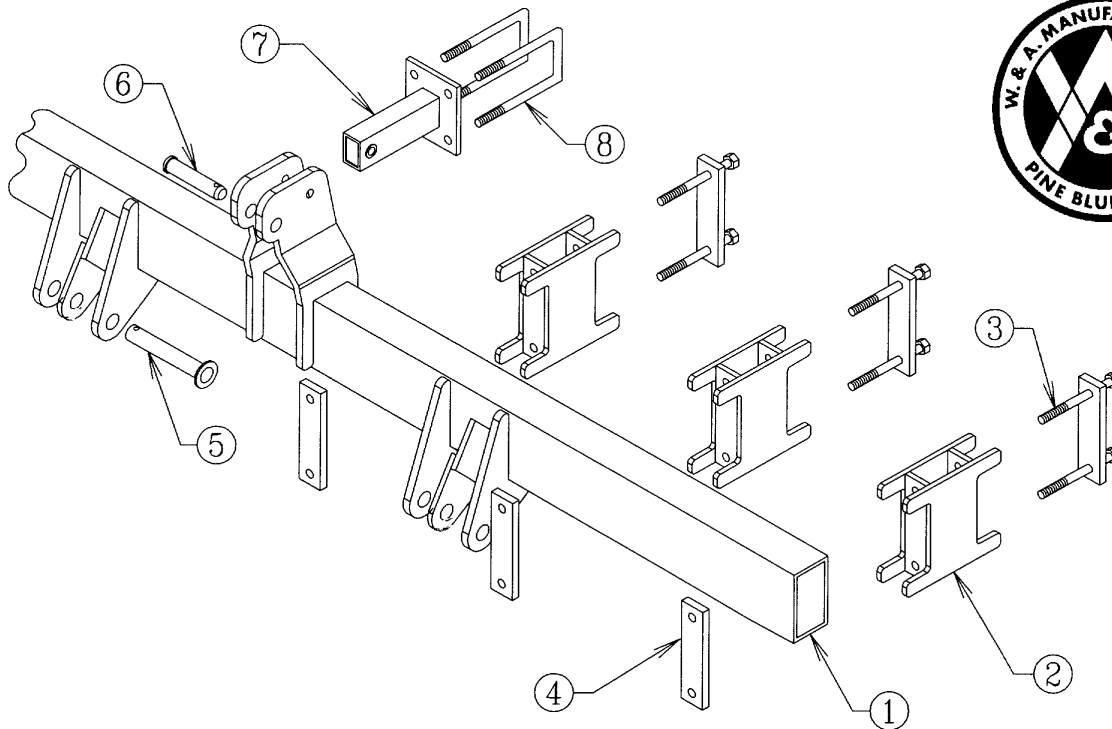

<u>Item No.</u>	<u>Part No.</u>	<u>Wt. Lbs.</u>	<u>Description</u>	<u>Qty. Req'd</u>
1	301832	369	Wide Stacker Hitch -- Cat III & III Narrow (140")	1
2	302014	25	5" Spacer Block	6
3	411604	1¼	Hex Bolt -- 3/4" x 10" NC - Gr 5 - Zinc	12
-	412012	-	Hex Nut -- 3/4" - 10 - Gr 2 - Zinc	12
-	413512	-	Lock Washer -- 3/4" - Zinc	12
4	203960	5	Backing Plate	12
-	411598	½	Hex Bolt -- 3/4" x 6-1/2" NC - Gr 5 - Zinc	12
-	412012	-	Hex Nut -- 3/4" - 10 - Gr 2 - Zinc	12
-	413512	-	Lock Washer -- 3/4" - Zinc	12
5	300841	4	Pull Pin -- 1-7/16" x 9"	2
-	416207	-	7/16" Klik Pin - Zinc	3
6	416698	2	1-1/4" Top Link Pin - Zinc	1
-	416207	-	7/16" Klik Pin - Zinc	1
7	301906	10¾	Top Connector -- 8 Row @ 38" Only.....(Not Illustrated)	1
-	301836	11	Top Connector -- 5" Spacer Blocks	1
-	411594	¾	Hex Bolt -- 3/4" x 5" NC - Gr 5 - Zinc	1
-	412012	-	Hex Nut -- 3/4" - 10 - Gr 2 - Zinc	1
-	413512	-	Lock Washer -- 3/4" - Zinc	1
8	415006	2	3/4" Sq. U-Bolt x 4" x 8-1/2" Leg	2
-	412012	-	Hex Nut -- 3/4" - 10 - Gr 2 - Zinc	4
-	413512	-	Lock Washer -- 3/4" - Zinc	4

12 ROW 36” PLANTER STACKER TOOLBAR

Model No. 1268

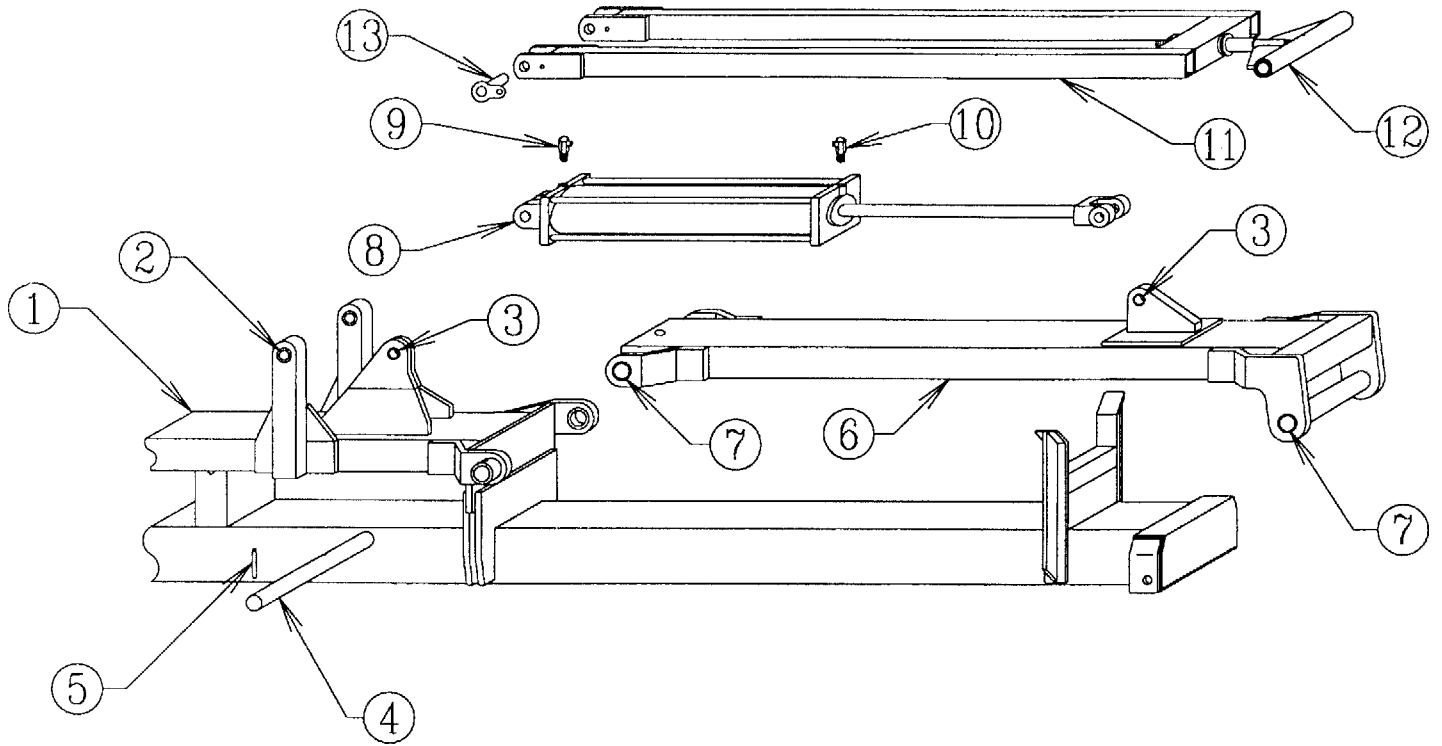

CENTER SECTION

<u>Item No.</u>	<u>Part No.</u>	<u>Wt. Lbs.</u>	<u>Description</u>	<u>Qty. Req'd</u>
1	301917	961	Center Sect. – 12 Row @ 36" Planter.....	1
2	401084	¼	Form 1 Bushing -- 1-1/2" OD x 1-1/4" ID x 1-1/2" Long.....	4
3	401080	¼	Form 1 Bushing -- 1-1/2" OD x 1-1/4" ID x 1" Long.....	4
4	203948	14¼	2" Pivot Pin x 16-1/4"	4
-	413124	-	Machine Washer -- 3" OD x 2" ID x 10 Ga.....	8
5	416133	-	Roll Pin -- 1/2" x 3-1/2" - Zinc	4
6	301916	249	Power Arm.....	2
7	401118	½	Bushing -- 2.376" OD x 2.006" ID x 2" Long	8
-	450004	-	1/4" Drive-in Grease Fitting	4
8	476524	110	Hydraulic Cylinder -- 5" x 24" (w/1-1/4" Pin)	2
-	477056	-	Seal Kit -- 5" x 24" & 5" x 30" Lion Cyl (2" Rod)	-
9	446188	¼	1/2" x 1/2" Swivel Orifice Elbow	2
10	444024	¼	Swivel, ½" x ½"	2
-	785102	½	3/8" Hydraulic Hose x 102"	2
-	785113	½	3/8" Hydraulic Hose x 113"	2
11	301919	78	Leveling Arm	2
12	301819	19¾	Leveling Arm End – 1½" Dia.Rod	2
-	410032	1	Lock Nut -- 1-1/2" NF Nylon Insert - Zinc	2
-	413024	¼	Flat Washer -- 1-1/2" - Zinc	2
-	413120	-	Machine Washer -- 1-1/2" ID x 10 Ga.....	2
-	450004	-	1/4" Drive-in Grease Fitting	2
-	401095	-	Form 1 Bushing -- 1-7/8" OD x 1-1/2" ID x 1"Long	4
13	301824	1¾	Small Pin -- 1-1/4" x 2-1/2" Stacker Bar	4
-	411545	-	Hex Bolt -- 1/2" x 1-1/2" NC - Gr 5 - Zinc	4
-	413508	-	Lock Washer -- 1/2" - Zinc	4

WING

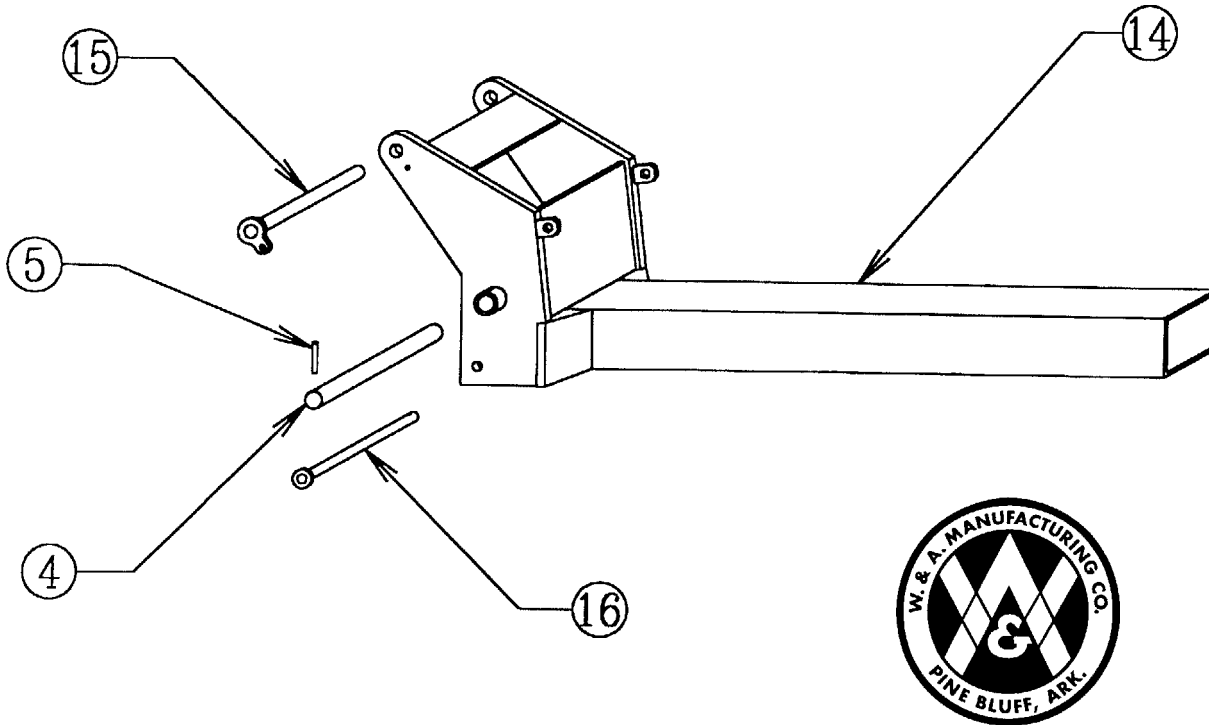

<u>Item No.</u>	<u>Part No.</u>	<u>Wt. Lbs.</u>	<u>Description</u>	<u>Qty. Req'd</u>
4	203948	14¼	2" Pivot Pin x 16-1/4"	4
-	413124	-	Machine Washer -- 3" OD x 2" ID x 10 Ga	8
5	416133	-	Roll Pin -- 1/2" x 3-1/2" - Zinc	4
14	301918	432	Wing for 12 Row @ 36" Planter.....(Tube 101")	2
15	301825	8	Top Pin -- Top Leveling Stacker	2
-	411545	-	Hex Bolt -- 1/2" x 1-1/2" NC - Gr 5 - Zinc	2
-	413508	-	Lock Washer -- 1/2" - Zinc	2
16	301826	3½	Wing Lock Pin -- Top Leveling Stacker	2
-	416204	-	1/4" Klik Pin - Zinc	2

HITCH ASSEMBLY

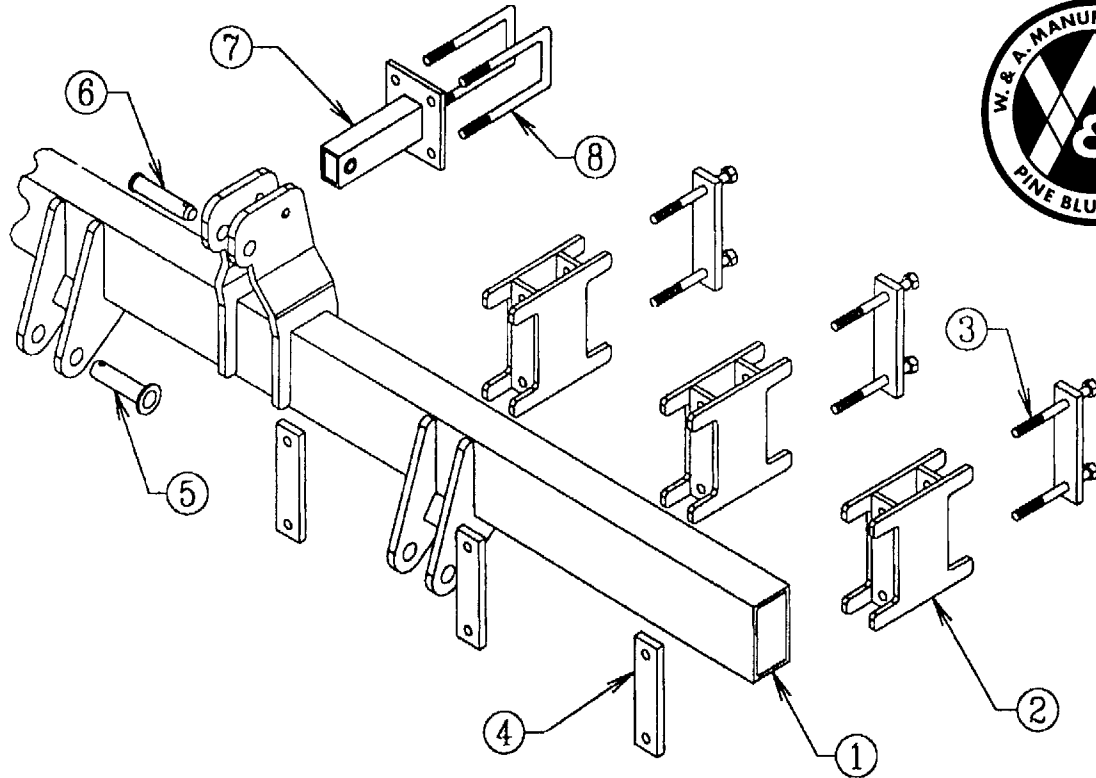

<u>Item No.</u>	<u>Part No.</u>	<u>Wt. Lbs.</u>	<u>Description</u>	<u>Qty. Req'd</u>
1	301833	361	Stacker Hitch – 12 Row	1
2	302014	25	5" Spacer Block	6
3	411604	1¼	Hex Bolt -- 3/4" x 10" NC - Gr 5 - Zinc	12
-	412012	-	Hex Nut -- 3/4" - 10 - Gr 2 - Zinc	12
-	413512	-	Lock Washer -- 3/4" - Zinc	12
4	203960	5	Backing Plate	12
-	411598	½	Hex Bolt -- 3/4" x 6-1/2" NC - Gr 5 - Zinc	12
-	412012	-	Hex Nut -- 3/4" - 10 - Gr 2 - Zinc	12
-	413512	-	Lock Washer -- 3/4" - Zinc	12
5	300837	3	Pull Pin -- 1-7/16" x 6"	2
-	416207	-	7/16" Klik Pin - Zinc	2
6	416698	2	1-1/4" Top Link Pin - Zinc	1
-	416207	-	7/16" Klik Pin - Zinc	1
7	301836	11	Top Connector -- 5" Spacer Blocks	1
-	411594	¾	Hex Bolt -- 3/4" x 5" NC - Gr 5 - Zinc	1
-	412012	-	Hex Nut -- 3/4" - 10 - Gr 2 - Zinc	1
-	413512	-	Lock Washer -- 3/4" - Zinc	1
8	415006	2	3/4" Sq. U-Bolt x 4" x 8-1/2" Leg	2
-	412012	-	Hex Nut -- 3/4" - 10 - Gr 2 - Zinc	4
-	413512	-	Lock Washer -- 3/4" - Zinc	4

STACKER TOOLBAR TOP LEVELING MODEL

Model No. 1270 -- 12 @ 38" Row - Planter
Model No. 1271 -- 12 @ 40" Row - Planter
Model No. 1274 -- 16 @ 30" Row - Planter

CENTER SECTION

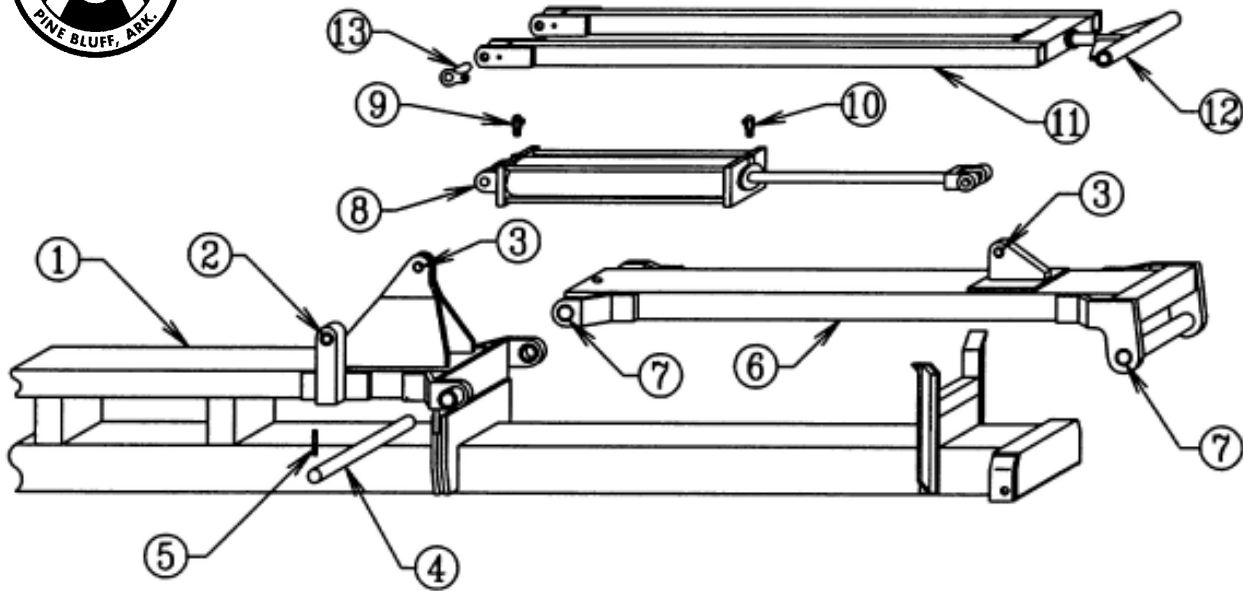

Item No.	Part No.	Wt. Lbs.	Description	Qty. Req'd		
				1270	1271	1274
1	301814	1201	Center Section – 38" Row Planter Bar	1	-	-
-	301814	1201	Center Section – 40" Row Planter Bar	-	1	-
-	301823	1220	Center Section – 30" Row Planter Bar.....(Not Illustrated) ...	-	-	1
2	401084	¼	Form 1 Bushing -- 1½" OD x 1¼" ID x 1½" Long	4	4	4
3	401080	¼	Form 1 Bushing -- 1½" OD x 1¼" ID x 1" Long	4	4	4
4	203948	14¼	2" Pivot Pin x 16¼"	4	4	4
-	413124	-	Machine Washer -- 3" OD x 2" ID x 10 Ga.....(Not Illustrated) ...	8	8	8
5	416133	-	Roll Pin -- 1/2" x 3½" - Zinc	4	4	4
6	301802	265	Power Arm -- Top Leveling Stacker	2	2	2
7	401118	½	Bushing -- 2.376" OD x 2.006" ID x 2" Long	8	8	8
-	450004	-	1/4" Drive-in Grease Fitting.....(Not Illustrated) ...	4	4	4
8	476029	126	Hydraulic Cylinder -- 5" x 30" (w/Pins)	2	2	2
-	477056	-	Seal Kit -- 5" x 24" & 5" x 30" Lion Cyl - 2" Rod.....(N/I) ...	-	-	-
9	446188	¼	1/2" x 1/2" Swivel Orifice Elbow	2	2	2

CENTER SECTION (Continued)

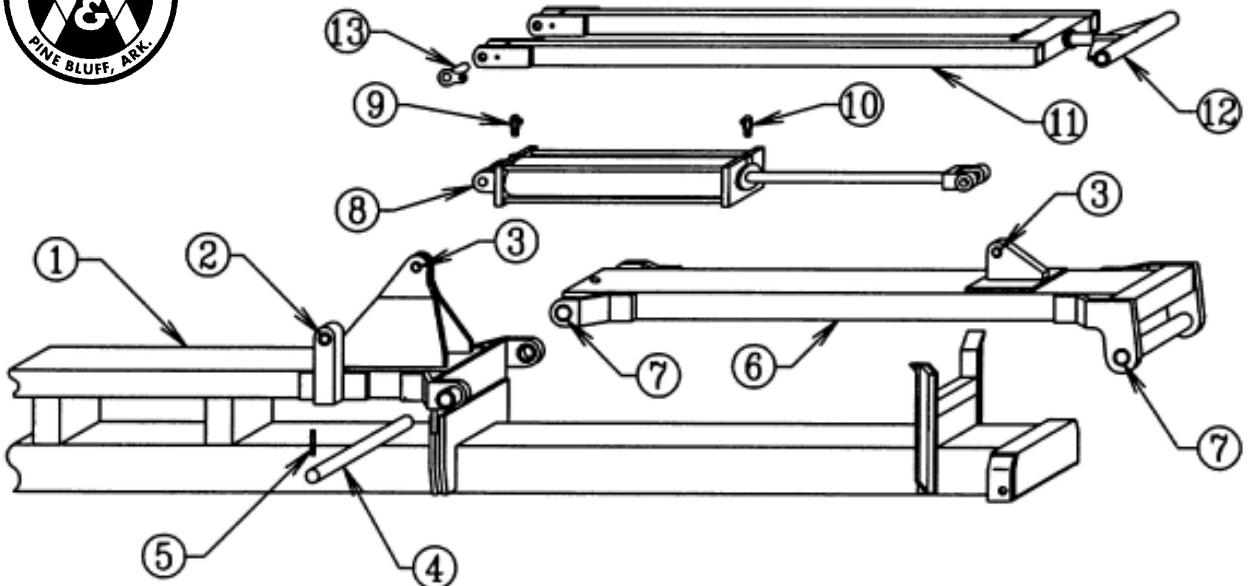

Item No.	Part No.	Wt. Lbs.	Description	Qty. Req'd		
				1270	1271	1274
10	446188	1/4	1/2" x 1/2" Swivel Orifice Elbow	2	2	-
-	785103	1/2	3/8" Hydraulic Hose x 103".....(Not Illustrated) ...	2	-	-
-	785120	1/2	3/8" Hydraulic Hose x 120".....(Not Illustrated) ...	2	2	2
-	785138	3/4	3/8" Hydraulic Hose x 138".....(Not Illustrated) ...	-	2	2
11	301820	88	Leveling Arm -- For 1 1/2" Dia. Rod	2	2	2
12	301819	19 3/4	Leveling Arm End with Lock Nut -- 1 1/2" Dia. Rod	2	2	2
-	410032	1	Lock Nut -- 1 1/2" NF Top Lock - Zinc.....(Not Illustrated) ...	2	2	2
-	413024	1/4	Flat Washer -- 1 1/2" - Zinc.....(Not Illustrated) ...	2	2	2
-	413120	-	Machine Washer -- 1 1/2" ID x 10 Ga.....(Not Illustrated) ...	2	2	2
-	450004	-	1/4" Drive-in Grease Fitting.....(Not Illustrated) ...	2	2	2
-	401095	-	Form 1 Bushing -- 1-7/8" OD x 1 1/2" ID x 1" Long.....(N/I) ...	4	4	4
13	301824	1 3/4	Small Pin -- 1 1/4" x 2 1/2" Stacker Bar	4	4	4
-	411545	-	Hex Bolt -- 1/2" x 1 1/2" NC - Gr 5 - Zinc.....(Not Illustrated) ...	4	4	4
-	413508	-	Lock Washer -- 1/2" - Zinc.....(Not Illustrated) ...	4	4	4
-	413008	-	Flat Washer -- 1/2" - Zinc.....(Not Illustrated) ...	4	4	4

WING

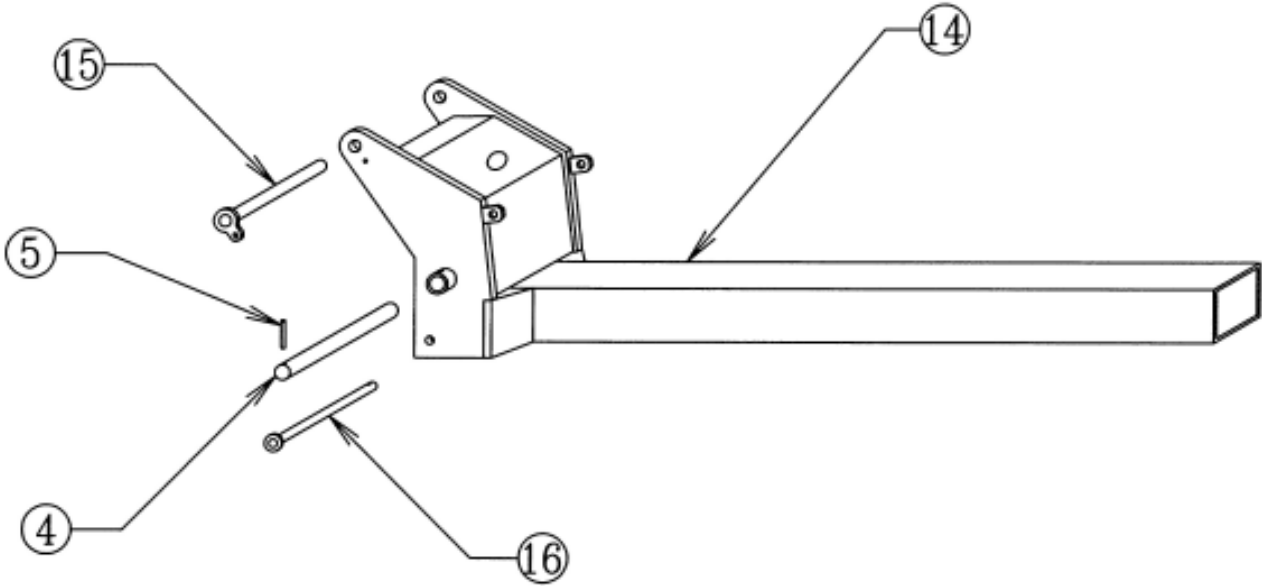

Item No.	Part No.	Wt. Lbs.	Description	Qty. Req'd		
				1270	1271	1274
4	203948	14¼	2" Pivot Pin x 16¼"	4	4	4
-	413124	-	Machine Washer -- 3" OD x 2" ID x 10 Ga.....(Not Illustrated) ...	8	8	8
5	416133	-	Roll Pin -- 1/2" x 3½" - Zinc	4	4	4
14	301816	460	Wing -- 38" Row Planter Bar	2	-	-
-	301822	475	Wing -- 30" & 40" Row Planter Bar.....(Not Illustrated) ...	-	2	2
15	301825	8	Top Pin -- Top Leveling Stacker	2	2	2
-	411545	-	Hex Bolt -- 1/2" x 1½" NC - Gr 5 - Zinc.....(Not Illustrated) ...	2	2	2
-	413508	-	Lock Washer -- 1/2" - Zinc.....(Not Illustrated) ...	2	2	2
-	413008	-	Flat Washer -- 1/2" - Zinc.....(Not Illustrated) ...	2	2	2
16	301826	3½	Wing Lock Pin -- Top Leveling Stacker	2	2	2
-	416204	-	Klik Pin -- 1/4" - Zinc.....(Not Illustrated) ...	2	2	2

USE ONLY



W & A REPLACEMENT PARTS

HITCH ASSEMBLY

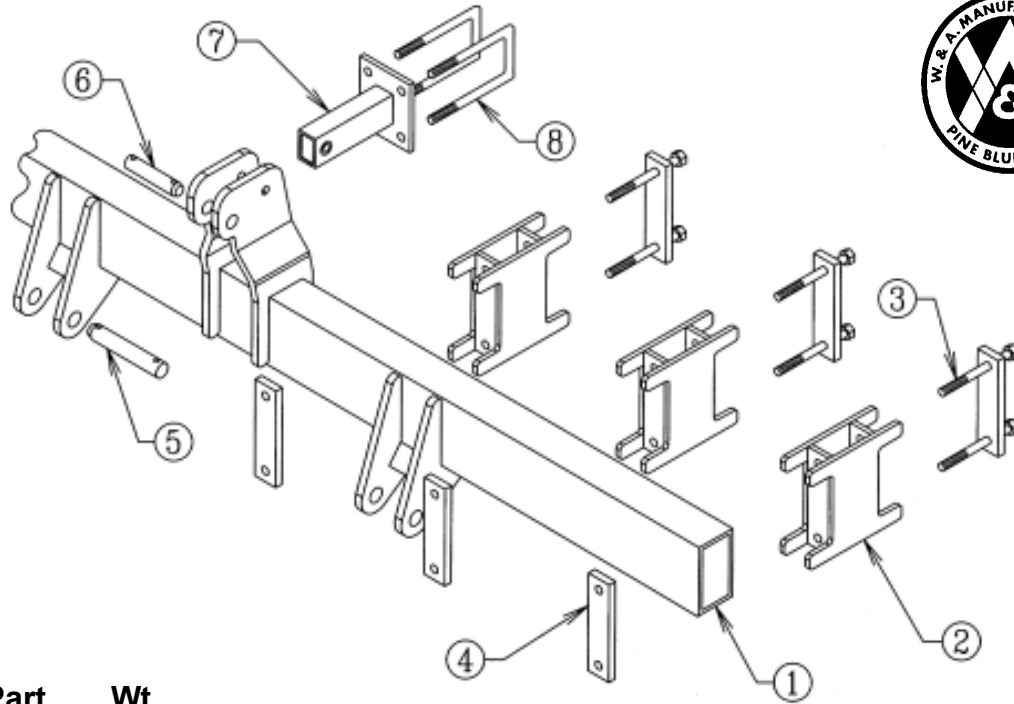

Item No.	Part No.	Wt. Lbs.	Description	Qty. Req'd	
				1270	1271
1	301833	361	Wide Hitch -- Top Leveling Stacker	1	1
2	302014	25	5" Spacer Block -- Top Leveling Stacker	6	6
3	203960	5	Backing Plate -- Top Leveling Stacker	6	6
-	411604	1¼	Hex Bolt -- 3/4" x 10" - Gr 5 - Zinc.....	12	12
-	412012	-	Hex Nut -- 3/4" - 10 - Gr 2 - Zinc.....(Not Illustrated) ..	12	12
-	413512	-	Lock Washer -- 3/4" - Zinc.....(Not Illustrated) ...	12	12
4	203960	5	Backing Plate -- Top Leveling Stacker	6	6
-	411598	½	Hex Bolt -- 3/4" x 6½" NC - Gr 5 - Zinc.....(Not Illustrated) ..	12	12
-	412012	-	Hex Nut -- 3/4" - 10 - Gr 2 - Zinc.....(Not Illustrated) ..	12	12
-	413512	-	Lock Washer -- 3/4" - Zinc.....(Not Illustrated) ...	12	12
5	200876	3¾	Hardened Pull Pin -- 1-7/16" x 8-3/8" - Zinc	2	2
-	416207	-	Klik Pin -- 7/16" - Zinc.....(Not Illustrated) ..	2	2
-	416133	-	Roll Pin -- 1/2" x 3½" - Zinc.....(Not Illustrated) ...	2	2
6	200853	2	Hardened Top Link Pin -- 1¼" x 5-15/16" - Zinc.....	1	1
-	416207	-	Klik Pin -- 7/16" - Zinc.....(Not Illustrated) ..	1	1
-	416120	-	Roll Pin -- 3/8" x 2" - Zinc.....(Not Illustrated) ..	1	1
7	301836	11	Top Connector -- 5" Spacer - Hitch Assm.....	1	1
-	411822	¾	Hex Bolt -- 3/4" x 5" NC - Gr 8 - Zinc.....(Not Illustrated) ...	1	1
-	412012	-	Hex Nut -- 3/4" - 10 - Gr 2 - Zinc.....(Not Illustrated) ..	1	1
-	413512	-	Lock Washer -- 3/4" - Zinc.....(Not Illustrated) ...	1	1
8	415006	2	3/4" Sq. U-Bolt x 4" x 8½" Leg - Gr 5 - Zinc	2	2
-	412012	-	Hex Nut -- 3/4" - 10 - Gr 2 - Zinc.....(Not Illustrated) ..	4	4
-	413512	-	Lock Washer -- 3/4" - Zinc.....(Not Illustrated) ...	4	4

HITCH ASSEMBLY

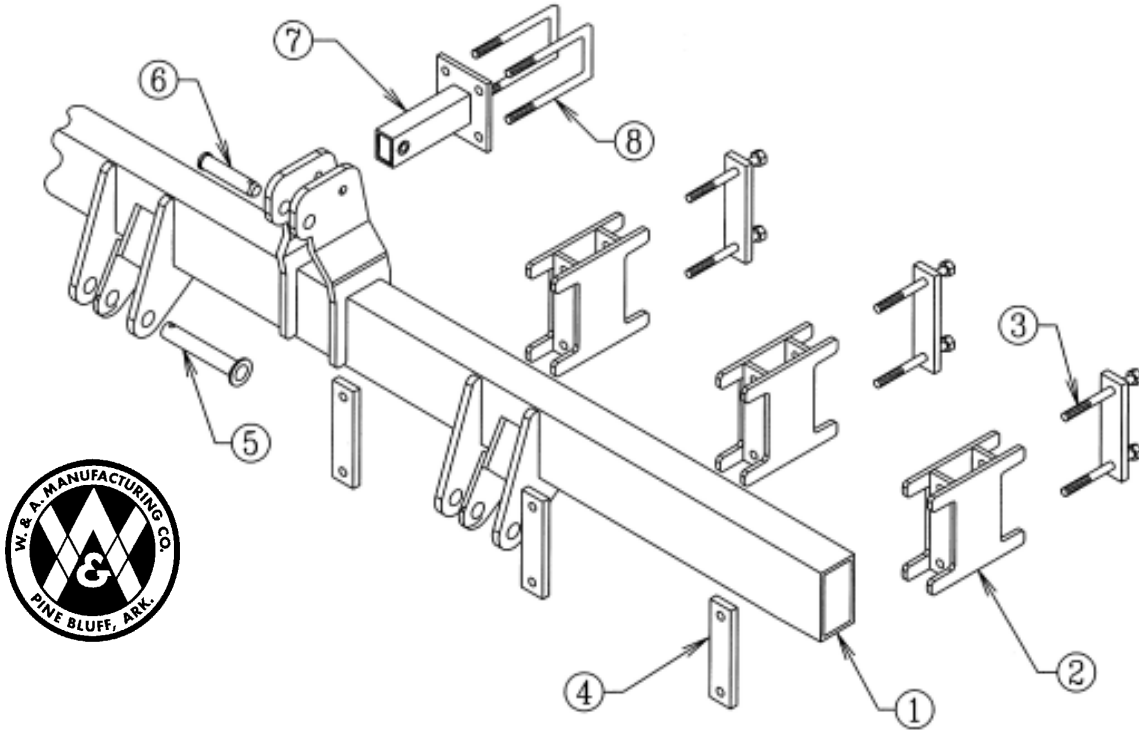

<u>Item No.</u>	<u>Part No.</u>	<u>Wt. Lbs.</u>	<u>Description</u>	<u>Qty. Req'd</u> <u>1274</u>
1	301832	369	Wide Stacker Hitch -- Cat. III & III Narrow.....(140")	1
2	302014	25	5" Spacer Block -- Top Leveling Stacker	6
3	203960	5	Backing Plate -- Top Leveling Stacker	6
-	411604	1¼	Hex Bolt -- 3/4" x 10" - Gr 5 - Zinc	12
-	412012	-	Hex Nut -- 3/4" - 10 - Gr 2 - Zinc.....(Not Illustrated) ..	12
-	413512	-	Lock Washer -- 3/4" - Zinc.....(Not Illustrated) ..	12
4	203960	5	Backing Plate -- Top Leveling Stacker	6
-	411598	½	Hex Bolt -- 3/4" x 6½" NC - Gr 5 - Zinc.....(Not Illustrated) ..	12
-	412012	-	Hex Nut -- 3/4" - 10 - Gr 2 - Zinc.....(Not Illustrated) ..	12
-	413512	-	Lock Washer -- 3/4" - Zinc.....(Not Illustrated) ..	12
5	300841	4	Pull Pin -- 1-7/16" x 9"	2
-	416207	-	Klik Pin -- 7/16" - Zinc.....(Not Illustrated) ..	2
6	416698	2	1¼" Top Link Pin - Zinc.....	1
-	416207	-	Klik Pin -- 7/16" - Zinc.....(Not Illustrated) ..	1
7	301836	11	Top Connector -- 5" Spacer - Hitch Assm	1
-	411822	¾	Hex Bolt -- 3/4" x 5" NC - Gr 8 - Zinc.....(Not Illustrated) ..	1
-	412012	-	Hex Nut -- 3/4" - 10 - Gr 2 - Zinc.....(Not Illustrated) ..	1
-	413512	-	Lock Washer -- 3/4" - Zinc.....(Not Illustrated) ..	1
8	415006	2	3/4" Sq. U-Bolt x 4" x 8½" Leg - Gr 5 - Zinc	2
-	412012	-	Hex Nut -- 3/4" - 10 - Gr 2 - Zinc.....(Not Illustrated) ..	4
-	413512	-	Lock Washer -- 3/4" - Zinc.....(Not Illustrated) ..	4

TWELVE ROW TOP LEVELING STACKER TOOLBAR

Model No. 1270 & 1272

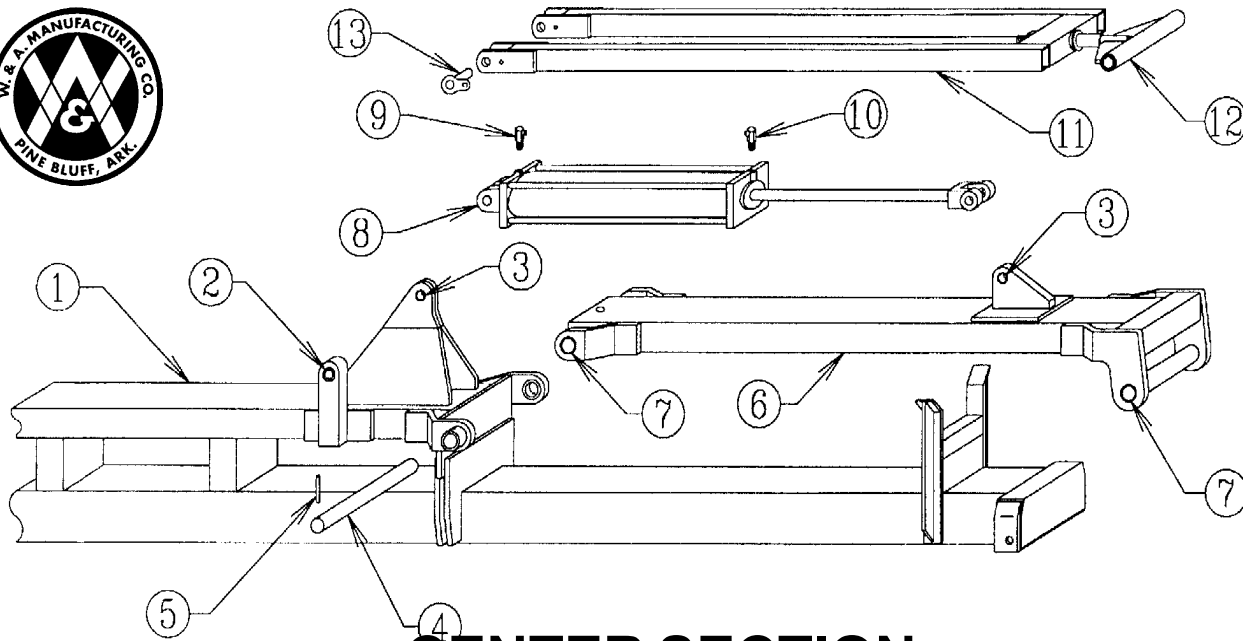

CENTER SECTION

Item No.	Part No.	Wt. Lbs.	Description	Qty. Req'd	
				Planter	Bedder
1	301814	1201	Center Section – Planter Bar @ 38" Rows	1	-
-	301810	1369	Center Section – Bedder Bar @ 38" Rows	-	1
2	401084	¼	Form 1 Bushing -- 1-1/2" OD x 1-1/4" ID x 1-1/2" Long ..	4	4
3	401080	¼	Form 1 Bushing -- 1-1/2" OD x 1-1/4" ID x 1" Long	4	4
4	203948	14¼	2" Pivot Pin x 16-1/4"	4	4
-	413124	-	Machine Washer -- 3" OD x 2" ID x 10 Ga	8	8
5	416133	-	Roll Pin -- 1/2" x 3-1/2" - Zinc	4	4
6	301802	265	Power Arm	2	2
7	401118	½	Bushing -- 2.376" OD x 2.006" ID x 2" Long	8	8
-	450004	-	1/4" Drive-in Grease Fitting	4	4
8	476029	126	Hydraulic Cylinder -- 5" x 30".....(w/Pins)	2	2
-	477056	-	Seal Kit -- 5" x 24" & 5" x 30" Lion Cyl (2" Rod)	-	-
9	446188	¼	1/2" x 1/2" Swivel Orifice Elbow	2	2
10	444024	¼	Swivel, ½" x ½"	2	2
-	785103	½	3/8" Hydraulic Hose x 103"	2	-
-	785120	½	3/8" Hydraulic Hose x 120"	2	2
-	785138	¾	3/8" Hydraulic Hose x 138"	-	2
11	301820	88	Leveling Arm (For 1½" Dia. Rod)	2	2
12	301819	19¾	Leveling Arm End -- 1-1/2" Dia.Rod	2	2
-	410032	1	Lock Nut -- 1-1/2" NF Nylon Insert - Zinc	2	2
-	413024	¼	Flat Washer -- 1-1/2"	2	2
-	413120	-	Machine Washer -- 1-1/2" ID x 10 Ga	2	2
-	450004	-	1/4" Drive-in Grease Fitting	2	2
-	401095	-	Form 1 Bushing -- 1-7/8" OD x 1-1/2" ID x 1" Long	4	4
13	301824	1¾	Small Pin -- 1-1/4" x 2-1/2" Stacker Bar	4	4
-	411545	-	Hex Bolt -- 1/2" x 1-1/2" NC - Gr 5 - Zinc	4	4
-	413508	-	Lock Washer -- 1/2" - Zinc	4	4
-	413008	-	Flat Washer -- 1/2" - Zinc	4	4

WING

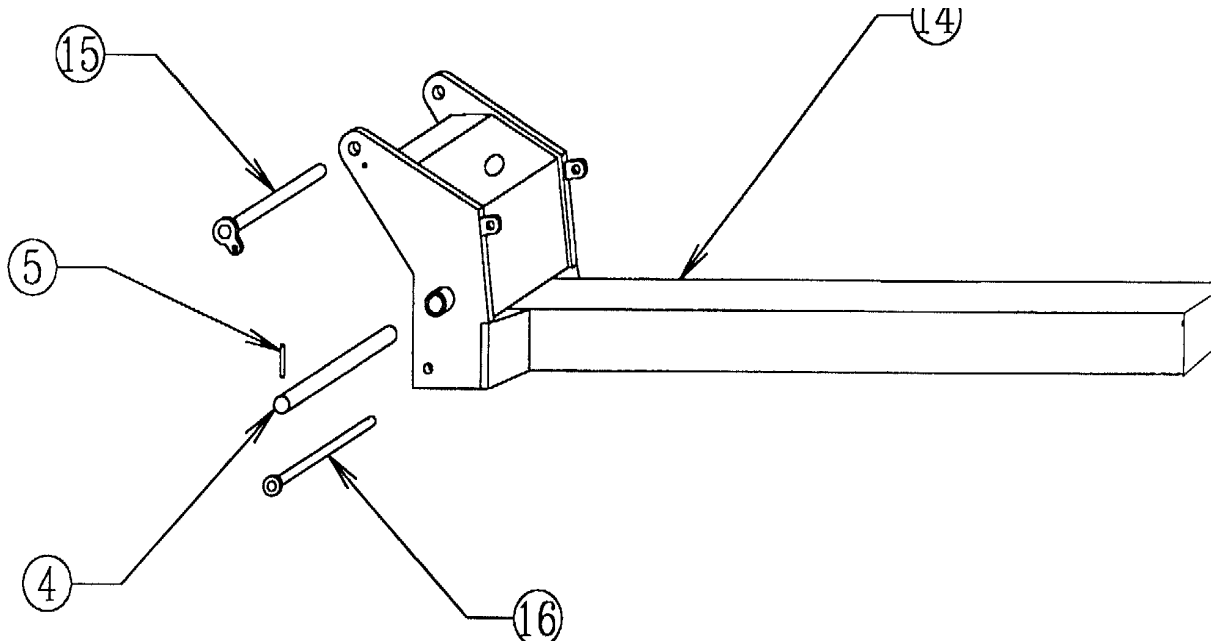

<u>Item No.</u>	<u>Part No.</u>	<u>Wt. Lbs.</u>	<u>Description</u>	<u>Qty. Req'd</u>	<u>Planter</u>	<u>Bedder</u>
4	203948	14¼	2" Pivot Pin x 16-1/4"	4	4	
-	413124	-	Machine Washer -- 3" OD x 2" ID x 10 Ga	8	8	
5	416133	-	Roll Pin -- 1/2" x 3-1/2" - Zinc	4	4	
14	301816	460	Wing for 38" & 40" Row Planter Bar	2	0	
-	301817	460	Wing for 38" & 40" Row Bedder Bar	0	2	
15	301825	8	Top Pin -- Top Leveling Stacker	2	2	
-	411545	-	Hex Bolt -- 1/2" x 1-1/2" NC - Gr 5 - Zinc	2	2	
-	413508	-	Lock Washer -- 1/2" - Zinc	2	2	
-	413008	-	Flat Washer -- 1/2" - Zinc	2	2	
16	301826	3½	Wing Lock Pin -- Top Leveling Stacker ..(Planter Bar Only) ..	2	0	
-	416204	-	1/4" Klik Pin - Zinc	2	0	



HITCH ASSEMBLY

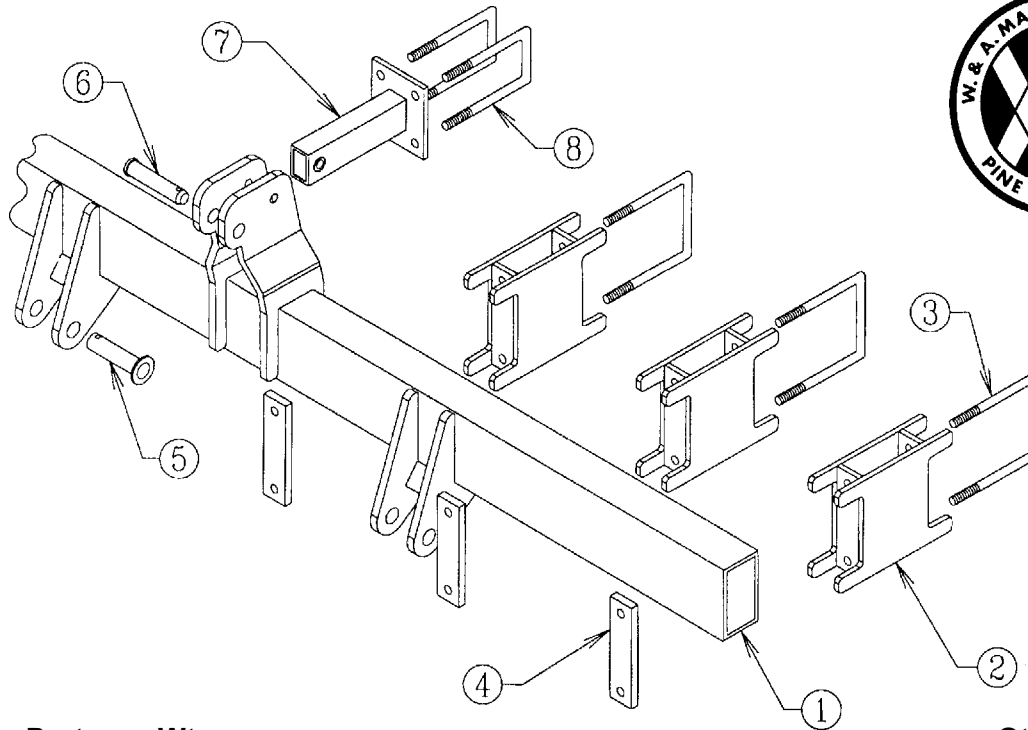

<u>Item No.</u>	<u>Part No.</u>	<u>Wt. Lbs.</u>	<u>Description</u>	<u>Qty. Req'd</u>	
				<u>Planter</u>	<u>Bedder</u>
1	301833	361	Wide Hitch -- Top Leveling Stacker	1	1
-	301835	411	Wide Hitch -- Cultivator	-	1
2	301831	32¼	7-1/2" Spacer Block -- Top Leveling Stacker	-	6
-	302014	25	5" Spacer Block -- Top Leveling Stacker	6	-
3	415004	2½	¾" Sq. U-Bolt x 7" x 9" Leg	-	6
-	203960	5	Backing Plate -- Top Leveling Stacker....(Not Illustrated)	6	-
-	411601		Hex Bolt -- ¾" x 10" - Gr 5 - Zinc.....(Not Illustrated)	12	-
-	412012	-	Hex Nut -- ¾" - 10 - Gr 2 - Zinc.....(Not Illustrated)	12	12
-	413512	-	Lock Washer -- ¾" - Zinc.....(Not Illustrated)	12	12
4	203960	5	Backing Plate -- Top Leveling Stacker	6	6
-	411598	½	Hex Bolt -- ¾" x 6-1/2" NC - Gr 5 - Zinc	12	12
-	412012	-	Hex Nut -- ¾" - 10 - Gr 2 - Zinc	12	12
-	413512	-	Lock Washer -- ¾" - Zinc	12	12
5	300837	3	Pull Pin -- 1-7/16" x 6"	2	2
-	416207	-	7/16" Klik Pin - Zinc	2	2
6	416698	2	1-1/4" Top Link Pin - Zinc	1	1
-	416207	-	7/16" Klik Pin - Zinc	1	1
7	301834	12¾	Top Connector -- 7-1/2" Spacer Blocks	-	1
-	301836	11	Top Connector -- 5" Spacer Blocks	1	-
-	411594	¾	Hex Bolt -- ¾" x 5" NC - Gr 5 - Zinc	1	1
-	412012	-	Hex Nut -- ¾" - 10 - Gr 2 - Zinc	1	1
-	413512	-	Lock Washer -- ¾" - Zinc	1	1
8	415006	2	¾" Sq. U-Bolt x 4" x 8½" Leg	2	2
-	412012	-	Hex Nut -- ¾" - 10 - Gr 2 - Zinc	4	4
-	413512	-	Lock Washer -- ¾" - Zinc	4	4

STACKER TOOLBAR TOP LEVELING MODEL

Model No. 1272 -- 12 @ 38" Row - Bedder
Model No. 1273 -- 12 @ 38" Row - Cultivator
Model No. 1275 -- 12 @ 40" Row - Bedder

CENTER SECTION

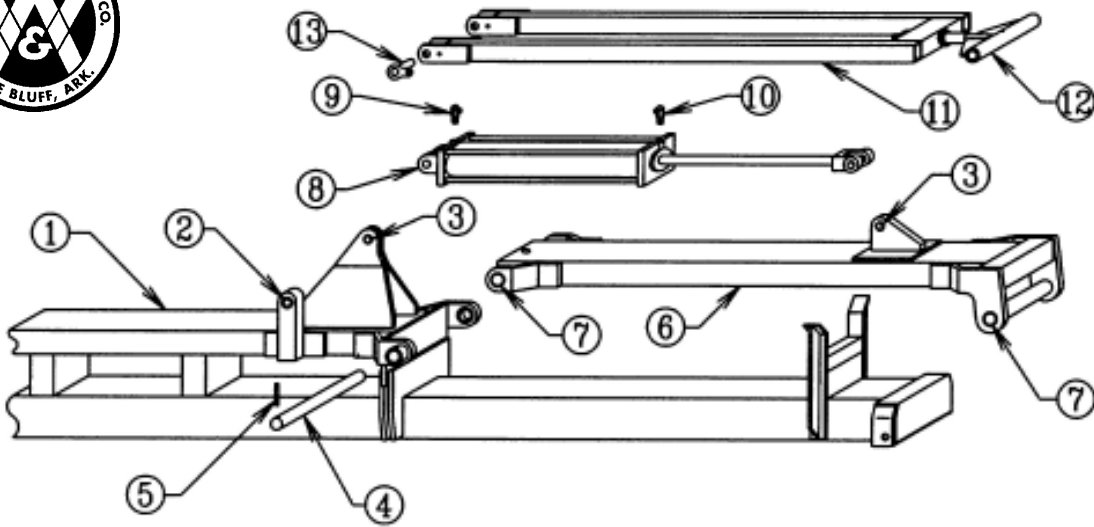

Item No.	Part No.	Wt. Lbs.	Description	Qty. Req'd		
				1272	1273	1275
1	301810	1369	Center Section – 38” Row Bedder Bar	1	-	-
-	301837	1369	Center Section – 38” Row Cultivator Bar.....(Not Illustrated) ..	-	1	-
-	301818	1407	Center Section – 40” Row Bedder Bar.....(Not Illustrated) ..	-	-	1
2	401084	¼	Form 1 Bushing -- 1½” OD x 1¼” ID x 1½” Long	4	4	4
3	401080	¼	Form 1 Bushing -- 1½” OD x 1¼” ID x 1” Long	4	4	4
4	203948	14¼	2” Pivot Pin x 16¼”	4	4	4
-	413124	-	Machine Washer -- 3” OD x 2” ID x 10 Ga.....(Not Illustrated) ..	8	8	8
5	416133	-	Roll Pin -- 1/2” x 3½” - Zinc	4	4	4
6	301802	265	Power Arm -- Top Leveling Stacker	2	2	2
7	401118	½	Bushing -- 2.376” OD x 2.006” ID x 2” Long	8	8	8
-	450004	-	1/4” Drive-in Grease Fitting.....(Not Illustrated) ...	4	4	4
8	476029	126	Hydraulic Cylinder -- 5” x 30” (w/Pins)	2	2	2
-	477056	-	Seal Kit -- 5” x 24” & 5” x 30” Lion Cyl - 2” Rod..(Not Illustrated)	-	-	-
9	446188	¼	1/2” x 1/2” Swivel Orifice Elbow	2	2	2
10	446188	¼	1/2” x 1/2” Swivel Orifice Elbow	2	2	2
-	785120	½	3/8” Hydraulic Hose x 120”.....(Not Illustrated) ...	2	2	-
-	785138	¾	3/8” Hydraulic Hose x 138”.....(Not Illustrated) ...	2	2	-
-	785123		3/8” Hydraulic Hose x 123”.....(Not Illustrated) ...	-	-	2
-	785143		3/8” Hydraulic Hose x 143”.....(Not Illustrated) ...	-	-	2

CENTER SECTION (Continued)

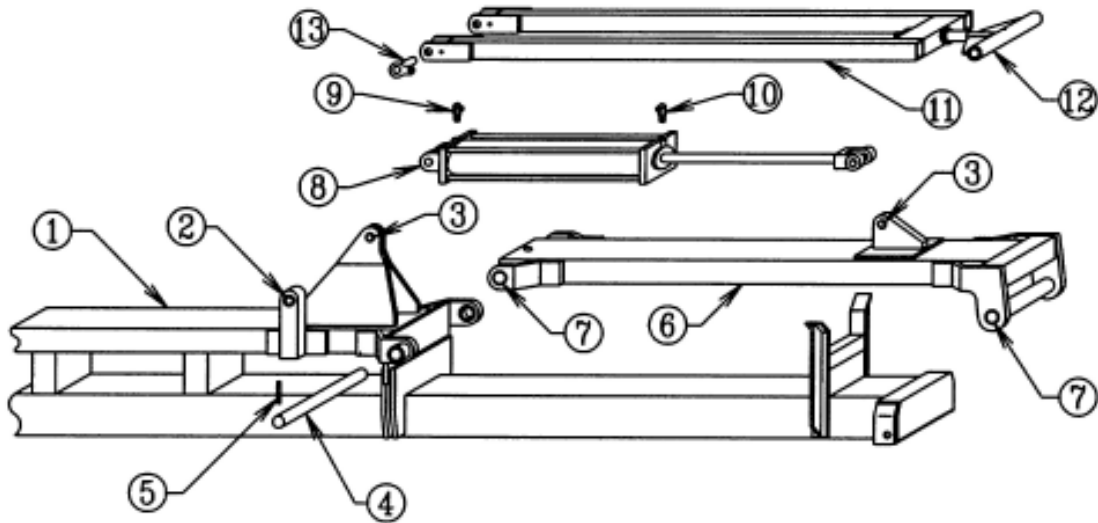

Item No.	Part No.	Wt. Lbs.	Description	Qty. Req'd		
				1272	1273	1275
11	301820	88	Leveling Arm -- For 1½" Dia. Rod	2	2	2
12	301819	19¾	Leveling Arm End with Lock Nut -- 1½" Dia. Rod	2	2	2
-	410032	1	Lock Nut -- 1½" NF Top Lock - Zinc.....(Not Illustrated) ...	2	2	2
-	413024	¼	Flat Washer -- 1½" - Zinc.....(Not Illustrated) ...	2	2	2
-	413120	-	Machine Washer -- 2¼" OD x 1½" ID x 10 Ga..(Not Illustrated) ...	2	2	2
-	450004	-	1/4" Drive-in Grease Fitting.....(Not Illustrated) ...	2	2	2
-	401095	-	Form 1 Bushing.....1-7/8" OD x 1½" ID x 1" Long.....(Not Illustrated) ...	4	4	4
13	301824	1¾	Small Pin -- 1¼" x 2½" Stacker Bar	4	4	4
-	411545	-	Hex Bolt -- 1/2" x 1½" NC - Gr 5 - Zinc.....(Not Illustrated) ...	4	4	4
-	413508	-	Lock Washer -- 1/2" - Zinc.....(Not Illustrated) ..	4	4	4
-	413008	-	Flat Washer -- 1/2" - Zinc.....(Not Illustrated) ...	4	4	4

USE ONLY



W & A REPLACEMENT PARTS

WING

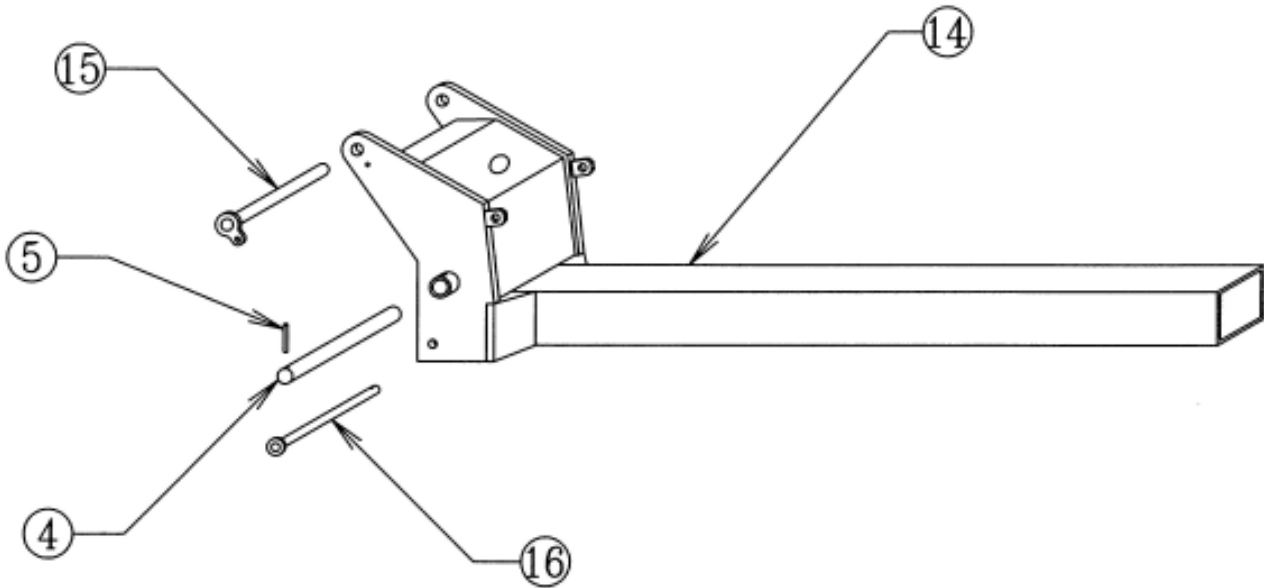

Item No.	Part No.	Wt. Lbs.	Description	Qty. Req'd		
				1272	1273	1275
4	203948	14¼	2" Pivot Pin x 16¼"	4	4	4
-	413124	-	Machine Washer -- 3" OD x 2" ID x 10 Ga.....(Not Illustrated) ..	8	8	8
5	416133	-	Roll Pin -- 1/2" x 3½" - Zinc	4	4	4
14	301817	460	Wing -- 38" & 40" Row Bedder & Cultivator	2	2	2
15	301825	8	Top Pin -- Top Leveling Stacker	2	2	2
-	411545	-	Hex Bolt -- 1/2" x 1½" NC - Gr 5 - Zinc.....(Not Illustrated) ...	2	2	2
-	413508	-	Lock Washer -- 1/2" - Zinc.....(Not Illustrated) ..	2	2	2
-	413008	-	Flat Washer -- 1/2" - Zinc.....(Not Illustrated) ...	2	2	2

USE ONLY



W & A REPLACEMENT PARTS



HITCH ASSEMBLY

No. 301835
for
Model 1273
Cultivator

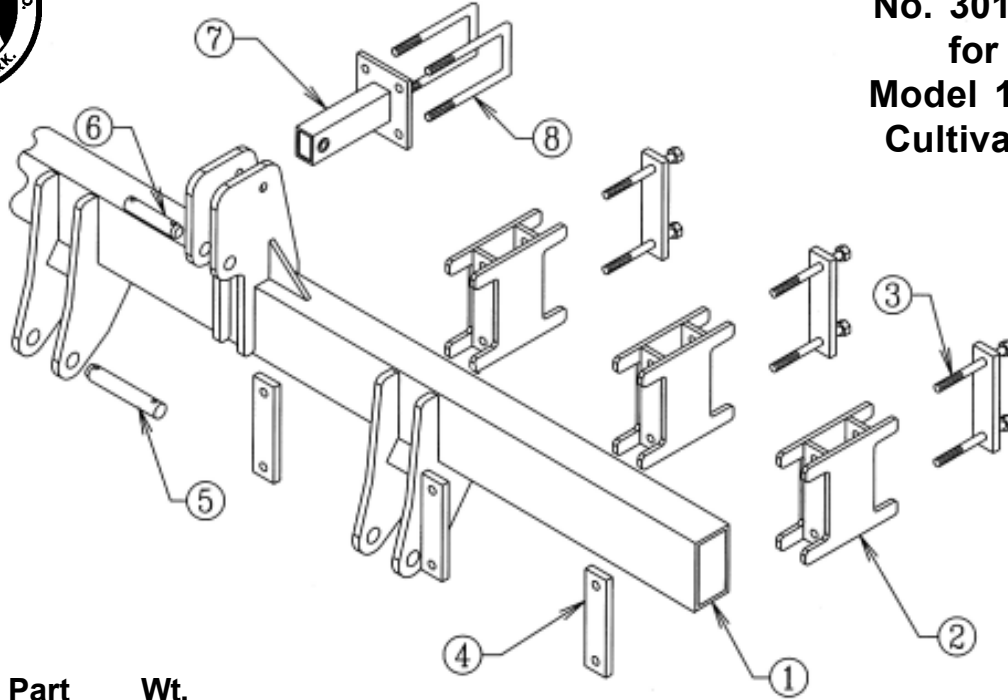

<u>Item No.</u>	<u>Part No.</u>	<u>Wt. Lbs.</u>	<u>Description</u>	<u>Qty. Req'd 1273</u>
1	301835	411	Wide Hitch -- Cultivator	1
2	302014	25	5" Spacer Block -- Top Leveling Stacker	6
3	203960	5	Backing Plate -- Top Leveling Stacker	6
-	411604		Hex Bolt -- 3/4" x 10" - Gr 5 - Zinc	12
-	412012	-	Hex Nut -- 3/4" - 10 - Gr 2 - Zinc.....(Not Illustrated) ..	12
-	413512	-	Lock Washer -- 3/4" - Zinc.....(Not Illustrated) ..	12
4	203960	5	Backing Plate -- Top Leveling Stacker	6
-	411598	1/2	Hex Bolt -- 3/4" x 6 1/2" NC - Gr 5 - Zinc.....(Not Illustrated) ..	12
-	412012	-	Hex Nut -- 3/4" - 10 - Gr 2 - Zinc.....(Not Illustrated) ..	12
-	413512	-	Lock Washer -- 3/4" - Zinc.....(Not Illustrated) ..	12
5	200876	3 3/4	Hardened Pull Pin -- 1-7/16" x 8-3/8" - Zinc	2
-	416207	-	Klik Pin -- 7/16" - Zinc.....(Not Illustrated) ..	2
-	416133	-	Roll Pin -- 1/2" x 3 1/2" - Zinc.....(Not Illustrated) ..	2
6	200853	2	Hardened Top Pin -- 1 1/4" x 5-15/16" - Zinc	1
-	416207	-	Klik Pin -- 7/16" - Zinc.....(Not Illustrated) ..	1
-	416120	-	Roll Pin -- 3/8" x 2" - Zinc.....(Not Illustrated) ..	1
7	301836	11	Top Connector -- 5" Spacer Block - Hitch Assm	1
-	411822	3/4	Hex Bolt -- 3/4" x 5" NC - Gr 8 - Zinc.....(Not Illustrated) ..	1
-	412012	-	Hex Nut -- 3/4" - 10 - Gr 2 - Zinc.....(Not Illustrated) ..	1
-	413512	-	Lock Washer -- 3/4" - Zinc.....(Not Illustrated) ..	1
8	415006	2	3/4" Sq. U-Bolt x 4" x 8 1/2" Leg - Gr. 5 - Zinc	2
-	412012	-	Hex Nut -- 3/4" - 10 - Gr 2 - Zinc.....(Not Illustrated) ..	4
-	413512	-	Lock Washer -- 3/4" - Zinc.....(Not Illustrated) ..	4

HITCH ASSEMBLY

**No. 301833
for
Model 1272 & 1275
Bedder**

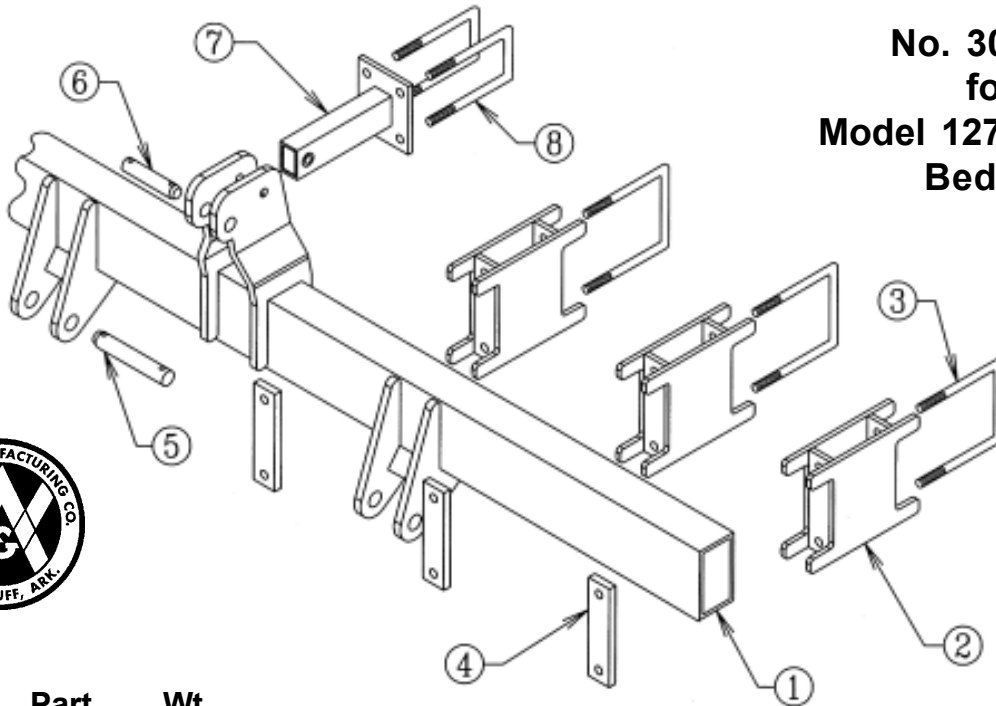

<u>Item No.</u>	<u>Part No.</u>	<u>Wt. Lbs.</u>	<u>Description</u>	<u>Qty. Req'd Bedder</u>
1	301833	361	Wide Hitch -- Top Leveling Stacker	1
2	301831	32¼	7½" Spacer Block -- Top Leveling Stacker	6
3	415004	2½	¾" Sq. U-Bolt x 7" x 9" Leg	6
-	412012	-	Hex Nut -- ¾" - 10 - Gr 2 - Zinc.....(Not Illustrated) ...	12
-	413512	-	Lock Washer -- ¾" - Zinc.....(Not Illustrated) ..	12
4	203960	5	Backing Plate -- Top Leveling Stacker	6
-	411598	½	Hex Bolt -- ¾" x 6½" NC - Gr 5 - Zinc.....(Not Illustrated) ...	12
-	412012	-	Hex Nut -- ¾" - 10 - Gr 2 - Zinc.....(Not Illustrated) ...	12
-	413512	-	Lock Washer -- ¾" - Zinc.....(Not Illustrated) ..	12
5	200876	3¾	Hardened Pull Pin -- 1-7/16" x 8-3/8" - Zinc	2
-	416207	-	Klik Pin -- 7/16" - Zinc.....(Not Illustrated) ...	2
-	416133	-	Roll Pin -- 1/2" x 3½" - Zinc.....(Not Illustrated) ..	2
6	200853	2	Hardened Top Link Pin -- 1¼" x 5-15/16" - Zinc	1
-	416207	-	Klik Pin -- 7/16" - Zinc.....(Not Illustrated) ...	1
-	416120	-	Roll Pin -- 3/8" x 2" - Zinc.....(Not Illustrated) ...	1
7	301834	12¾	Top Connector -- 7½" Spacer Block - Hitch Assm	1
-	411822	¾	Hex Bolt -- ¾" x 5" NC - Gr 8 - Zinc.....(Not Illustrated) ..	1
-	412012	-	Hex Nut -- ¾" - 10 - Gr 2 - Zinc.....(Not Illustrated) ...	1
-	413512	-	Lock Washer -- ¾" - Zinc.....(Not Illustrated) ..	1
8	415006	2	¾" Sq. U-Bolt x 4" x 8½" Leg - Gr. 5 - Zinc.....	2
-	412012	-	Hex Nut -- ¾" - 10 - Gr 2 - Zinc.....(Not Illustrated) ...	4
-	413512	-	Lock Washer -- ¾" - Zinc.....(Not Illustrated) ..	4

STACKER TOOLBAR TOP LEVELING MODEL

Model No. 1278 -- 16 @ 30" Row - Cultivator

CENTER SECTION

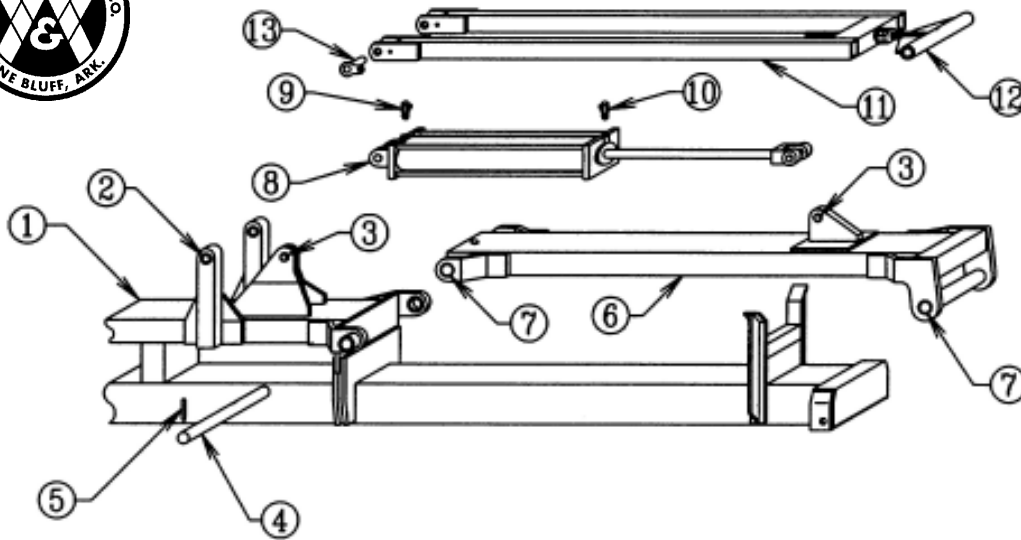

Item No.	Part No.	Wt. Lbs.	Description	Qty. Req'd
1	301838	1369	Center Section – 16 @ 30" Row Cultivator.....(258-7/8")	1
2	401084	¼	Form 1 Bushing -- 1½" OD x 1¼" ID x 1½" Long	4
3	401080	¼	Form 1 Bushing -- 1½" OD x 1¼" ID x 1" Long	4
4	203948	14¼	2" Pivot Pin x 16¼"	4
-	413124	-	Machine Washer -- 3" OD x 2" ID x 10 Ga.....(Not Illustrated) ..	8
5	416133	-	Roll Pin -- 1/2" x 3½" - Zinc.....	4
6	301802	206	Power Arm -- Top Leveling Stacker	2
7	401118	½	Bushing -- 2.376" OD x 2.006" ID x 2" Long	8
-	450004	-	1/4" Drive-in Grease Fitting.....(Not Illustrated) ..	4
8	476524	110	Hydraulic Cylinder -- 5" x 24" (w/1¼" Pin).....	2
-	477056	-	Seal Kit -- 5" x 24" & 5" x 30" Lion Cyl - 2" Rod.....(Not Illustrated) ..	-
9	446188	¼	1/2" x 1/2" Swivel Orifice Elbow	2
10	446188	¼	1/2" x 1/2" Swivel Orifice Elbow	2
-	785115	½	3/8" Hydraulic Hose x 115".....(Not Illustrated) ..	2
-	785126	½	3/8" Hydraulic Hose x 126".....(Not Illustrated) ..	2
11	301821	59	Leveling Arm -- For 1½" Dia. Rod - 16 @ 30" Cultivator	2
12	301819	19¾	Leveling Arm End with Lock Nut – 1½" Dia.Rod	2
-	410032	1	Lock Nut -- 1½" NF Top Lock - Zinc.....(Not Illustrated) ..	2
-	413024	¼	Flat Washer -- 1½" - Zinc.....(Not Illustrated) ..	2
-	413120	-	Machine Washer -- 2¼" OD x 1½" ID x 10 Ga.....(Not Illustrated) ..	2
-	450004	-	1/4" Drive-in Grease Fitting.....(Not Illustrated) ..	2
-	401095	-	Form 1 Bushing -- 1-7/8" OD x 1½" ID x 1"Long.....(Not Illustrated) ...	4
13	301824	1¾	Small Pin -- 1¼" x 2½" Stacker Bar	4
-	411545	-	Hex Bolt -- 1/2" x 1½" NC - Gr 5 - Zinc.....(Not Illustrated) ..	4
-	413508	-	Lock Washer -- 1/2" - Zinc.....(Not Illustrated) ...	4
-	413008	-	Flat Washer -- 1/2" - Zinc.....(Not Illustrated) ..	4

WING

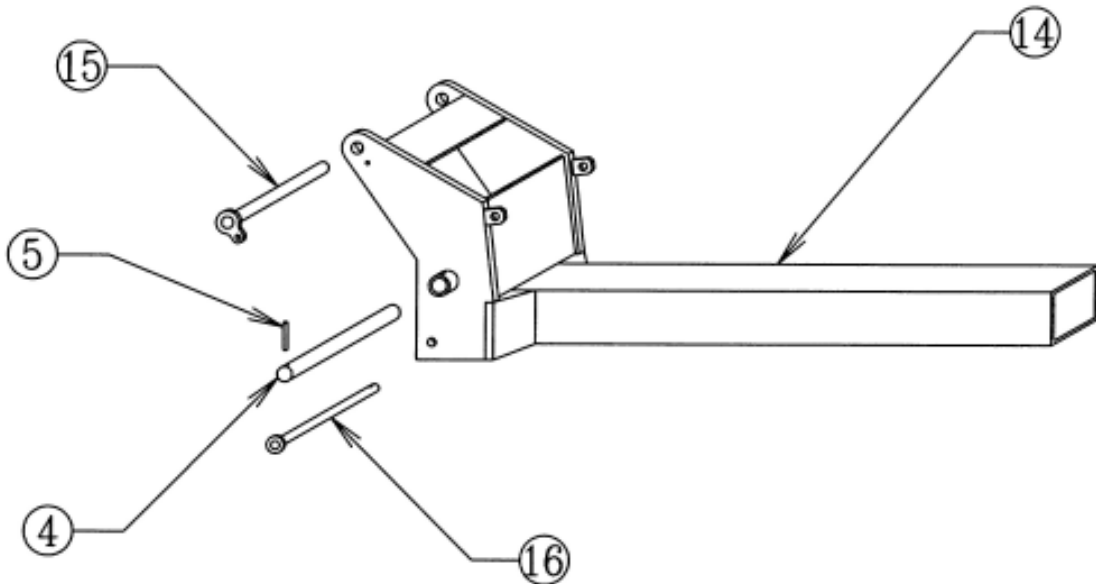

Item No.	Part No.	Wt. Lbs.	Description	Qty. Req'd
4	203948	14¼	2" Pivot Pin x 16¼"	4
-	413124	-	Machine Washer -- 3" OD x 2" ID x 10 Ga.....(Not Illustrated) ..	8
5	416133	-	Roll Pin -- 1/2" x 3½" - Zinc.....	4
14	301830	471	Wing -- 16 @ 30" Row Cultivator.....(108" Tube)	2
15	301825	8	Top Pin -- Top Leveling Stacker	2
-	411545	-	Hex Bolt -- 1/2" x 1½" NC - Gr 5 - Zinc.....(Not Illustrated) ..	2
-	413508	-	Lock Washer -- 1/2" - Zinc.....(Not Illustrated) ..	2
-	413008	-	Flat Washer -- 1/2" - Zinc.....(Not Illustrated) ..	2
16	301826	3½	Wing Lock Pin -- Top Leveling Stacker	2
-	416204	-	Klik Pin -- 1/4" - Zinc.....(Not Illustrated) ..	2

USE ONLY



W & A REPLACEMENT PARTS

HITCH ASSEMBLY

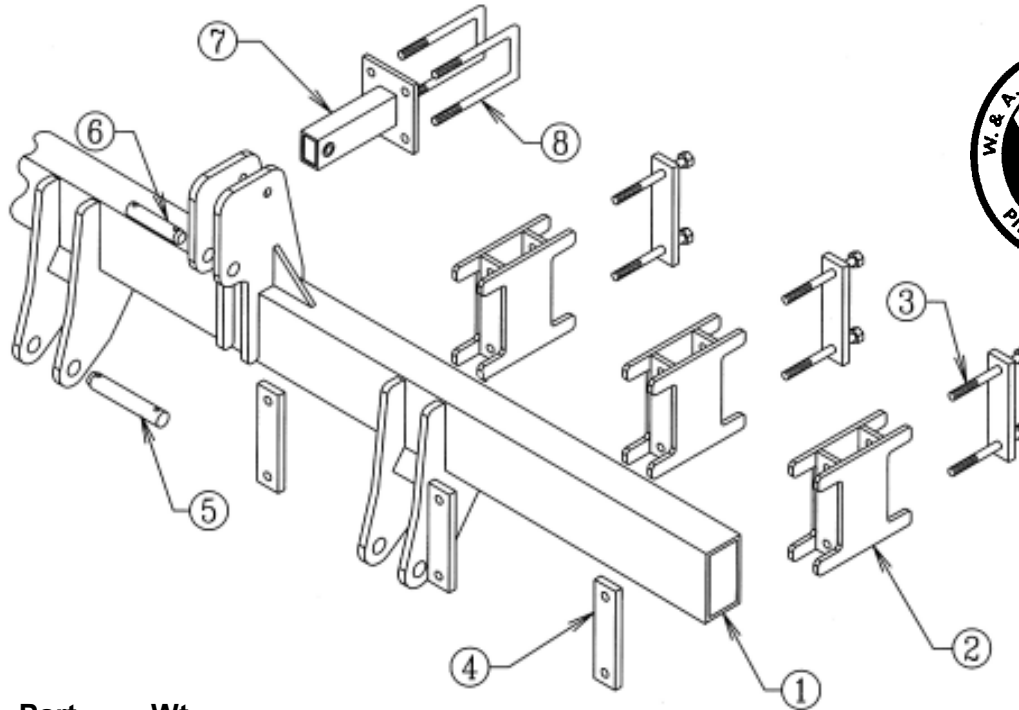

<u>Item No.</u>	<u>Part No.</u>	<u>Wt. Lbs.</u>	<u>Description</u>	<u>Qty. Req'd</u>
1	301839	536	Stacker Cultivator Hitch – 16 Row @ 30"(200")	1
2	302014	25	5" Spacer Block -- Top Leveling Stacker	8
3	203960	5	Backing Plate -- Top Leveling Stacker	8
-	411604	1¼	Hex Bolt -- 3/4" x 10" NC - Gr 5 - Zinc.....	16
-	412012	-	Hex Nut -- 3/4" - 10 - Gr 2 - Zinc.....(Not Illustrated) ..	16
-	413512	-	Lock Washer -- 3/4" - Zinc.....(Not Illustrated) ..	16
4	203960	5	Backing Plate -- Top Leveling Stacker	8
-	411598	½	Hex Bolt -- 3/4" x 6½" NC - Gr 5 - Zinc.....(Not Illustrated) ..	16
-	412012	-	Hex Nut -- 3/4" - 10 - Gr 2 - Zinc.....(Not Illustrated) ..	16
-	413512	-	Lock Washer -- 3/4" - Zinc.....(Not Illustrated) ..	16
5	200876	3¾	Hardened Pull Pin -- 1-7/16" x 8-3/8" - Zinc	2
-	416207	-	Klik Pin -- 7/16" - Zinc.....(Not Illustrated) ..	2
-	416133	-	Roll Pin -- 1/2" x 3½" - Zinc.....(Not Illustrated) ..	2
6	200853	2	Hardened Top Link Pin -- 1¼" x 5-15/16" - Zinc	1
-	416207	-	Klik Pin -- 7/16" - Zinc.....(Not Illustrated) ..	1
-	416120	-	Roll Pin -- 3/8" x 2" - Zinc.....(Not Illustrated) ..	1
7	301836	11	Top Connector -- 5" Spacer - Hitch Assm	1
-	411822	¾	Hex Bolt -- 3/4" x 5" NC - Gr 8 - Zinc.....(Not Illustrated) ..	1
-	412012	-	Hex Nut -- 3/4" - 10 - Gr 2 - Zinc.....(Not Illustrated) ..	1
-	413512	-	Lock Washer -- 3/4" - Zinc.....(Not Illustrated) ..	1
8	415006	2	3/4" Sq. U-Bolt x 4" x 8½" Leg - Gr 5 - Zinc	2
-	412012	-	Hex Nut -- 3/4" - 10 - Gr 2 - Zinc.....(Not Illustrated) ..	4
-	413512	-	Lock Washer -- 3/4" - Zinc.....(Not Illustrated) ..	4